

Operator Humble Oil & Refining Co.			Lease New Mexico "CP" State			Well No. 1		
Unit Letter A	Section 33	Township 10 South	Range 33 East	County Lea	167			
Actual Footage Location of Well: 660 feet from the North line and 660 feet from the East line								
Ground Level Elev. Later		Producing Formation Pennsylvania (Brugh "C")			Pool E N B E		Dedicated Acreage: 80 Acres	

1. Outline the acreage dedicated to the subject well by colored pencil or hatchure marks on the plat below.
2. If more than one lease is dedicated to the well, outline each and identify the ownership thereof (both as to working interest and royalty).
3. If more than one lease of different ownership is dedicated to the well, have the interests of all owners been consolidated by communitization, unitization, force-pooling, etc?

☐ Yes ☐ No If answer is "yes," type of consolidation _____

If answer is "no," list the owners and tract descriptions which have actually been consolidated. (Use reverse side of this form if necessary.) _____

No allowable will be assigned to the well until all interests have been consolidated (by communitization, unitization, forced-pooling, or otherwise) or until a non-standard unit, eliminating such interests, has been approved by the Commission.

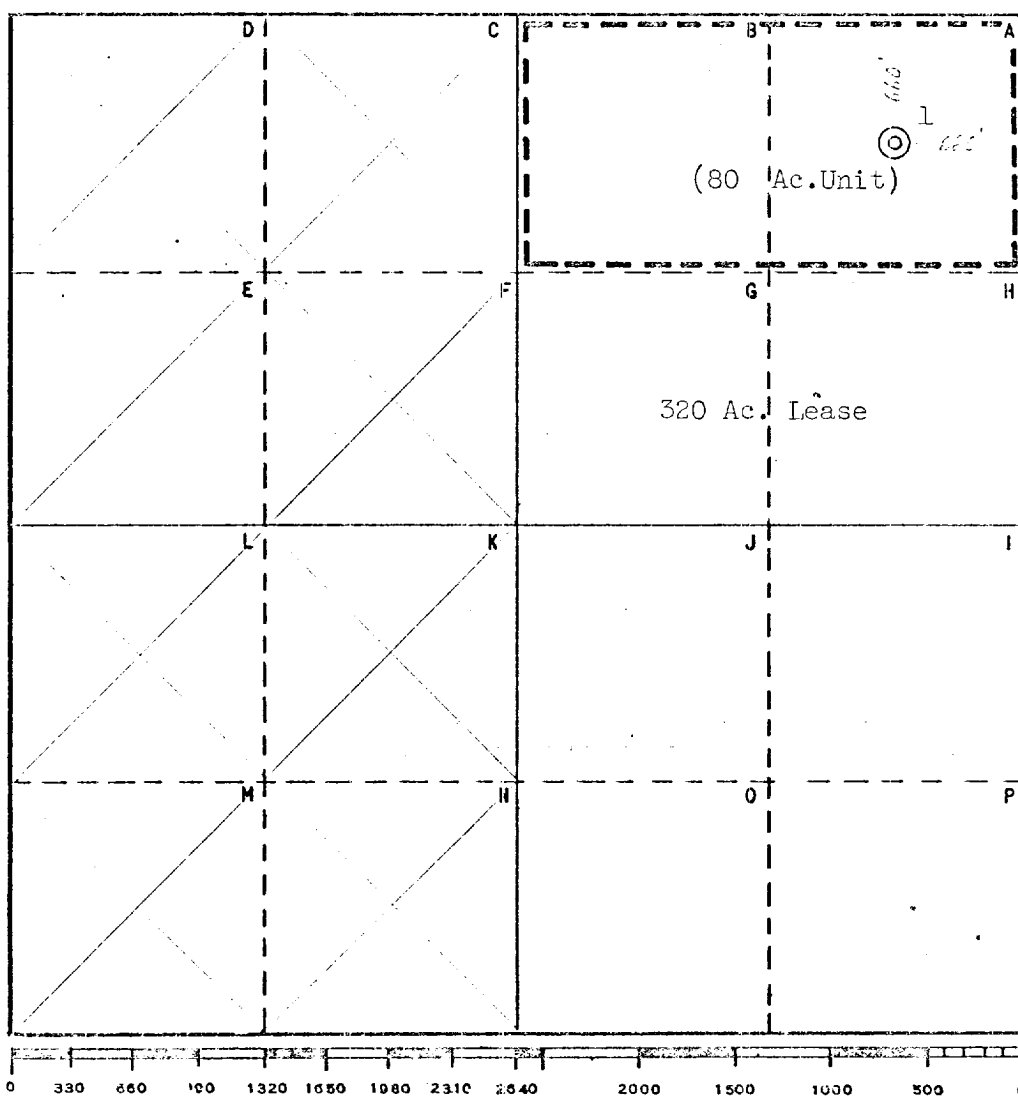

CERTIFICATION

I hereby certify that the information contained herein is true and complete to the best of my knowledge and belief.

Name: *J. P. McKertson*
Position: *Pres. Supervisor*
Company: Humble Oil & Refining Co.
Box 1600 Midland, Texas
Date: *5-15-67*

I hereby certify that the well location shown on this plat was plotted from field notes of actual surveys made by me or under my supervision, and that the same is true and correct to the best of my knowledge and belief.

Date Surveyed: May 13, 1967

Registered Professional Engineer and/or Land Surveyor

R. A. Carter

Certificate No.

554