

NEW MEXICO OIL AND GAS COMMISSION
WELL LOCATION AND ACREAGE DEDICATION PLAT

Form No. 1
Supersedes 1-128
Effective 1-1

All distances must be from the center boundaries of the Section

Operator STOLTZ AND COMPANY- CLARK				State XXXXXXX-Shell-STATE XXXXXXXXX		Well No. 1
Section H	Range 17	Township 11 South	Block 33 East	County Lea		
Actual Well Location of Well:						
Year 1980		Feet from the North		Feet from the East		Line
Actual Depth 4291		Feet from the Lower Penn		Feet from the North Bagley		Dedicated Acreage: 80 Acres

1. Outline the acreage dedicated to the subject well by colored pencil or hatchure marks on the plat below
2. If more than one lease is dedicated to the well outline each and identify the ownership thereof (both as to working interest and royalty)
3. If more than one lease of different ownership is dedicated to the well have the interests of all owners been consolidated by communitization, unitization, forced pooling, etc?

☒ Yes ☐ No If answer is "Yes" type of consolidation **Communitization**

If answer is "Yes" list the owners and their respective interests which have actually been consolidated (Use reverse side of this form if necessary)

Consolidable will be assigned to the well and all interests have been consolidated (by communitization, unitization, forced pooling, or otherwise) or until a non standard unit, terminating such interests, has been approved by the Commission.

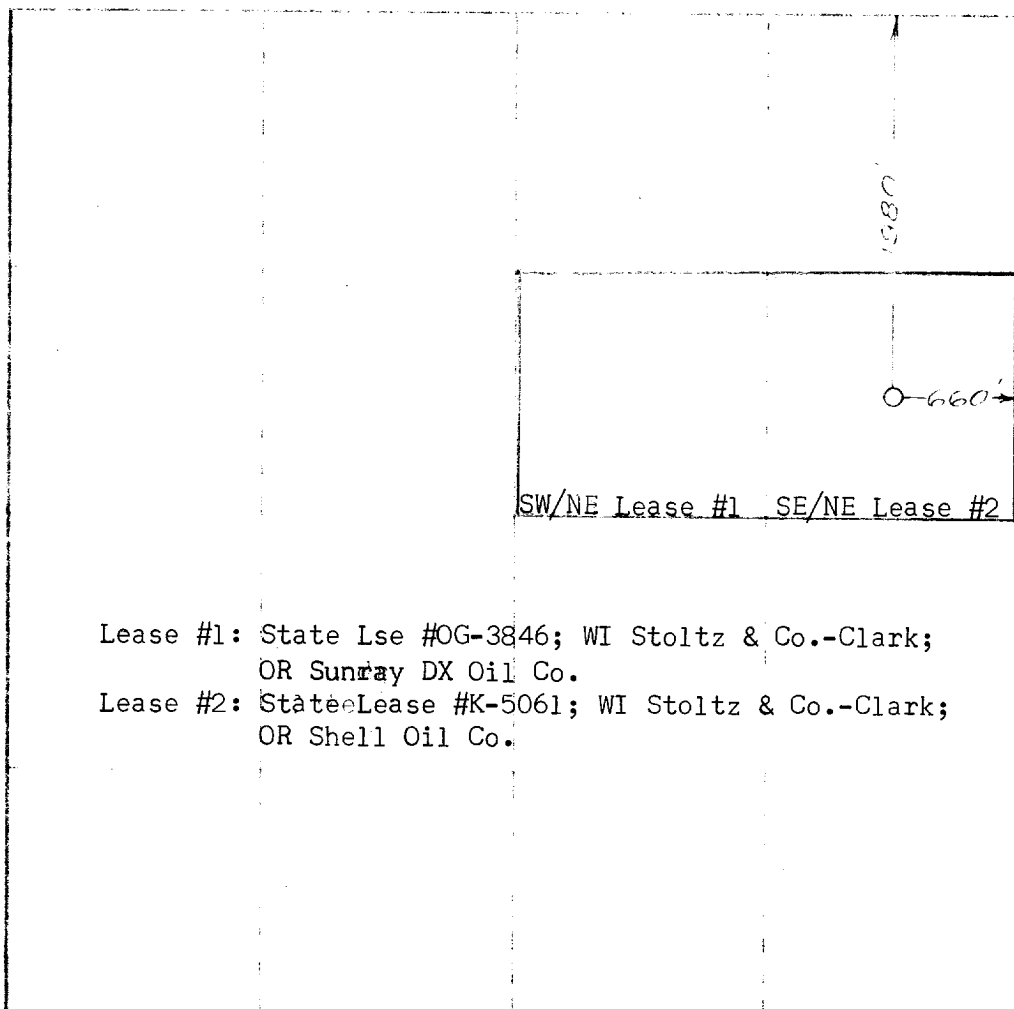

Lease #1: State Lse #OG-3846; WI Stoltz & Co.-Clark;
OR Sunray DX Oil Co.
Lease #2: State Lease #K-5061; WI Stoltz & Co.-Clark;
OR Shell Oil Co.

CERTIFICATION

I hereby certify that the information contained herein is true and complete to the best of my knowledge and belief

Donna Rolles
Operator

Agent

Stoltz & Co.-Clark

August 21, 1967

I hereby certify that the well location shown on this plat was plotted from field notes of actual surveys made by me or under my supervision, and that the same is true and correct to the best of my knowledge and belief

Well Surveyed

August 19, 1967

Registered Professional Engineer
and/or Land Surveyor

John W. Dhearn
Certificate No.

1559

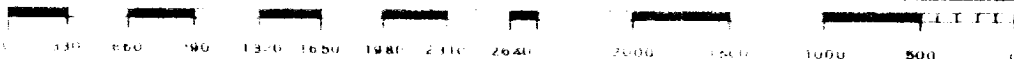

NEW MEXICO OIL CONSERVATION COMMISSION
WELL LOCATION AND ACREAGE DEDICATION PLAT

Form C-102
 Supersedes C-128
 Effective 1-1-65

All distances must be from the outer boundaries of the Section

Operator STOLTZ AND COMPANY- CLARK			Lease XXXXXX Shell-STATE XXXXXX		Well No. 1
Unit Letter H	Section 17	Township 11 South	Range 33 East	County Lea	
Actual Footage Location of Well: 1980 feet from the North line and 660 feet from the East line					
Ground Level Elev. 4291	Producing Formation Lower Penn		Pool North Bagley		Dedicated Acreage: 80 Acres

1. Outline the acreage dedicated to the subject well by colored pencil or hachure marks on the plat below.
2. If more than one lease is dedicated to the well, outline each and identify the ownership thereof (both as to working interest and royalty).
3. If more than one lease of different ownership is dedicated to the well, have the interests of all owners been consolidated by communitization, unitization, force pooling, etc?

☒ Yes ☐ No If answer is "yes," type of consolidation Communitization

If answer is "no," list the owners and tract descriptions which have actually been consolidated. (Use reverse side of this form if necessary) _____

No allowable will be assigned to the well until all interests have been consolidated (by communitization, unitization, forced-pooling, or otherwise) or until a non-standard unit, eliminating such interests, has been approved by the Commission.

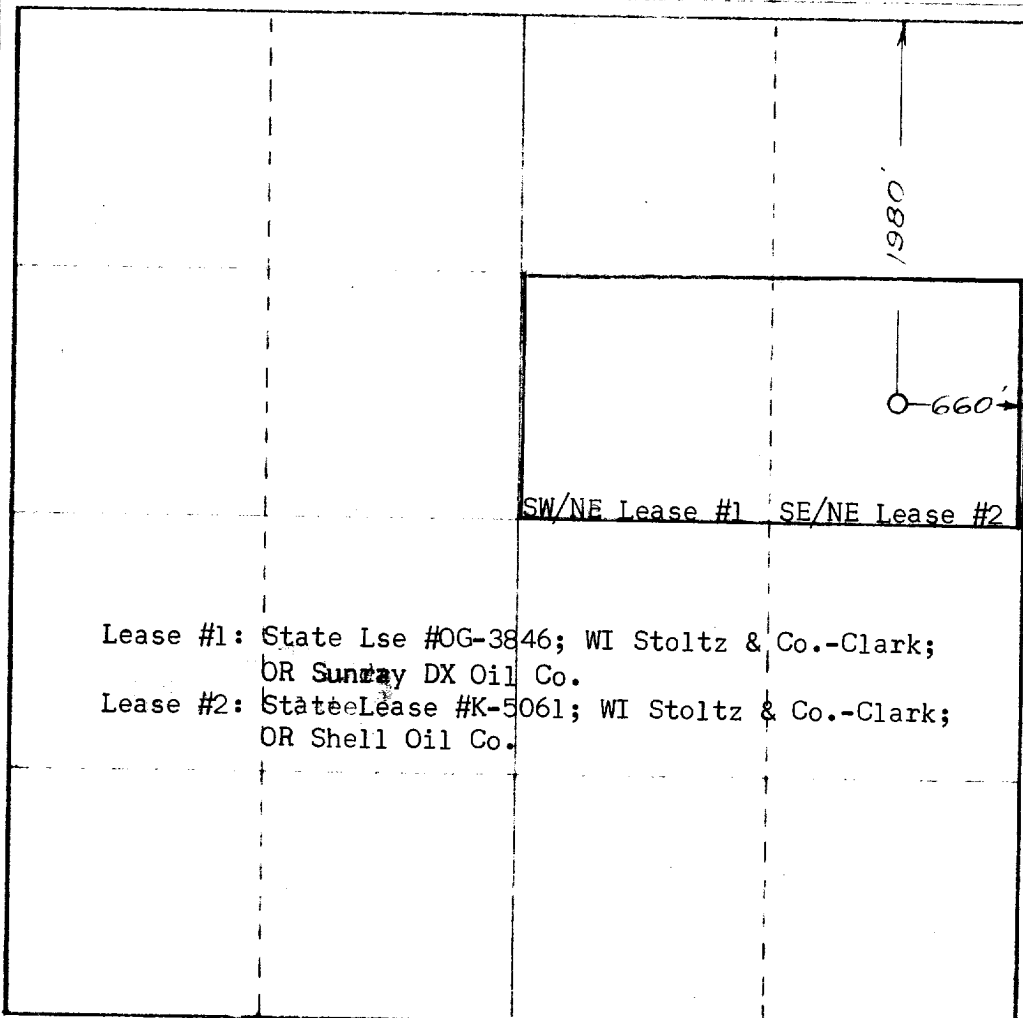

CERTIFICATION

I hereby certify that the information contained herein is true and complete to the best of my knowledge and belief.

Name: Donna Rolles
 Position: Agent

Company: Stoltz & Co.-Clark

Date: August 21, 1967

I hereby certify that the well location shown on this plat was plotted from field notes of actual surveys made by me or under my supervision, and that the same is true and correct to the best of my knowledge and belief.

Date Surveyed: August 19, 1967

Registered Professional Engineer and/or Land Surveyor

John W. Dhearn

Certificate No.

1559

