

| | | | | | |
|-----------------------------|-------------------|---------------------|-------|---------------|-------|
| COUNTY | LEA | FIELD | Lane | STATE | NM |
| OPR | ETA OIL PRODUCERS | | | | MAP |
| 4 Lane "C" 674 Ltd. | | | | | |
| Sec. 6, T-10-S, R-34-E | | | | CO-ORD | |
| 660' FNL, 1980' FWL of Sec. | | | | 30-025-22309 | |
| Spd 11-8-67 | | CLASS | | EL [REDACTED] | |
| Cmp 12-18-67 | | FORMATION | DATUM | FORMATION | DATUM |
| CSG & SX - TUBING | | | | | |
| 13 3/8" | 389' | 375 | | | |
| 8 5/8" | 3990' | 400 | | | |
| 4 1/2" | 9785' | 350 | | | |
| LOGS EL GR RA IND HC A | | | | | |
| | | TD 9785', PED 9784' | | | |

IP Bough "C" Perfs 9765-75' Empd 282 BOPD + 460 BW. Pot. Based on 24 hr test, GOR 680, Gravity 45.2.

Distribution limited and publication prohibited by subscribers' agreement.
Reproduction rights reserved by Williams & Lee Scouting Service, Inc.

CONT. Marcum Drlg. Co. PROP DEPTH 9900' TYPE
DATE

F.R. 11-9-67; Elev. 4262' GL
PD 9900' - Penn.
Contr. - Marcum Drlg. Co.
11-14-67 TD 3990', prep run 8 5/8" casing.
11-20-67 Drlg. 6315'.
11-28-67 Drlg. 8590'.
12-4-67 Drlg. 9339'.
12-11-67 TD 9785', WOC.
DST 9725-85', open 1 hr,
GTS 5 mins, MIS 30 mins, OES 45 mins,
Flwd 21 BO in 15 mins on 1" chk., SEP 200#,
Rev out full string of oil & wtr,
2 hr ISIP 2947#, FP 1272-1717#,
2 hr FSIP 2862#.

12-18-67 TD 9785', PBD 9784', WO Pumping Equipment
Perf 9765-75' W/2 SPF
Acid (9765-75') 500 gals.
1-3-68 TD 9785', PBD 9784', RU Pump
1-8-68 TD 9785', PBD 9784', COMPLETE
LOG: Anhy 2120', Yates 2706', SA 4064',
Glorieta 5384', Tubb 6856', Abo 7684',
Bough "C" 9760'.

NEW MEXICO OIL CONSERVATION COMMISSION
WELL LOCATION AND ACREAGE DEDICATION PLAT

Form C-102
Supersedes C-128
Effective 1-1-65

All distances must be from the outer boundaries of the Section.

| | | | | | |
|---|---|-----------------------------|----------------------------------|--|----------------------|
| Operator B T A OIL PRODUCERS | | | Lease LANE "C" 674 LTD | | Well No. 4 |
| Unit Letter C | Section 6 | Township 10-S | Range 34-E | County LEA | |
| Actual Footage Location of Well: 660 feet from the NORTH line and 1980 feet from the WEST line | | | | | |
| Ground Level Elev: 4262 | Producing Formation PENNSYLVANIAN | Pool UNDESIGNATED | | Dedicated Acreage: 160 Acres | |

1. Outline the acreage dedicated to the subject well by colored pencil or hachure marks on the plat below.
2. If more than one lease is dedicated to the well, outline each and identify the ownership thereof (both as to working interest and royalty).
3. If more than one lease of different ownership is dedicated to the well, have the interests of all owners been consolidated by communitization, unitization, force-pooling, etc?

☐ Yes ☐ No If answer is "yes," type of consolidation _____

If answer is "no," list the owners and tract descriptions which have actually been consolidated. (Use reverse side of this form if necessary.) _____

No allowable will be assigned to the well until all interests have been consolidated (by communitization, unitization, forced-pooling, or otherwise) or until a non-standard unit, eliminating such interests, has been approved by the Commission.

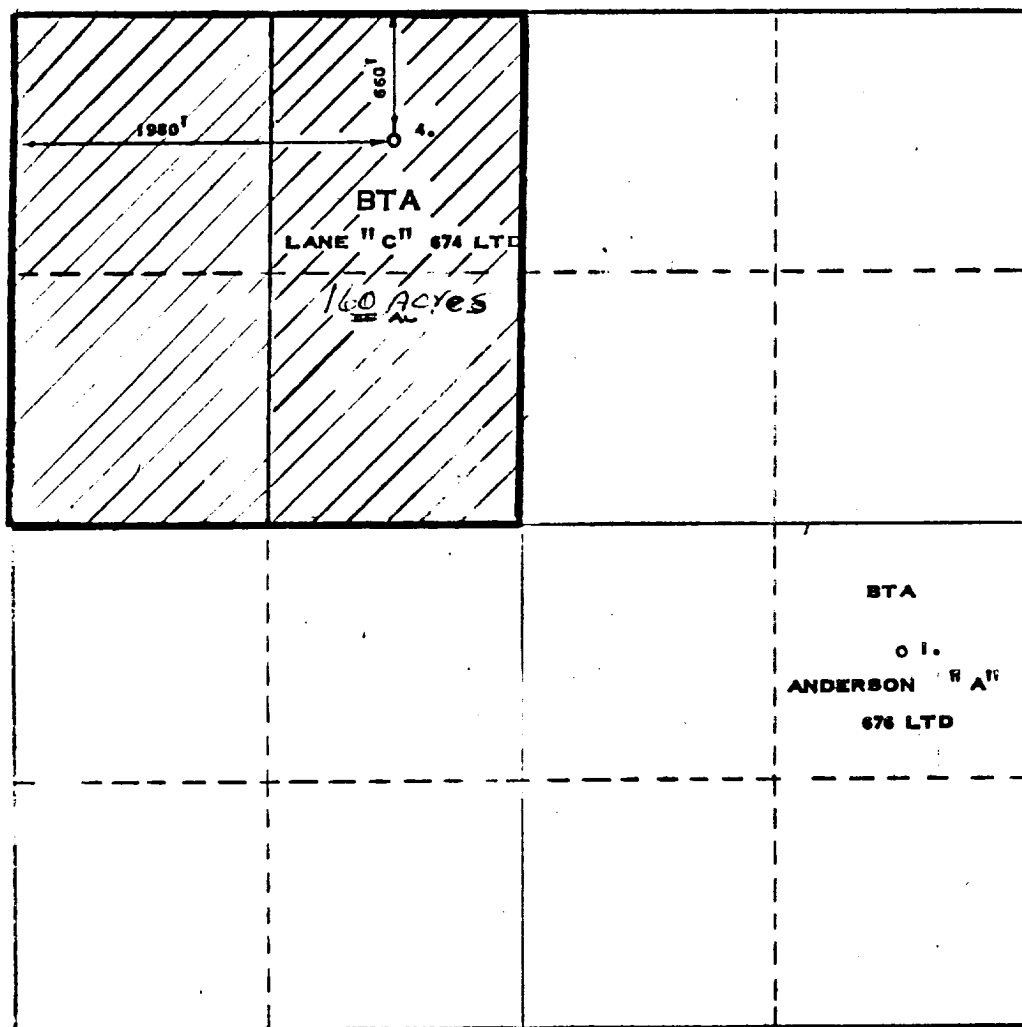

CERTIFICATION

I hereby certify that the information contained herein is true and complete to the best of my knowledge and belief.

Name _____

Position _____

Engineer

Company _____

BTA Oil Producers

Date _____

June 10, 1968

I hereby certify that the well location shown on this plat was plotted from field notes of actual survey made by me or under my supervision, and that the same is true and correct to the best of my knowledge and belief.

Date Surveyed _____

OCTOBER 21, 1967

Registered Professional Engineer and/or Land Surveyor

Max A. Schumann Jr.
MAX A. SCHUMANN JR.

Certificate No. _____

1510