

NO. OF COPIES RECEIVED	
DISTRIBUTION	
SANTA FE	
FILE	
U.S.G.S.	
LAND OFFICE	
OPERATOR	

# NEW MEXICO OIL CONSERVATION COMMISSION

Form C-101  
Revised 1-1-65

5A. Indicate Type of Lease	
STATE <input checked="" type="checkbox"/>	FEE <input type="checkbox"/>
5. State Oil & Gas Lease No.	
<b>OG 1502 11-19-67</b>	

## APPLICATION FOR PERMIT TO DRILL, DEEPEN, OR PLUG BACK

1a. Type of Work		7. Unit Agreement Name	
b. Type of Well OIL WELL <input checked="" type="checkbox"/> GAS WELL <input type="checkbox"/> OTHER <input type="checkbox"/>		None	
DRILL <input checked="" type="checkbox"/> DEEPEN <input type="checkbox"/> PLUG BACK <input type="checkbox"/>		8. Farm or Lease Name	
SINGLE ZONE <input type="checkbox"/> MULTIPLE ZONE <input type="checkbox"/>		Lowe-State	
2. Name of Operator		9. Well No.	
ROGER C. HANKS, LTD.		2	
3. Address of Operator		10. Field and Pool, or Wildcat	
1102 Oil & Gas Building, Wichita Falls, Texas 76301		Undesignated	
4. Location of Well		12. County	
UNIT LETTER <b>A</b> LOCATED <b>660</b> FEET FROM THE <b>North</b> LINE		Lea	
AND <b>660</b> FEET FROM THE <b>East</b> LINE OF SEC. <b>2</b> TWP. <b>9S</b> RGE. <b>32E</b> NMPM			
21. Elevations (Show whether DF, RT, etc.)		19. Proposed Depth	
21A. Kind & Status Plug. Bond		19A. Formation	
21B. Drilling Contractor		20. Rotary or C.T.	
Drig. & Plugging Tom Brown Drig. Co.		Rotary	
22. Approx. Date Work will start		November 6, 1967	

23.

Bond \$10,000 (39-A-1)

### PROPOSED CASING AND CEMENT PROGRAM

SIZE OF HOLE	SIZE OF CASING	WEIGHT PER FOOT	SETTING DEPTH	SACKS OF CEMENT	EST. TOP
12 3/4"	8 5/8"	24# 32#	1950'	750	Surface
7 7/8"	5 1/2"	15.5# 17#	5850'	350	4850'

Operator will drill surface hole of 12 3/4" to approximately 1950' to set in to the top of the anhydrite casing off the red beds. Operator will circulate cement from 1950' to surface. Well will be drilled to approximately 5850'. One core will be taken in the San Andres at approximately 4310' to 4360'; anticipate another core from 5790' to 5850'. Operator anticipating 5 1/2" production string from surface to total depth and if zone at 5800' is productive; then completion will be attempted there and also attempted at 4300' zone.

IN ABOVE SPACE DESCRIBE PROPOSED PROGRAM: IF PROPOSAL IS TO DEEPEN OR PLUG BACK, GIVE DATA ON PRESENT PRODUCTIVE ZONE AND PROPOSED NEW PRODUCTIVE ZONE. GIVE BLOWOUT PREVENTER PROGRAM, IF ANY.

I hereby certify that the information above is true and complete to the best of my knowledge and belief.

Signed Roger C. Hanks Title General Partner Date November 3, 1967

(This space for State Use)

APPROVED BY Joe D. Hanes TITLE SUPERVISOR DISTRICT 1 DATE NOV 6 1967

CONDITIONS OF APPROVAL, IF ANY:



**LTR**



**Job separation sheet**

**NEW MEXICO OIL CONSERVATION COMMISSION  
WELL LOCATION AND ACREAGE DEDICATION PLAT**

Form C-102  
Supersedes C-128  
Effective 1-1-65

All distances must be from the outer boundaries of the Section.

Operator <b>ROGER C. HANKS, LTD.</b>			Lease <b>NOV 3 34 AM '67 LOWE STATE</b>		Well No. <b>2</b>
Unit Letter <b>A</b>	Section <b>2</b>	Township <b>9 SOUTH</b>	Range <b>32 EAST</b>	County <b>LEA</b>	
Actual Footage Location of Well: <b>660</b> feet from the <b>NORTH</b> line and <b>660</b> feet from the <b>EAST</b> line					
Ground Level Elev.	Producing Formation <b>Clear Fork</b>	Pool <b>Undesignated</b>	Dedicated Acreage: <b>40</b> Acres		

1. Outline the acreage dedicated to the subject well by colored pencil or hachure marks on the plat below.
2. If more than one lease is dedicated to the well, outline each and identify the ownership thereof (both as to working interest and royalty).
3. If more than one lease of different ownership is dedicated to the well, have the interests of all owners been consolidated by communitization, unitization, force-pooling, etc?

☐ Yes ☐ No If answer is "yes," type of consolidation \_\_\_\_\_

If answer is "no," list the owners and tract descriptions which have actually been consolidated. (Use reverse side of this form if necessary.) \_\_\_\_\_

No allowable will be assigned to the well until all interests have been consolidated (by communitization, unitization, forced-pooling, or otherwise) or until a non-standard unit, eliminating such interests, has been approved by the Commission.

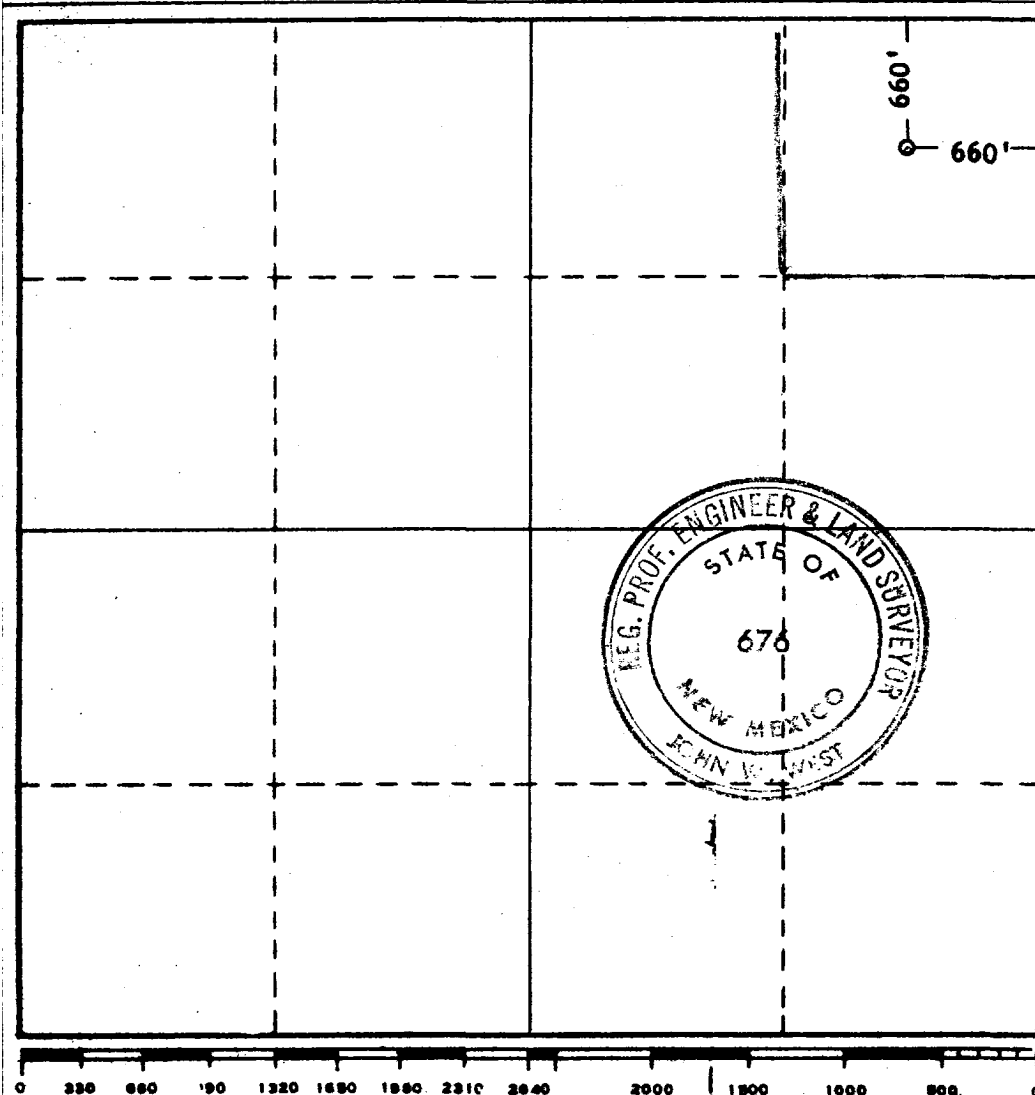

**CERTIFICATION**

*I hereby certify that the information contained herein is true and complete to the best of my knowledge and belief.*

Name *Roger C. Hanks*  
 Position **General Partner**  
 Company **ROGER C. HANKS, LTD.**  
 Date **November 3, 1967**

*I hereby certify that the well location shown on this plat was plotted from field notes of actual surveys made by me or under my supervision, and that the same is true and correct to the best of my knowledge and belief.*

Date Surveyed  
**Nov. 2, 1967**  
 Registered Professional Engineer  
and/or Land Surveyor

*John W. West*  
 Certificate No. **676**