

NO. OF COPIES RECEIVED		
DISTRIBUTION		
SANTA FE		
FILE		
U.S.G.S.		
LAND OFFICE		
OPERATOR		

NEW MEXICO OIL CONSERVATION COMMISSION  
HUBBS OFFICE, O. G. C.

JUL 2 11 25 AM '68

Form C-101  
Revised 1-1-65

5A. Indicate Type of Lease	
STATE <input type="checkbox"/>	FEE <input checked="" type="checkbox"/>
5. State Oil & Gas Lease No.	

APPLICATION FOR PERMIT TO DRILL, DEEPEN, OR PLUG BACK

1a. Type of Work		7. Unit Agreement Name	
b. Type of Well DRILL <input checked="" type="checkbox"/> DEEPEN <input type="checkbox"/> PLUG BACK <input type="checkbox"/> OIL WELL <input checked="" type="checkbox"/> GAS WELL <input type="checkbox"/> OTHER <input type="checkbox"/> SINGLE ZONE <input checked="" type="checkbox"/> MULTIPLE ZONE <input type="checkbox"/>		8. Farm or Lease Name WARD INSALL	
2. Name of Operator TENNECO OIL COMPANY		9. Well No. 1	
3. Address of Operator Box 1031 MIDLAND, TEXAS 79701		10. Field or Lease Name VANDERBILT	
4. Location of Well UNIT LETTER D LOCATED 660 FEET FROM THE NORTH LINE AND 660 FEET FROM THE WEST LINE OF SEC. 12 TWP. 9S RGE. 34E NMPM		12. County LEA	
19. Proposed Depth 9950		19A. Formation BOUGH C	
20. Rotary or C.T. ROTARY		21. Elevations (Show whether DF, RT, etc.) 4221.3 GR.	
21A. Kind & Status Plug. Bond IN EFFECT		21B. Drilling Contractor UNKNOWN	
22. Approx. Date Work will start UPON APPROVAL			

PROPOSED CASING AND CEMENT PROGRAM

SIZE OF HOLE	SIZE OF CASING	WEIGHT PER FOOT	SETTING DEPTH	SACKS OF CEMENT	EST. TOP
17 1/2	13 3/8	48	350		SUFF TO CIRCULATE
11	8 5/8	32	4050		SUFF to top 2000'
7 7/8	5 1/2	17	TD		SUFF to top 8800' OR 100' ABOVE THE HUECO

THE OPERATOR MUST BE NOTIFIED  
24 HOURS PRIOR TO RUNNING 13 3/8  
Casing

APPROVAL VALID  
FOR 60 DAYS UNLESS  
DRILLING COMMENCES

10-3-68

IN ABOVE SPACE DESCRIBE PROPOSED PROGRAM: IF PROPOSAL IS TO DEEPEN OR PLUG BACK, GIVE DATA ON PRESENT PRODUCTIVE ZONE AND PROPOSED NEW PRODUCTIVE ZONE. GIVE BLOWOUT PREVENTER PROGRAM, IF ANY.

I hereby certify that the information above is true and complete to the best of my knowledge and belief.

Signed Monica K. Karsen Title SR. Prod Clerk Date 7-1-68

(This space for State Use)

APPROVED BY [Signature] TITLE SUPERVISOR DISTRICT DATE 7-1-68

CONDITIONS OF APPROVAL, IF ANY:

NEW MEXICO OIL CONSERVATION COMMISSION  
WELL LOCATION AND ACREAGE DEDICATION PLAT

Form C-102  
Supersedes C-128  
Effective 1-1-65

All distances must be in feet or fractions of the Section

Operator <b>TENNECO OIL COMPANY</b>			Lease <b>JUL 2 11 25 AM 1968 INSALL</b>			Well No. <b>1</b>
Unit Letter <b>D</b>	Section <b>12</b>	Township <b>9 SOUTH</b>	Range <b>34 EAST</b>	County <b>LEA</b>		
Actual Footage Location of Well:						
<b>660</b> feet from the <b>NORTH</b> line and		<b>660</b> feet from the <b>WEST</b> line				
Ground Level Elev. <b>4221.3</b>	Producing Formation <b>Bough C</b>	Pool <b>Vada</b>	<b>UNDESIGNATED</b>		Dedicated Acreage: <b>160</b>	Acres

1. Outline the acreage dedicated to the subject well by colored pencil or hachure marks on the plat below.
2. If more than one lease is dedicated to the well, outline each and identify the ownership thereof (both as to working interest and royalty).
3. If more than one lease of different ownership is dedicated to the well, have the interests of all owners been consolidated by communitization, unitization, force-pooling, etc?

☐ Yes ☒ No If answer is "yes," type of consolidation \_\_\_\_\_

If answer is "no," list the owners and tract descriptions which have actually been consolidated. (Use reverse side of this form if necessary.) \_\_\_\_\_

No allowable will be assigned to the well until all interests have been consolidated (by communitization, unitization, forced-pooling, or otherwise) or until a non-standard unit, eliminating such interests, has been approved by the Commission.

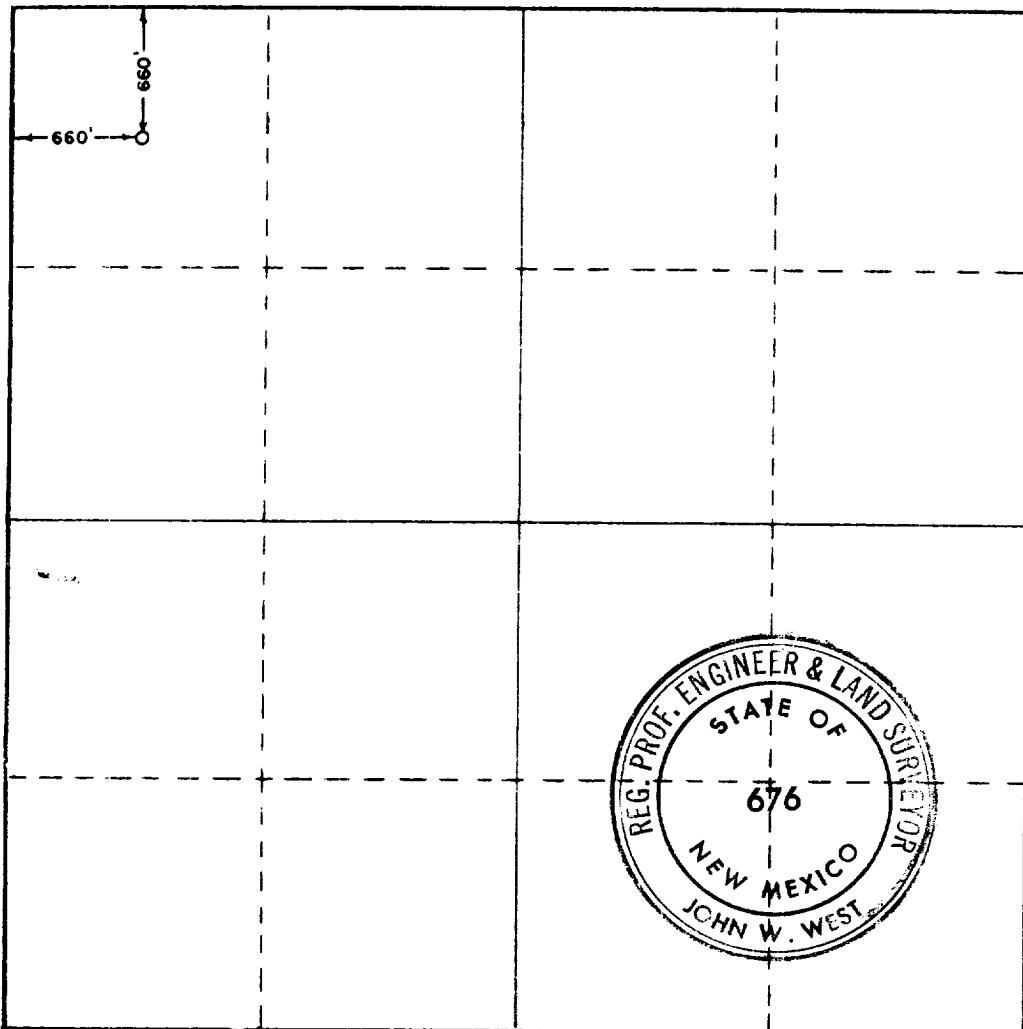

CERTIFICATION

I hereby certify that the information contained herein is true and complete to the best of my knowledge and belief.

Name **Donald R. Karsa**

Position **Dr. Prod. Clerk**

Company **Tenneco Oil Co**

Date **7-1-68**

I hereby certify that the well location shown on this plat was plotted from field notes of actual surveys made by me or under my supervision, and that the same is true and correct to the best of my knowledge and belief.

**JUNE 27, 1968**

Date Surveyed

Registered Professional Engineer and/or Land Surveyor

**John W. West**

Certificate No. **676**

0 330 660 990 1320 1650 1980 2310 2640 2970 3300 3630 3960 4290 4620 4950 5280 5610 5940 6270 6600