

NEW MEXICO OIL CONSERVATION COMMISSION
WELL LOCATION AND ACREAGE DEDICATION PLAT
HOBBS OFFICE O. C. C.

Form C-122
 Supersedes C-128
 Effective 1-1-65

All distances must be from the outer boundaries of the Section

Lessor R. R. MORRISON			Lease JUL 25 8 36 AM '68 STATE OF NEW MEXICO		Well No. 1
Tract Letter J	Section 8	Township 10 SOUTH	Range 34 EAST	County LEA	
Actual Footage Location of Well:					
1980		feet from the	SOUTH	line and	1980
					feet from the
					EAST
					line
Ground Level Elev.	Producing Formation Bough C		Pool Simanola Penn		Dedicated Acreage: 80 Acres

1. Outline the acreage dedicated to the subject well by colored pencil or hachure marks on the plat below.
2. If more than one lease is dedicated to the well, outline each and identify the ownership thereof (both as to working interest and royalty).
3. If more than one lease of different ownership is dedicated to the well, have the interests of all owners been consolidated by communitization, unitization, force-pooling, etc?

☐ Yes ☐ No If answer is "yes," type of consolidation _____

If answer is "no," list the owners and tract descriptions which have actually been consolidated. (Use reverse side of this form if necessary.) _____

No allowable will be assigned to the well until all interests have been consolidated (by communitization, unitization, forced-pooling, or otherwise) or until a non-standard unit, eliminating such interests, has been approved by the Commission.

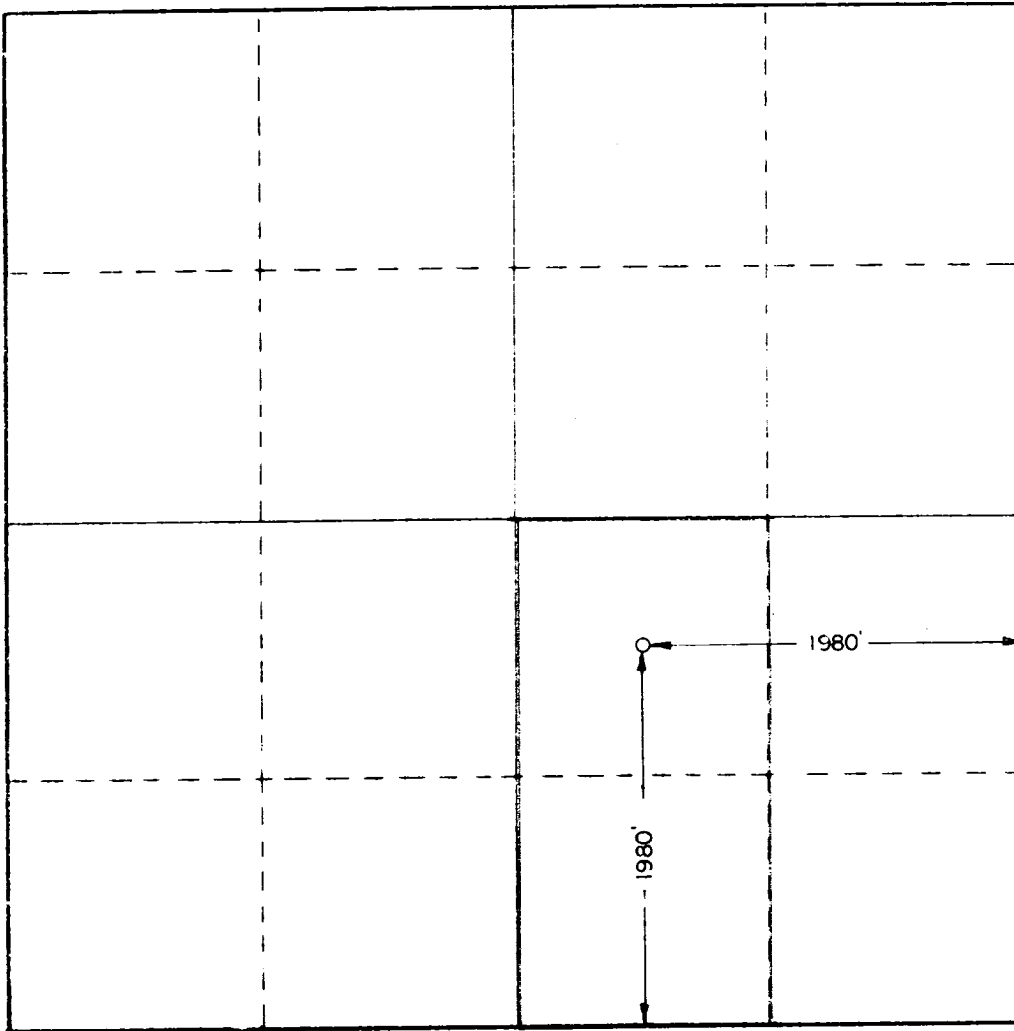

CERTIFICATION

I hereby certify that the information contained herein is true and complete to the best of my knowledge and belief

Name *Wanna Holles*

Position _____

Agent

Company _____

R. R. Morrison

Date _____

7/24/68

I hereby certify that the well location shown on this plat was plotted from field notes of actual surveys made by me or under my supervision and that the same is true and correct to the best of my knowledge and belief

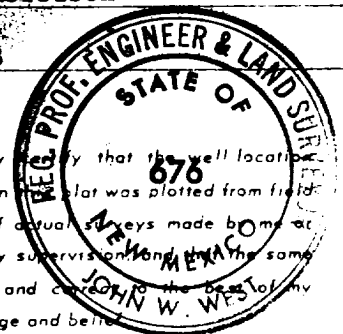

Date Surveyed _____

JULY 22, 1968

Registered Professional Engineer and/or Land Surveyor

John W. West
 Certificate No. **676**

330 660 990 1320 1650 1980 2310 2640 2000 1500 1000 500 0

173