

| | |
|------------------------|--|
| NO. OF COPIES RECEIVED | |
| DISTRIBUTION | |
| SANTA FE | |
| FILE | |
| U.S.G.S. | |
| LAND OFFICE | |
| OPERATOR | |

NEW MEXICO OIL CONSERVATION COMMISSION

Form C-101
Revised 1-1-65

SEP 11 11 38 AM '68

| |
|--|
| 5A. Indicate Type of Lease STATE <input type="checkbox"/> FEE <input checked="" type="checkbox"/> |
| 5. State Oil & Gas Lease No. |
| 7. Unit Agreement Name |
| 8. Farm or Lease Name WARD INSALL A Co |
| 9. Well No. 1 |
| 10. Field and Pool, or Wildcat UNDESIGNATED |
| 12. County LEA |
| 19. Proposed Depth 9950 |
| 19A. Formation BOUGH C |
| 20. Rotary or C.T. ROTARY |
| 21. Elevations (Show whether DF, RT, etc.) 4209.6 GR. |
| 21A. Kind & Status Plug. Bond IN EFFECT |
| 21B. Drilling Contractor NOBLE |
| 22. Approx. Date Work will start UPON APPROVAL |

APPLICATION FOR PERMIT TO DRILL, DEEPEN, OR PLUG BACK

| |
|--|
| 1a. Type of Work DRILL <input checked="" type="checkbox"/> DEEPEN <input type="checkbox"/> PLUG BACK <input type="checkbox"/> |
| b. Type of Well OIL WELL <input checked="" type="checkbox"/> GAS WELL <input type="checkbox"/> OTHER <input type="checkbox"/> SINGLE ZONE <input type="checkbox"/> MULTIPLE ZONE <input type="checkbox"/> |
| 2. Name of Operator TENNECO OIL COMPANY |
| 3. Address of Operator P.O. Box 1031 MIDLAND, TEXAS 79701 |
| 4. Location of Well UNIT LETTER A LOCATED 660 FEET FROM THE NORTH LINE AND 660 FEET FROM THE EAST LINE OF SEC. 12 TWP. 9S RGE. 34E NMPM |
| 19. Proposed Depth 9950 |
| 19A. Formation BOUGH C |
| 20. Rotary or C.T. ROTARY |
| 21. Elevations (Show whether DF, RT, etc.) 4209.6 GR. |
| 21A. Kind & Status Plug. Bond IN EFFECT |
| 21B. Drilling Contractor NOBLE |
| 22. Approx. Date Work will start UPON APPROVAL |

PROPOSED CASING AND CEMENT PROGRAM

| SIZE OF HOLE | SIZE OF CASING | WEIGHT PER FOOT | SETTING DEPTH | SACKS OF CEMENT | EST. TOP |
|--------------|----------------|-----------------|---------------|-----------------|-------------------------|
| 17 1/2 | 13 3/8 | 48 | 350 | | SUFF to CIRCULATE |
| 11 | 8 5/8 | 32 | 4050 | | SUFF to top 2000' |
| 7 7/8 | 5 1/2 | 17 | TD | | SUFF to top 8800' |
| | | | | | OR 100' ABOVE THE HUECO |

THE COMMISSION MUST BE NOTIFIED
24 HOURS PRIOR TO RUNNING 13 3/8
CASING

APPROVAL VALID
FOR 90 DAYS UNLESS
DRILLING COMMENCED

EXPIRES 12-11-68

IN ABOVE SPACE DESCRIBE PROPOSED PROGRAM: IF PROPOSAL IS TO DEEPEN OR PLUG BACK, GIVE DATA ON PRESENT PRODUCTIVE ZONE AND PROPOSED NEW PRODUCTIVE ZONE. GIVE BLOWOUT PREVENTER PROGRAM, IF ANY.

I hereby certify that the information above is true and complete to the best of my knowledge and belief.

Signed Ronald R. Karamach Title SR. PROD CLERK Date 9-3-68

(This space for State Use)

APPROVED BY [Signature] TITLE _____ DATE SEP 11 1968

CONDITIONS OF APPROVAL, IF ANY:

NEW MEXICO OIL CONSERVATION COMMISSION
WELL LOCATION AND ACREAGE DEDICATION PLAT

Form C-102
Supersedes C-128
Effective 1-1-65

All distances must be from the outer boundaries of the Section.

| | | | | | |
|--|--------------------------------------|-----------------------------|--|----------------------|----------------------|
| Operator TENNECO OIL COMPANY | | | Lease SEP 11 11:30 AM '68 WARD INS L 11A Con | | Well No. 1 |
| Unit Letter A | Section 12 | Township 9 SOUTH | Range 34 EAST | County LEA | |
| Actual Footage Location of Well: 660 feet from the NORTH line and 660 feet from the EAST line | | | | | |
| Ground Level Elev. 4209.6 | Producing Formation BUGH C | Pool UNDESIGNATED | Dedicated Acreage: 160 Acres | | |

1. Outline the acreage dedicated to the subject well by colored pencil or hachure marks on the plat below.
2. If more than one lease is dedicated to the well, outline each and identify the ownership thereof (both as to working interest and royalty).
3. If more than one lease of different ownership is dedicated to the well, have the interests of all owners been consolidated by communitization, unitization, force-pooling, etc?

☒ Yes ☐ No If answer is "yes," type of consolidation **COMMUNITIZATION**

If answer is "no," list the owners and tract descriptions which have actually been consolidated. (Use reverse side of this form if necessary.)

No allowable will be assigned to the well until all interests have been consolidated (by communitization, unitization, forced-pooling, or otherwise) or until a non-standard unit, eliminating such interests, has been approved by the Commission.

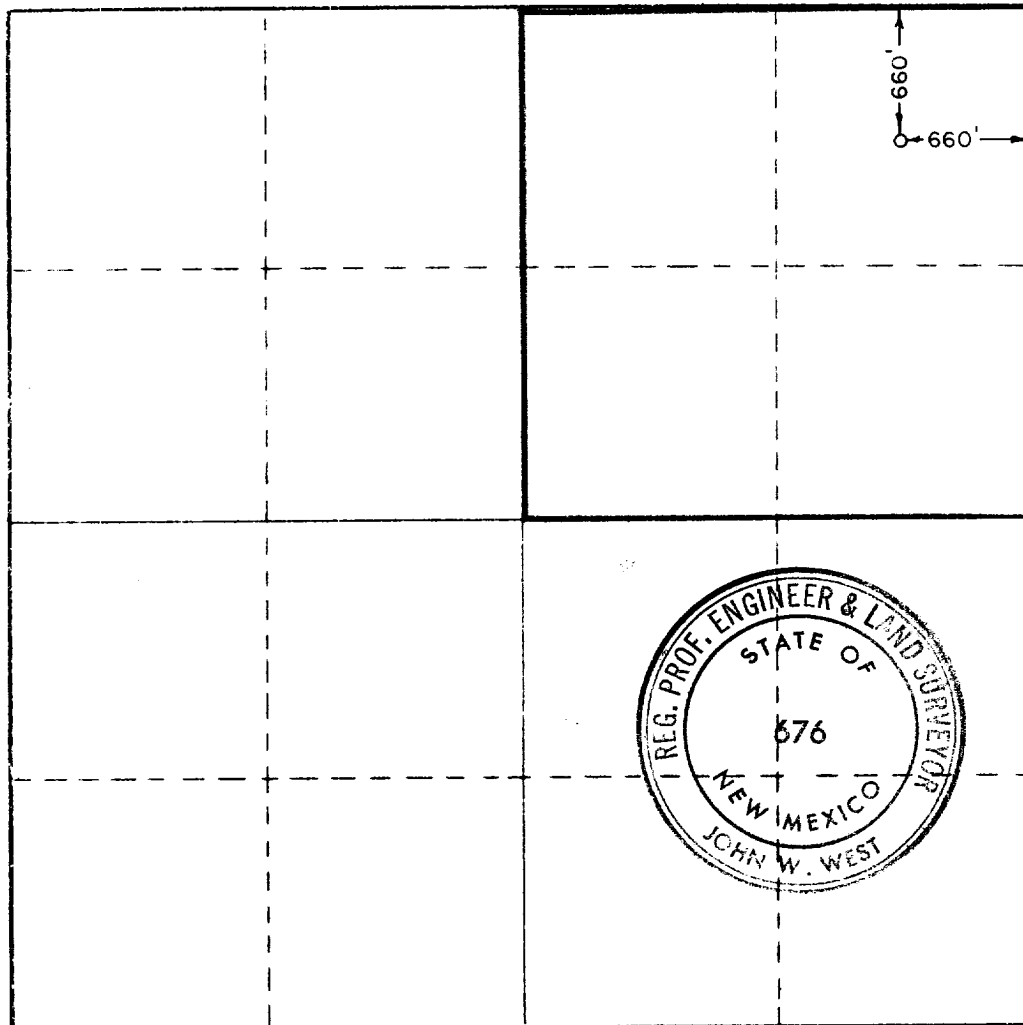

CERTIFICATION

I hereby certify that the information contained herein is true and complete to the best of my knowledge and belief

Donald R. Kamm
Position

SR PROD CLERK
Company

TENNECO OIL CO
Date

9-9-68

I hereby certify that the well location shown on this plat was plotted from field notes of actual surveys made by me or under my supervision, and that the same is true and correct to the best of my knowledge and belief.

Date Surveyed

AUGUST 8, 1968

Registered Professional Engineer and/or Land Surveyor

John W West
Certificate No.

676