

**NEW MEXICO OIL CONSERVATION COMMISSION
WELL LOCATION AND ACREAGE DEDICATION PLAT**

Form C-102
Supersedes C-128
Effective 1-1-65

All distances must be from the outer boundaries of the Section.

Operator MONSANTO COMPANY		Lease OCT 21 12 45 1968 Step "B"		Well No. 1
Unit Letter I	Section 25	Township 10S	Range 33E	County Lea
Actual Footage Location of Well: 1980 feet from the South line and 660 feet from the East line				
Ground Level Elev. Furnish Later	Producing Formation Bough "G"		Pool Vada (Penn.)	Dedicated Acreage: 160 Acres

1. Outline the acreage dedicated to the subject well by colored pencil or hachure marks on the plat below.
2. If more than one lease is dedicated to the well, outline each and identify the ownership thereof (both as to working interest and royalty).
3. If more than one lease of different ownership is dedicated to the well, have the interests of all owners been consolidated by communitization, unitization, force-pooling, etc?

☐ Yes ☐ No If answer is "yes," type of consolidation _____

If answer is "no," list the owners and tract descriptions which have actually been consolidated. (Use reverse side of this form if necessary.) _____

No allowable will be assigned to the well until all interests have been consolidated (by communitization, unitization, forced-pooling, or otherwise) or until a non-standard unit, eliminating such interests, has been approved by the Commission.

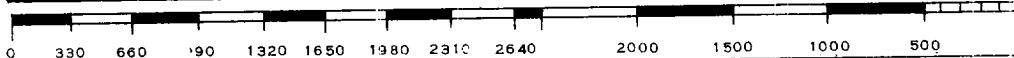
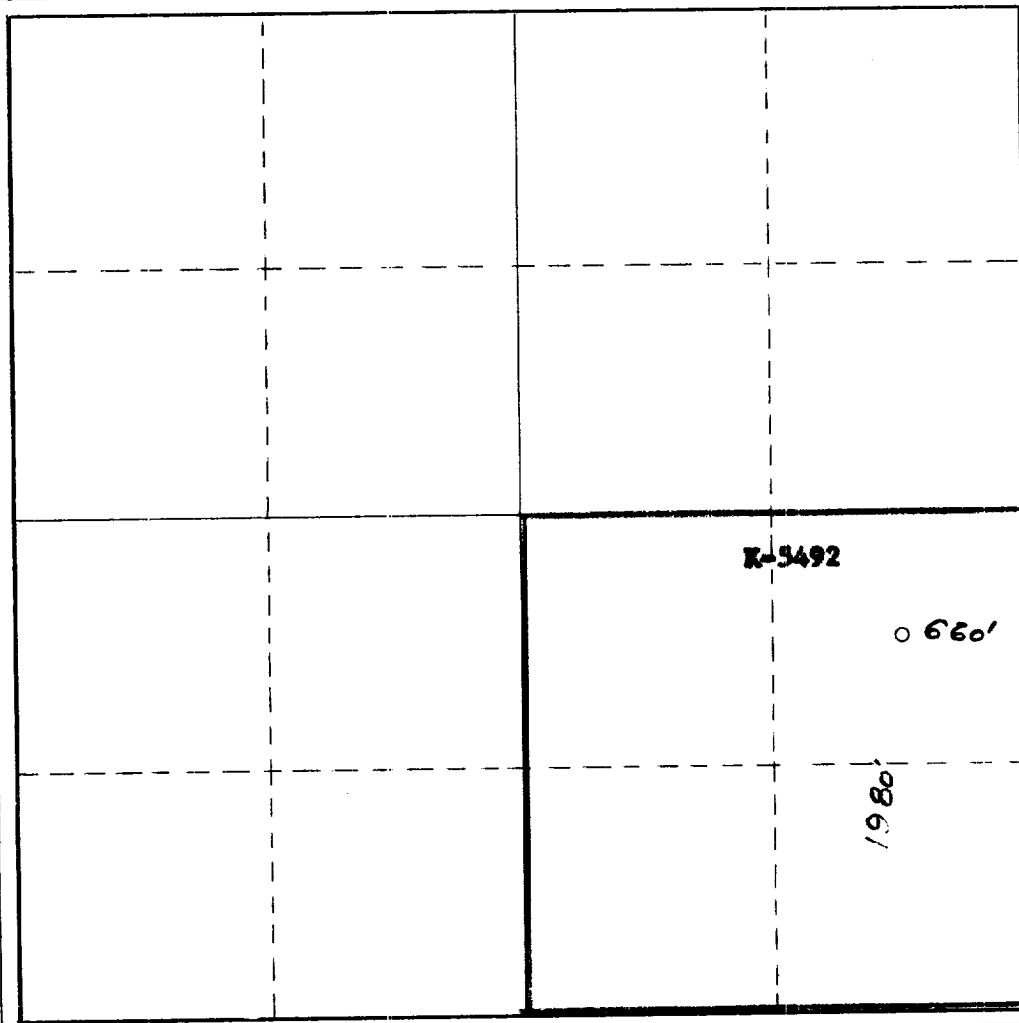

CERTIFICATION

I hereby certify that the information contained herein is true and complete to the best of my knowledge and belief.

A. W. Wood

Name **A. W. Wood**
Position **District Production Supt.**

Company **MONSANTO COMPANY**

Date **10-25-68**

I hereby certify that the well location shown on this plat was plotted from field notes of actual surveys made by me or under my supervision, and that the same is true and correct to the best of my knowledge and belief.

Date Surveyed **OCT 24 1968**

Registered Professional Engineer and/or Land Surveyor

J. M. X. Ferguson

Certificate No.

1652