

NO. OF COPIES RECEIVED	
DISTRIBUTION	
SANTA FE	
FILE	
U.S.G.S.	
LAND OFFICE	
OPERATOR	

# NEW MEXICO OIL CONSERVATION COMMISSION

Form C-101  
Revised 1-1-65

5A. Indicate Type of Lease STATE <input checked="" type="checkbox"/> FEE <input type="checkbox"/>	
5. State Oil & Gas Lease No. <b>NM-L 571</b>	
7. Unit Agreement Name	
8. Farm or Lease Name Mesclero State	
9. Well No. 1	
10. Field and Pool, or Wildcat Undesignated	
12. County Lea	
19. Proposed Depth 9200'	19A. Formation Bough "C"
20. Rotary or C.T. Rotary	
21. Elevations (Show whether DF, RT, etc.) 4272 GR.	21A. Kind & Status Plug. Bond
21B. Drilling Contractor Delta Drilling Co.	
22. Approx. Date Work will start Immediately	

APPLICATION FOR PERMIT TO DRILL, DEEPEN, OR PLUG BACK	
1a. Type of Work DRILL <input checked="" type="checkbox"/> DEEPEN <input type="checkbox"/> PLUG BACK <input type="checkbox"/>	
b. Type of Well OIL WELL <input checked="" type="checkbox"/> GAS WELL <input type="checkbox"/> OTHER <input type="checkbox"/> SINGLE ZONE <input checked="" type="checkbox"/> MULTIPLE ZONE <input type="checkbox"/>	
2. Name of Operator King Resources Company	
3. Address of Operator 300 Wall Towers West, Midland, Texas 79701	
4. Location of Well UNIT LETTER <u>G</u> LOCATED <u>1650</u> FEET FROM THE <u>North</u> LINE AND <u>1650'</u> FEET FROM THE <u>East</u> LINE OF SEC. <u>2</u> TWP. <u>10=S</u> RGE. <u>32E</u> NMPM	
23.	

## PROPOSED CASING AND CEMENT PROGRAM

SIZE OF HOLE	SIZE OF CASING	WEIGHT PER FOOT	SETTING DEPTH	SACKS OF CEMENT	EST. TOP
17-1/2"	13-3/8"		375		
12-1/4"	8-5/8"		3500		

Drill 17-1/2" hole to 375'. Set 13-3/8" casing & circulate cement. Test BOP to 1000#.

Drill 12-1/4" hole & 11" hole to 3500'± & cement 8-5/8" casing back to base of salt section. Test BOP to 1000#.

Drill 7-7/8" hole to 9200' ± TD. Run 5-1/2" casing and cement as required.

EX-105 3-17-69

IN ABOVE SPACE DESCRIBE PROPOSED PROGRAM; IF PROPOSAL IS TO DEEPEN OR PLUG BACK, GIVE DATA ON PRESENT PRODUCTIVE ZONE AND PROPOSED NEW PRODUCTIVE ZONE. GIVE BLOWOUT PREVENTER PROGRAM, IF ANY.

I hereby certify that the information above is true and complete to the best of my knowledge and belief.

Signed [Signature] Title District Engineer Date December 13, 1968

(This space for State Use)

APPROVED BY John W. Runyan TITLE  DATE

CONDITIONS OF APPROVAL, IF ANY:

NEW MEXICO OIL CONSERVATION COMMISSION  
WELL LOCATION AND ACREAGE DEDICATION PLAT

Form C-102  
Supersedes C-128  
Effective 1-1-65

All distances must be from the outer boundaries of the Section.

Operator <b>King Resources Company</b>			Lease <b>Mescalero State</b>		Well No. <b>1</b>
Unit Letter <b>G</b>	Section <b>2</b>	Township <b>10-S</b>	Range <b>32-E</b>	County <b>Lea</b>	
Actual Footage Location of Well:					
<b>1650</b> feet from the <b>East</b> line and		<b>1650</b> feet from the <b>North</b> line			
Ground Level Elev. <b>4272</b>	Producing Formation <b>Bough "C"</b>	Pool		Dedicated Acreage: <b>40</b> Acres	

1. Outline the acreage dedicated to the subject well by colored pencil or hachure marks on the plat below.
2. If more than one lease is dedicated to the well, outline each and identify the ownership thereof (both as to working interest and royalty).
3. If more than one lease of different ownership is dedicated to the well, have the interests of all owners been consolidated by communitization, unitization, force-pooling, etc?

☐ Yes ☐ No If answer is "yes," type of consolidation NA

If answer is "no," list the owners and tract descriptions which have actually been consolidated. (Use reverse side of this form if necessary.) NA

No allowable will be assigned to the well until all interests have been consolidated (by communitization, unitization, forced-pooling, or otherwise) or until a non-standard unit, eliminating such interests, has been approved by the Commission.

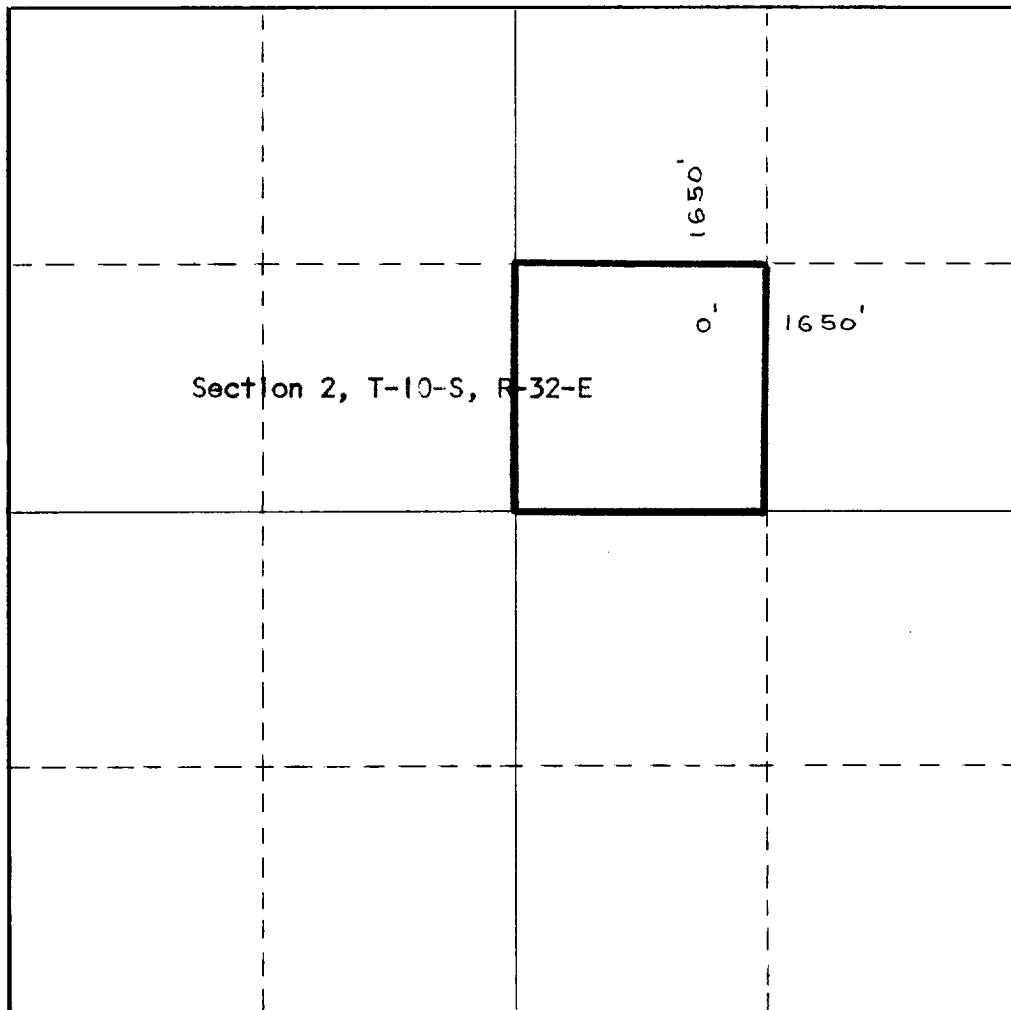

CERTIFICATION

I hereby certify that the information contained herein is true and complete to the best of my knowledge and belief.

*Foy W. Boyd, Jr.*

Name  
**Foy W. Boyd, Jr.**

Position  
**District Engineer**

Company  
**King Resources Company**

Date  
**December 13, 1968**

I hereby certify that the well location shown on this plat was plotted from field notes of actual surveys made by me or under my supervision, and that the same is true and correct to the best of my knowledge and belief.

Date Surveyed  
**12-13-68**

Registered Professional Engineer and/or Land Surveyor

*JO Wallis*

Certificate No.  
**1635**

