

NEW MEXICO OIL CONSERVATION COMMISSION
WELL LOCATION AND ACREAGE DEDICATION PLAT

Form O-102
Supersedes O-128
Effective 1-1-65

All distances must be from the outer boundaries of the Section

Operator Sam Boren		County Crowley State "A" <i>State</i>		Well No. 1
Unit Letter L	Section 5	Township 12S	Range 33E	County Lea
Actual Footage Location of Well: 660 feet from the West line and 1980 feet from the South line.				
Ground Level Elev. Lower Penn	Producing Formation N. Bagley, L. Penn.		Dedicated Acreage 80 Acres	

1. Outline the acreage dedicated to the subject well by colored pencil or hatchure marks on the plat below.
2. If more than one lease is dedicated to the well, outline each and identify the ownership thereof (both as to working interest and royalty).
3. If more than one lease of different ownership is dedicated to the well, have the interests of all owners been consolidated by communitization, unitization, force-pooling, etc?

☐ Yes ☐ No If answer is "yes" type of consolidation _____

If answer is "no" list the owners and tract descriptions which have actually been consolidated. (Use reverse side of this form if necessary.) _____

No allowable will be assigned to the well until all interests have been consolidated (by communitization, unitization, forced-pooling, or otherwise) or until a non-standard unit, eliminating such interests, has been approved by the Commission.

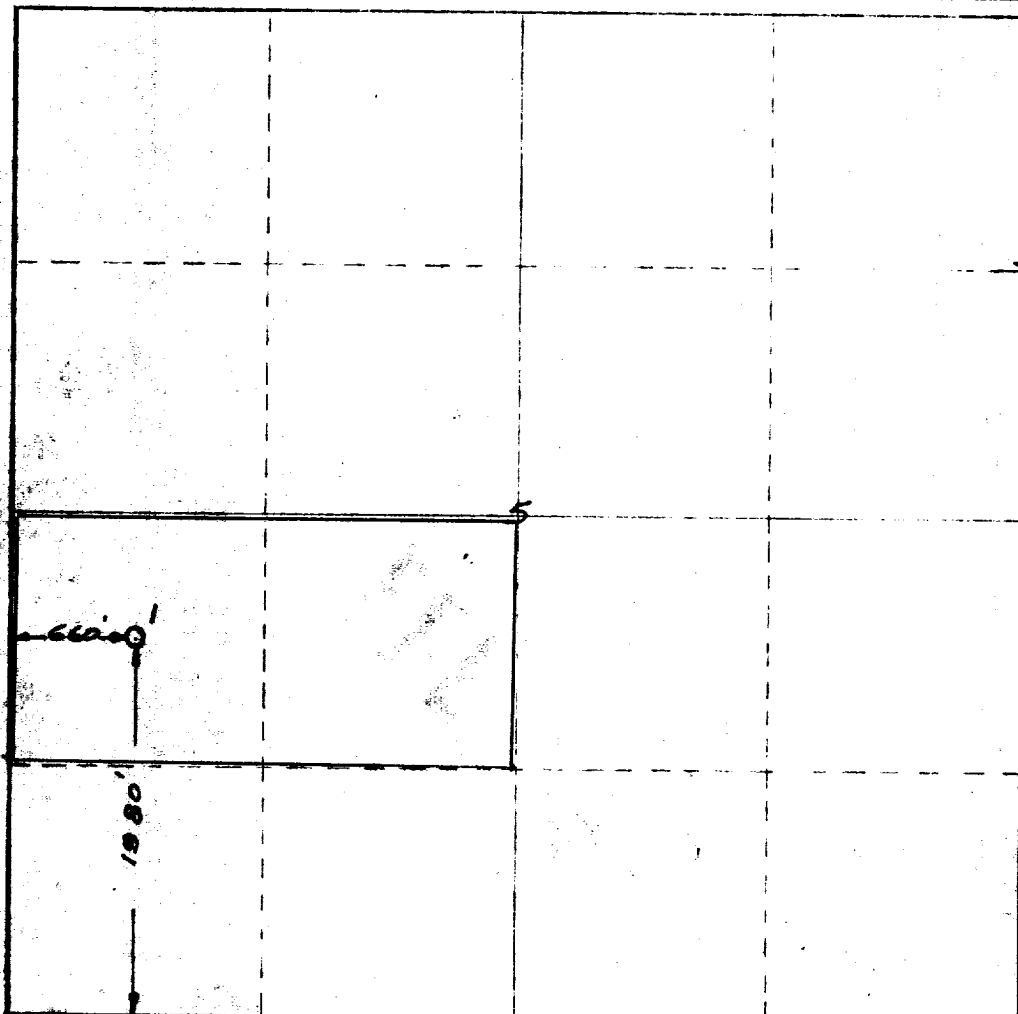

CERTIFICATION

I hereby certify that the information contained herein is true and complete to the best of my knowledge and belief.

Name _____

Position _____

Agent

Company _____

Sam Boren

Date _____

12/20/68

I hereby certify that the well location shown on this plat was plotted from field notes of actual surveys made by me or under my supervision, and that the same is true and correct to the best of my knowledge and belief.

Date Surveyed _____

Dec 20 1968

Registered Professional Engineer
and/or Land Surveyor

W. E. Shover

Certificate No. _____

2189

0 330 660 990 1320 1650 1980 2310 2640 2970 3300 3630 0