

NO. OF COPIES RECEIVED	
DISTRIBUTION	
SAN ANTONIO	
FILE	
U.S.G.S.	
LAND OFFICE	
OPERATOR	

# NEW MEXICO OIL CONSERVATION COMMISSION

Form C-101  
Revised 1-1-65

5A. Indicate Type of Lease	
STATE <input type="checkbox"/>	FEE <input checked="" type="checkbox"/>
5. State Oil & Gas Lease No.	

## APPLICATION FOR PERMIT TO DRILL, DEEPEN, OR PLUG BACK

1a. Type of Work		7. Unit Agreement Name	
b. Type of Well OIL WELL <input checked="" type="checkbox"/> GAS WELL <input type="checkbox"/> OTHER <input type="checkbox"/>		8. Farm or Lease Name Dickinson "25"	
2. Name of Operator Pennzoil United, Inc.		9. Well No. 1	
3. Address of Operator Box 1828, Midland, Texas 79701		10. Field and Pool, or Wildcat Wildcat	
4. Location of Well UNIT LETTER <u>L</u> LOCATED <u>660</u> FEET FROM THE <u>West</u> LINE AND <u>1980</u> FEET FROM THE <u>South</u> LINE OF SEC. <u>25</u> TWP. <u>11-S</u> RGE. <u>36-E</u> NMPM		12. County Lea	
19. Proposed Depth 3200		19A. Formation Yates	
20. Rotary or C.T. Rotary		21. Elevations (Show whether DF, RT, etc.) 3995 GL	
21A. Kind & Status Plug. Bond Blanket		21B. Drilling Contractor Cactus Drilling Corp.	
22. Approx. Date Work will start on approval			

## PROPOSED CASING AND CEMENT PROGRAM

SIZE OF HOLE	SIZE OF CASING	WEIGHT PER FOOT	SETTING DEPTH	SACKS OF CEMENT	EST. TOP
11"	8 5/8	24	375	400	Circulate
7 7/8	5 1/2	155#	3200	200	2500'

THE COMMISSIONER OF THE NEW MEXICO OIL CONSERVATION COMMISSION  
BY 878  
CASSIDY

APPROVAL VALID  
FOR 90 DAYS  
DATE 3-30-69

IN ABOVE SPACE DESCRIBE PROPOSED PROGRAM; IF PROPOSAL IS TO DEEPEN OR PLUG BACK, GIVE DATA ON PRESENT PRODUCTIVE ZONE AND PROPOSED NEW PRODUCTIVE ZONE. GIVE BLOWOUT PREVENTER PROGRAM, IF ANY.

I hereby certify that the information above is true and complete to the best of my knowledge and belief.

Signed [Signature] Title Drig. Supt. Date 12/26/68

(This space for State Use)

APPROVED BY [Signature] TITLE  DATE 12 30 1968

CONDITIONS OF APPROVAL, IF ANY:

NEW MEXICO OIL CONSERVATION COMMISSION  
WELL LOCATION AND ACREAGE DEDICATION PLAT

Form C-102  
Supersedes C-128  
Effective 1-1-65

All distances must be from the outer boundaries of the Section.

Operator <b>PENNZOIL UNITED, INC.</b>		Lease <b>Dickinson</b> <del>25</del> <b>25</b>		Well No. <b>1</b>
Unit Letter <b>L</b>	Section <b>25</b>	Township <b>11 SOUTH</b>	Range <b>36 EAST</b>	County <b>LEA</b>
Actual Footage Location of Well: <b>1980</b> feet from the <b>SOUTH</b> line and <b>660</b> feet from the <b>WEST</b> line				
Ground Level Elev. <b>3995</b>	Producing Formation <b>Yates</b>	Pool <b>Wildcat</b>	Dedicated Acreage: <b>NW/4 SW/4 40 Acres</b>	

1. Outline the acreage dedicated to the subject well by colored pencil or hatchure marks on the plat below.
2. If more than one lease is dedicated to the well, outline each and identify the ownership thereof (both as to working interest and royalty).
3. If more than one lease of different ownership is dedicated to the well, have the interests of all owners been consolidated by communitization, unitization, force-pooling, etc?

☐ Yes ☐ No If answer is "yes," type of consolidation \_\_\_\_\_

If answer is "no," list the owners and tract descriptions which have actually been consolidated. (Use reverse side of this form if necessary.) \_\_\_\_\_

No allowable will be assigned to the well until all interests have been consolidated (by communitization, unitization, forced-pooling, or otherwise) or until a non-standard unit, eliminating such interests, has been approved by the Commission.

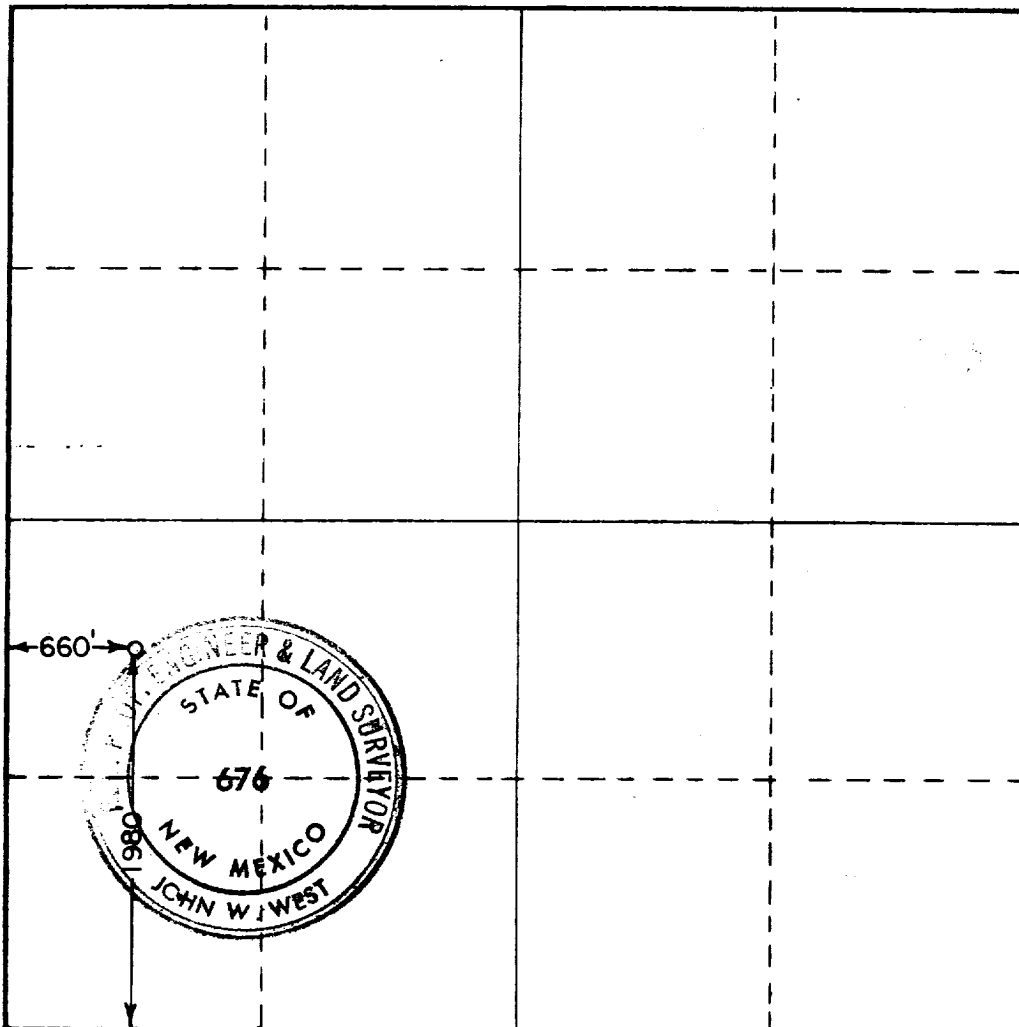

CERTIFICATION

I hereby certify that the information contained herein is true and complete to the best of my knowledge and belief.

Name *J. H. Sedwick*  
Position  
**Drilling Supt.**  
Company  
**Pennzoil United, Inc.**  
Date  
**12/26/68**

I hereby certify that the well location shown on this plat was plotted from field notes of actual surveys made by me or under my supervision, and that the same is true and correct to the best of my knowledge and belief.

Date Surveyed  
**DECEMBER 21, 1968**  
Registered Professional Engineer  
and/or Land Surveyor

*John W. West*  
Certificate No. **676**

COUNTY LEA FIELD Wildcat STATE NM 30-025-22938

OPR PENNMOLL UNITED, INC. MAP

1 Dickinson "25"

Sec 25, T-11-S, R-36-E CO-ORD

1980' FSL, 660' FWL of Sec.

Spd 12-28-68

Cmp 1-2-69 CLASS EL

CSG & SX - TUBING	FORMATION	DATUM	FORMATION	DATUM
	8 5/8" at 422' w/225 sx			

LOGS EL GR RA IND HC A

TD 3200'

PLUGGED & ABANDONED

F.R. 1-2-69

TD 3200' (Yates)

Contractor - Cactus Drlg. Co.

1-6-69 TD 3200'; PLUGGED & ABANDONED

Drilled as Strat Test, No Information Released.

1-9-69 COMPLETION REPORTED

Distribution limited and publication prohibited by subscribers' agreement.  
Reproduction rights reserved by Williams & Lee Scouting Service, Inc.

CONT. Cactus Drlg. Co. PROP DEPTH 3200' TYPE

DATE