

NEW MEXICO OIL CONSERVATION COMMISSION
WELL LOCATION AND ACREAGE DEDICATION PLAT

Form C-102
Supersedes C-128
Effective 1-1-65

All distances must be from the outer boundaries of the Section.

Operator ROGER C. HANKS		Date JUL 23 10 04 AM '69		Well No. 1
Unit Letter H	Section 11	Township 9 SOUTH	Range 32 EAST	County LEA
Actual Footage Location of Well: 1980 feet from the NORTH line and 660 feet from the EAST line				
Ground Level Elev. 4426.5	Producing Formation Bough "C"	Pool Undesignated - Wildcat	Dedicated Acreage: 160 Acres	

1. Outline the acreage dedicated to the subject well by colored pencil or hachure marks on the plat below.
2. If more than one lease is dedicated to the well, outline each and identify the ownership thereof (both as to working interest and royalty).
3. If more than one lease of different ownership is dedicated to the well, have the interests of all owners been consolidated by communitization, unitization, force-pooling, etc?

☐ Yes ☐ No If answer is "yes," type of consolidation _____

If answer is "no," list the owners and tract descriptions which have actually been consolidated. (Use reverse side of this form if necessary.) _____

No allowable will be assigned to the well until all interests have been consolidated (by communitization, unitization, forced-pooling, or otherwise) or until a non-standard unit, eliminating such interests, has been approved by the Commission.

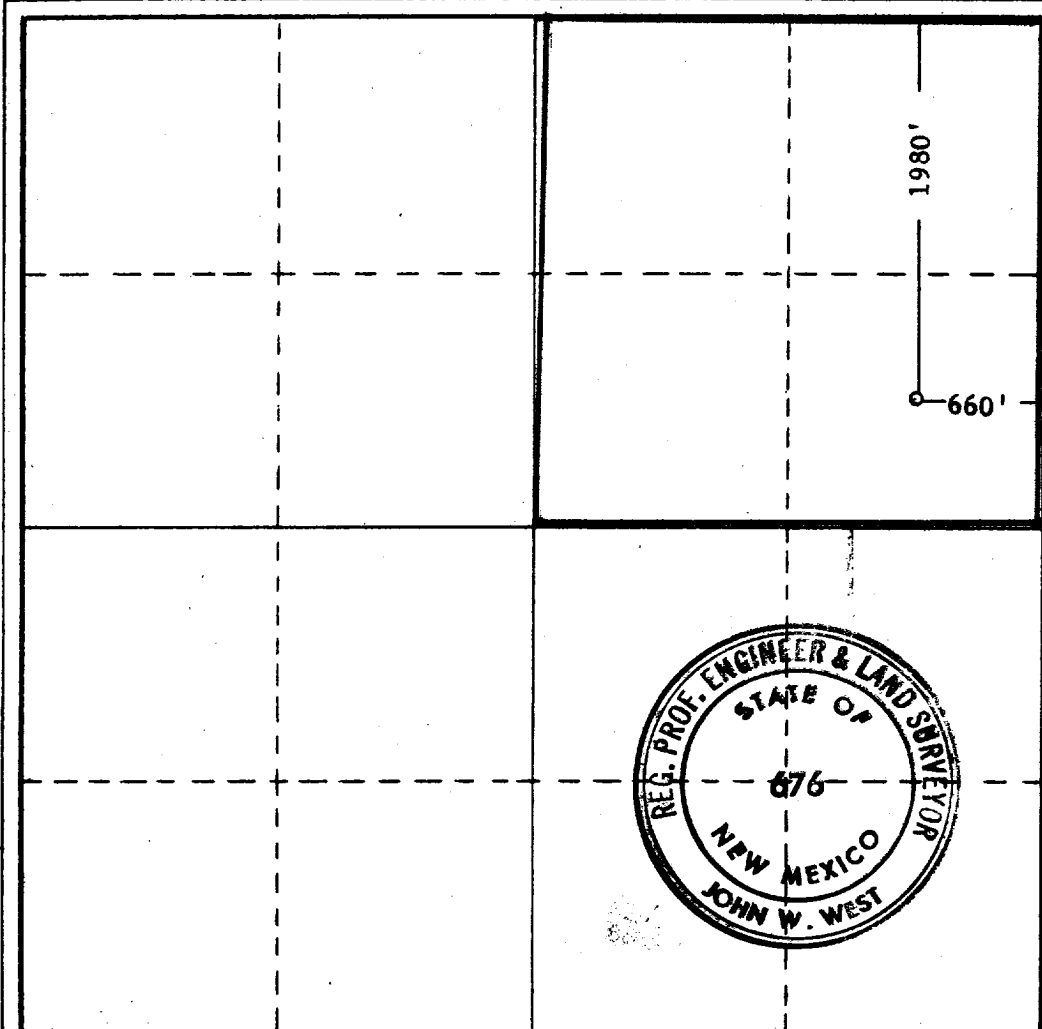

CERTIFICATION

I hereby certify that the information contained herein is true and complete to the best of my knowledge and belief.

Name
Roger C. Hanks
Position
Operator

Company
ROGER C. HANKS

Date
July 23, 1969

I hereby certify that the well location shown on this plat was plotted from field notes of actual surveys made by me or under my supervision, and that the same is true and correct to the best of my knowledge and belief.

Date Surveyed
7-23-1969

Registered Professional Engineer and/or Land Surveyor

John W. West
Certificate No. **676**

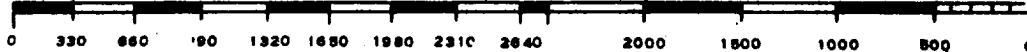

COUNTY LEA FIELD Bar U STATE NM 30-025-23237
 OPR HANKS, ROGER C. MAP
 1 Teresa
 Sec 11, T-9-S, R-32-E CO-ORD
 1980' FNL, 660' FEL of Sec.
 Spd 8-5-69
 Cmp 9-23-69 CLASS EL

	FORMATION	DATUM	FORMATION	DATUM
CSG & SX - TUBING				
13 3/8" at 400' w/400 SX				
8 5/8" at 3643' w/350 SX				
5 1/2" at 9214' w/400 SX				
LOGS EL GR RA IND HC A				
	TD 9214'			

IP (Bough "C") Perfs 9106-32' P 474 BOPD + 80 BW. Pot based on
 24 hr test. GOR 680; Grav 47.

Distribution limited and publication prohibited by subscribers' agreement.
 Reproduction rights reserved by Williams & Lee Scouting Service, Inc.

CONT. FWA PROP DEPTH 9200' TYPE
 DATE

F.R. 8-5-69
 PD 9200' (Bough "C")
 Contractor - FWA
 10-2-69 AMEND FIELD NAME, Formerly reported as
 Undesignated.
 8-11-69 Drlg. 3700'
 8-19-69 Drlg. 6964' 1m
 8-25-69 Drlg. 8226'
 9-2-69 TD 9214'; WOC
 9-8-69 TD 9214'; Prep Swab
 Perf 9106-32'
 Acid (9106-32') 1000 gals
 9-15-69 TD 9214'; TO Pmp
 9-22-69 TD 9214'; TO Pmp

LEA Bar U NM Sec 11,T9S,R32E
HANKS, ROGER C. 1 Teresa Page #2

9-30-69 TD 9214'; COMPLETE
LOG TOPS: Anhydrite 1782', Yates 2388',
San Andres 3610', Glorieta 5032', Tubb
6500', Wolfcamp 8525', Bough "C" 9100'
10-2-69 COMPLETION REPORTED