

NEW MEXICO OIL CONSERVATION COMMISSION WELL LOCATION AND ACREAGE DEDICATION PLAT

HOBBS OFFICE

All distances must be from the outer boundaries of the section.

Owner Charles B. Read & Norman L. Stevens, Jr.		Section 13		Township 11 SOUTH		Range 32 EAST		County LEA	
Well Name A		Section 13		Township 11 SOUTH		Range 32 EAST		County LEA	

Section Postage Location of Well: 660 feet from the NORTH line and 510 feet from the EAST line	
---	--

Depth of Well 4319	Producing Formation Lower Pennsylvanian	Pool North Bagley Lowe & Penn	Date 9/29/66
------------------------------	---	---	------------------------

- Outline the acreage dedicated to the subject well by colored pencil or hatchure marks on the plat below.
- If more than one lease is dedicated to the well, outline each and identify the ownership thereof (both as to working interest and royalty).
- If more than one lease of different ownership is dedicated to the well, have the interests of all owners been consolidated by communitization, unitization, force-pooling, etc?

☒ Yes ☐ No If answer is "yes," type of consolidation _____

If answer is "no," list the owners and tract descriptions which have actually been consolidated (use separate sheet if necessary.) _____

No allowable will be assigned to the well until all interests have been consolidated (by communitization, unitization, force-pooling, or otherwise) or until a non-standard unit, eliminating such interests, has been approved by the Commission.

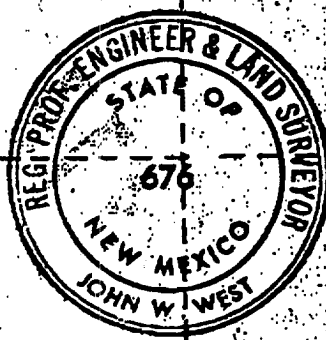
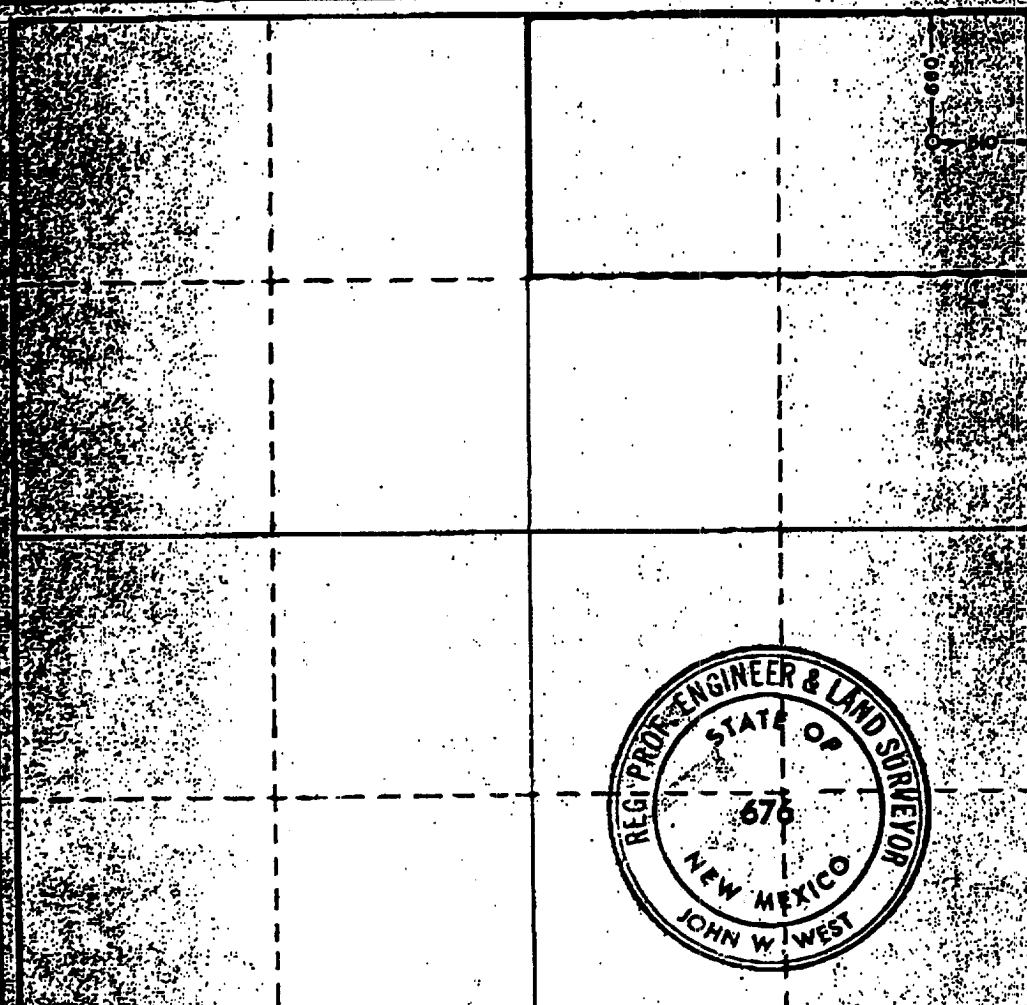

Signature <i>John W. West</i>	
Name John W. West	
Address Agua Fria	
Owner Charles B. Read & Norman L. Stevens, Jr.	
Date September 29, 1966	
Surveyed SEPTEMBER 29, 1966	
Registered Professional Engineer <i>John W. West</i>	

42
MAY 2009
Received
Hobbs
DCB

YATES PETROLEUM CORPORATION

Caprock AVD State #1

Drilling Prognosis

Page 2

Well was drilled by Read & Stevens as the State F #1 well. Yates Petroleum Corporation's plan is to re-enter the well with a pulling unit and reverse unit to drill out the cement plugs in the 12 3/4" casing and in the top of the 8 5/8" casing at 1,502', then tie back the 8 5/8" casing to surface. After the casing has been repaired and the cement plug in the bottom of the 8 5/8" casing at 3,650' has been drilled out, a drilling rig will be moved on the well and the drilling rig will drill out the cement plugs in the 7 7/8" open hole and will deepen the well from 10,462' to 12,500'. Mud to be used is 9.5 to 9.8 ppg brine water, 55-70 viscosity. After reaching TD a new suite of open hole logs will be run then a string of 4 1/2" casing will be run to bottom and cemented to 6,500' +/- . The well will be completed with a pulling unit. Possible formations to be completed will be the Atoka/Morrow from 11,500' +/- to 12,200' +/-.

BOPE PROGRAM: 5000 # BOPE will be installed on the 8 5/8 casing and tested daily..

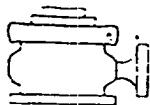

Yates Petroleum Corporation

BOP-4

Typical 5,000 psi Pressure System Schematic Annular with Double Ram Preventer Stack

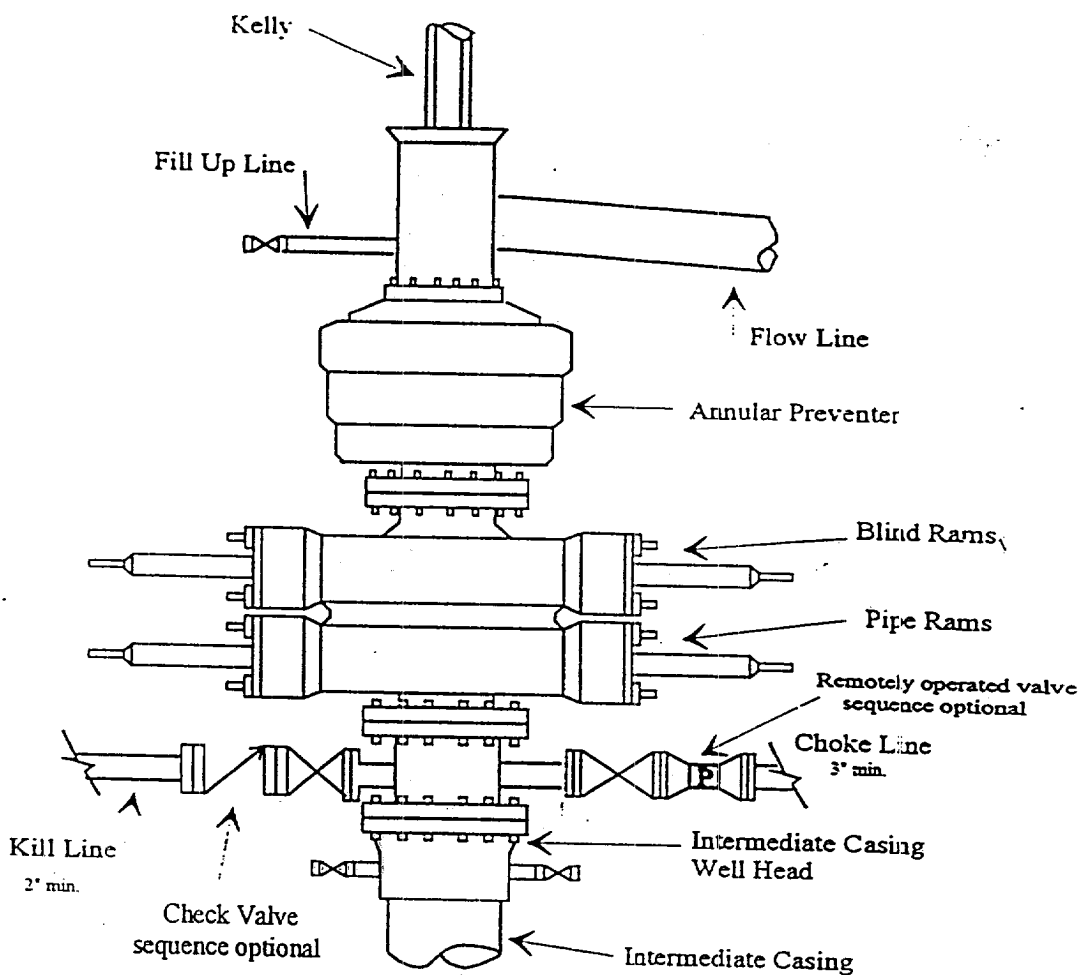

Typical 5,000 psi choke manifold assembly with at least these minimum features

