

NO. OF COPIES RECEIVED	
DISTRIBUTION	
SANTA FE	
FILE	
U.S.G.S.	
LAND OFFICE	
OPERATOR	

NEW MEXICO OIL CONSERVATION COMMISSION

Form C-101
Revised 1-1-65

5A. Indicate Type of Lease
STATE ☐ FEE ☒

5. State Oil & Gas Lease No.
-

APPLICATION FOR PERMIT TO DRILL, DEEPEN, OR PLUG BACK

1a. Type of Work DRILL <input type="checkbox"/> RE-ENTRY <input type="checkbox"/> DEEPEN <input type="checkbox"/> PLUG BACK <input type="checkbox"/>		7. Unit Agreement Name None
b. Type of Well OIL WELL <input checked="" type="checkbox"/> GAS WELL <input type="checkbox"/> OTHER <input type="checkbox"/> SINGLE ZONE <input checked="" type="checkbox"/> MULTIPLE ZONE <input type="checkbox"/>		8. Farm or Lease Name BTA-LULA
2. Name of Operator TYRA & TYRA		9. Well No. 1
3. Address of Operator 1208 Vaughn Building, Midland, Texas 79701		10. Field and State or Wildcat UNDESIGNATED Vada Penn.
4. Location of Well UNIT LETTER - LOCATED 1980 FEET FROM THE West LINE AND 510 FEET FROM THE North LINE OF SEC. 22 TWP. 9-S RGE. 35-East MPM		12. County Lea
21. Elevations (Show whether DF, RT, etc.) 4144' DF		19. Proposed Depth 9820'
21A. Kind & Status Plug. Bond \$5,000 One Well		19A. Formation Bough "C"
21B. Drilling Contractor Not yet named.		20. Rotary or C.T. Rotary
		22. Approx. Date Work will start December 29, 1971

PROPOSED CASING AND CEMENT PROGRAM

SIZE OF HOLE	SIZE OF CASING	WEIGHT PER FOOT	SETTING DEPTH	SACKS OF CEMENT	EST. TOP
7 7/8"	4 1/2"	11.60	9820'	450 sks.	7800'
8 5/8"	7"	23#	2,000'	250 sks.	1500'
17" **	12 3/4"		384'	300 sks.	Cmt. Circ.

** Surface pipe left in hole. Originally this well was drilled by BTA but did not produce.

THE COMMISSION MUST BE NOTIFIED
24 HOURS PRIOR TO BEGINNING
CASING.

APPROVED
FOR 90 DAYS UNLESS
DRILLING COMMENCED,
EXPIRES 4-3-72

IN ABOVE SPACE DESCRIBE PROPOSED PROGRAM: IF PROPOSAL IS TO DEEPEN OR PLUG BACK, GIVE DATA ON PRESENT PRODUCTIVE ZONE AND PROPOSED NEW PRODUCTIVE ZONE. GIVE BLOWOUT PREVENTER PROGRAM, IF ANY.

I hereby certify that the information above is true and complete to the best of my knowledge and belief.

Signed E. L. Dyre Title Partner Date December 22, 1971

(This space for State Use)

APPROVED BY [Signature] TITLE SUPERVISOR DISTRICT I DATE JAN 3 1972
CONDITIONS OF APPROVAL, IF ANY:

U.S. DEPARTMENT OF THE INTERIOR
BUREAU OF LAND MANAGEMENT

NOV 1971

RECEIVED

**NEW KICO OIL CONSERVATION COMMISSION
WELL LOCATION AND ACREAGE DEDICATION PLAT**

Form C-102
Supersedes C-128
Effective 1-1-65

All distances must be from the outer boundaries of the Section.

Operator TYRA & TYRA			Lease BTA -LULA		Well No. 1
Unit Letter -	Section 22	Township 9-South	Range 35-East	County Lea	
Actual Footage Location of Well: 1980 feet from the West line and 550 510 feet from the North line					
Ground Level Elev: 4134'	Producing Formation Bough "C"	Pool Vada Penn.		Dedicated Acreage: 160 Acres	

1. Outline the acreage dedicated to the subject well by colored pencil or hachure marks on the plat below.
2. If more than one lease is dedicated to the well, outline each and identify the ownership thereof (both as to working interest and royalty).
3. If more than one lease of different ownership is dedicated to the well, have the interests of all owners been consolidated by communitization, unitization, force-pooling, etc?

☐ Yes ☐ No If answer is "yes," type of consolidation _____

If answer is "no," list the owners and tract descriptions which have actually been consolidated. (Use reverse side of this form if necessary.) _____

No allowable will be assigned to the well until all interests have been consolidated (by communitization, unitization, forced-pooling, or otherwise) or until a non-standard unit, eliminating such interests, has been approved by the Commission.

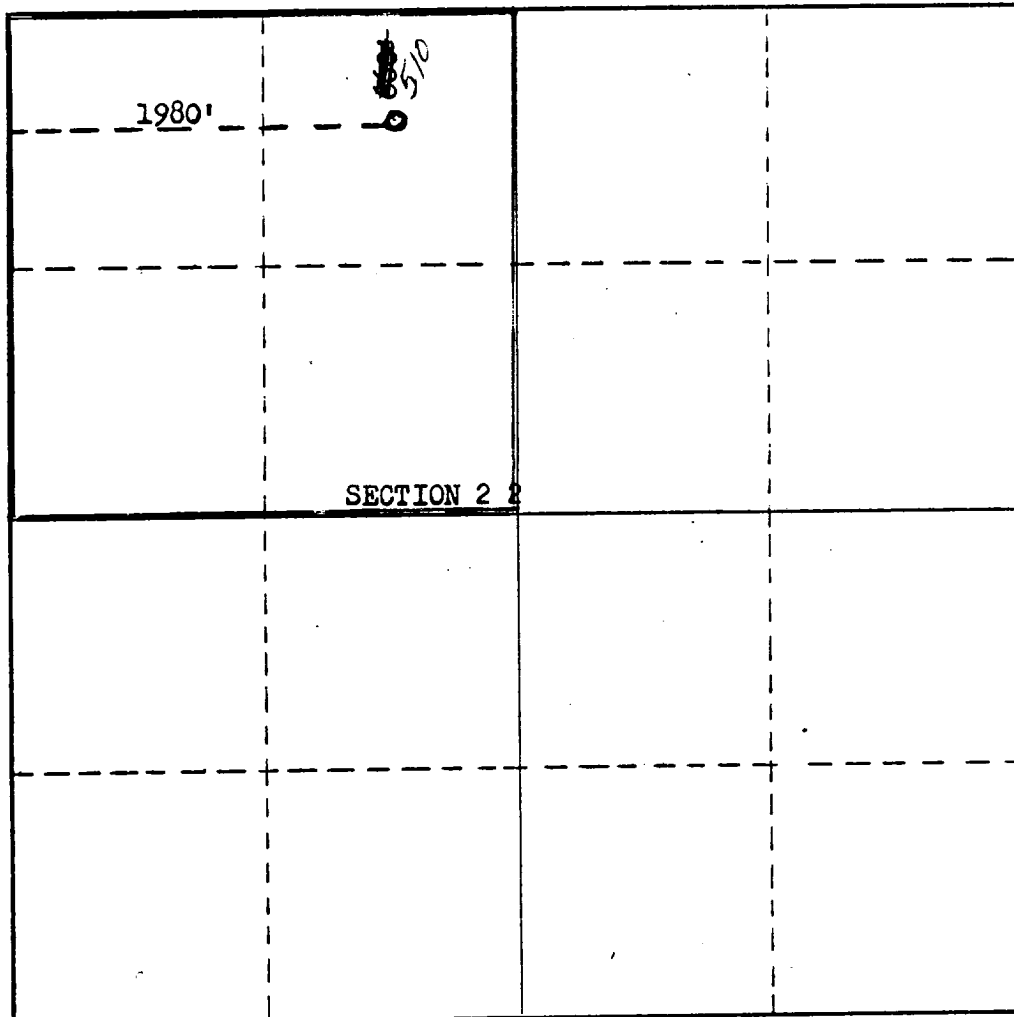

CERTIFICATION

I hereby certify that the information contained herein is true and complete to the best of my knowledge and belief.

Name

Partner

Position

TYRA & TYRA

Company

December 22, 1971

Date

I hereby certify that the well location shown on this plat was plotted from field notes of actual surveys made by me or under my supervision, and that the same is true and correct to the best of my knowledge and belief.

Re-entry

Date Surveyed

Registered Professional Engineer
and/or Land Surveyor

Certificate No.

0 330 660 990 1320 1650 1980 2310 2640 2000 1500 1000 500 0

RECEIVED

SEP 27 1971

U.S. CONSERVATION COMM.
ROBINSON, ILL.