

NO. OF COPIES RECEIVED	
DISTRIBUTION	
SANTA FE	
FILE	
U.S.G.S.	
LAND OFFICE	
OPERATOR	

NEW MEXICO OIL CONSERVATION COMMISSION

Form C-101
Revised 1-4-65

30-074-29500

5A. Indicate Type of Lease
STATE <input checked="" type="checkbox"/> FEE <input type="checkbox"/>
5. State Oil & Gas Lease No.
K-3774

APPLICATION FOR PERMIT TO DRILL, DEEPEN, OR PLUG BACK

1a. Type of Work		7. Unit Agreement Name	
b. Type of Well DRILL <input checked="" type="checkbox"/> DEEPEN <input type="checkbox"/> PLUG BACK <input type="checkbox"/> OIL WELL <input checked="" type="checkbox"/> GAS WELL <input type="checkbox"/> OTHER <input type="checkbox"/> SINGLE ZONE <input checked="" type="checkbox"/> MULTIPLE ZONE <input type="checkbox"/>		8. Farm or Lease Name	
2. Name of Operator		9. Well No.	
Meadco Properties, Ltd.		1	
3. Address of Operator		10. Field and Pool, or Wildcat	
606 Vaughn Bldg., Midland, Texas 79701		North Bagley Undesig.	
4. Location of Well		12. County	
UNIT LETTER I LOCATED 810 FEET FROM THE East LINE AND 1980' FEET FROM THE South LINE OF SEC. 5 TWP. 12S RGE. 33E NMPM		Lea	
19. Proposed Depth		19A. Formation	
10,200'		Pennsylvanian	
20. Rotary or C.T.		Rotary	
21. Elevations (Show whether DF, RT, etc.)		22. Approx. Date Work will start	
4259 GR		May 15, 1970	
21A. Kind & Status Plug. Bond		21B. Drilling Contractor	
Blanket		Moran Drilling	

23.

PROPOSED CASING AND CEMENT PROGRAM

SIZE OF HOLE	SIZE OF CASING	WEIGHT PER FOOT	SETTING DEPTH	SACKS OF CEMENT	EST. TOP
17 1/2"	12-3/4"	33#	375'	400xx	Circulate
11"	8-5/8"	24# & 32#	3800'	400xx	1850'
7"	4-1/2"	11.6# & N-80	10,200	300xx	8200'

THE COMMISSION MUST BE NOTIFIED
24 HOURS BEFORE RUNNING 12 3/4"
CASING

APPROVAL MARK

8-4-70

IN ABOVE SPACE DESCRIBE PROPOSED PROGRAM: IF PROPOSAL IS TO DEEPEN OR PLUG BACK, GIVE DATA ON PRESENT PRODUCTIVE ZONE AND PROPOSED NEW PRODUCTIVE ZONE. GIVE BLOWOUT PREVENTER PROGRAM, IF ANY.

I hereby certify that the information above is true and complete to the best of my knowledge and belief.

Signed **DAVID** Title **Owner** Date **4-30-70**

(This space for State Use)

APPROVED BY **[Signature]** TITLE **SECRETARY** DATE **MAY 4 1970**

CONDITIONS OF APPROVAL, IF ANY:

NEW MEXICO OIL CONSERVATION COMMISSION
WELL LOCATION AND ACREAGE DEDICATION PLAT

Form C-102
Supersedes C-128
Effective 1-1-65

All distances must be from the outer boundaries of the Section.

Operator MEADCO PROPERTIES, LTD.			Lease SHELL STATE		Well No. 1
Unit Letter I	Section 5	Township 12 SOUTH	Range 33 EAST	County LEA	
Actual Footage Location of Well: 1980 feet from the SOUTH line and 810 feet from the EAST line					
Ground Level Elev. 4259.5	Producing Formation Lower Penn		Pool North Bagley Lower Penn		Dedicated Acreage: 80 Acres

1. Outline the acreage dedicated to the subject well by colored pencil or hatchure marks on the plat below.
2. If more than one lease is dedicated to the well, outline each and identify the ownership thereof (both as to working interest and royalty).
3. If more than one lease of different ownership is dedicated to the well, have the interests of all owners been consolidated by communitization, unitization, force-pooling, etc?

☐ Yes ☐ No If answer is "yes," type of consolidation _____

If answer is "no," list the owners and tract descriptions which have actually been consolidated. (Use reverse side of this form if necessary.) _____

No allowable will be assigned to the well until all interests have been consolidated (by communitization, unitization, forced-pooling, or otherwise) or until a non-standard unit, eliminating such interests, has been approved by the Commission.

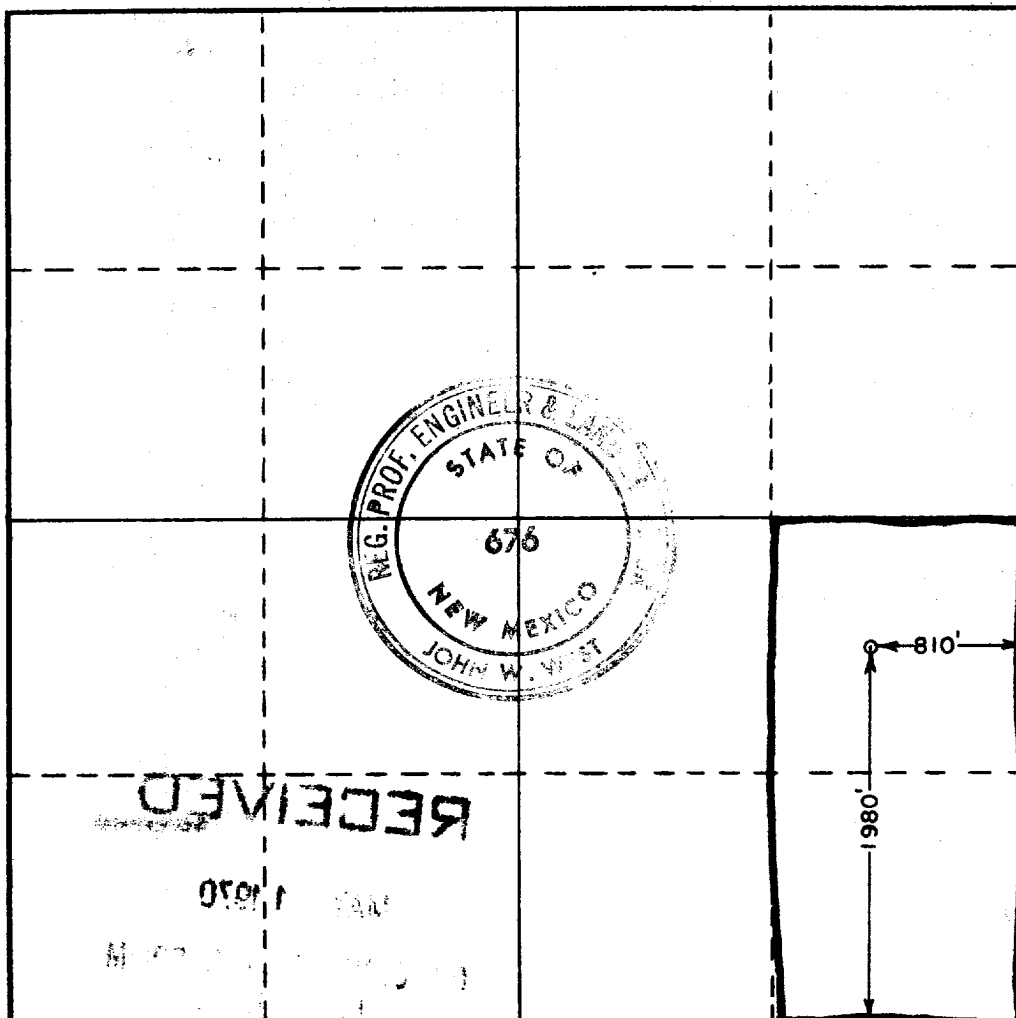

CERTIFICATION

I hereby certify that the information contained herein is true and complete to the best of my knowledge and belief.

Bill C. Cotner

Name

Bill C. Cotner

Position

Owner

Company

Meadco Properties, Ltd.

Date

4-30-70

I hereby certify that the well location shown on this plat was plotted from field notes of actual surveys made by me or under my supervision, and that the same is true and correct to the best of my knowledge and belief.

Date Surveyed

APRIL 29, 1970

Registered Professional Engineer and/or Land Surveyor

John W. West

Certificate No. **676**