

UNITED STATES
DEPARTMENT OF THE INTERIOR
GEOLOGICAL SURVEY

APPLICATION FOR PERMIT TO DRILL, DEEPEN, OR PLUG BACK

1. TYPE OF WORK: DRILL ☒ DEEPEN ☐ PLUG BACK ☐

2. TYPE OF WELL: ☒ OTHER ☐ SINGLE ZONE ☐ MULTIPLE ZONE ☐

3. NAME OF OPERATOR: Blackfoot Oil Company

4. ADDRESS OF OPERATOR: 1000 V & A Tower, Midland, Texas 79701

5. LOCATION OF WELL (Report location clearly and in accordance with any State requirements.):
At surface: 1000 V & A Tower, Unit B

6. AT proposed prod. zone: None

7. DISTANCE IN FEET AND DIRECTION FROM NEAREST TOWN OR POST OFFICE*:
6 miles N. of Crossroads

8. DEPT. OF LANDS PROPOSED TO BE:
PROPERTY OF NEARBY LAND, ETC.

9. DISTANCE FROM PROPOSED LOCATION*
TO NEAREST WELL, DRILLING, COMPLETED, OR APPLIED FOR, ON THIS LEASE, ETC.

10. ELEVATION (show whether DE, RT, GR, etc.):
4100 GL (Estimated)

11. PROPOSED CASING AND CEMENTING PROGRAM

SIZE OF HOLE	SIZE OF CASING	WEIGHT PER FOOT	SETTING DEPTH	QUANTITY OF CEMENT
15 1/2	13 3/8	48	400	400 (circulate)
12 1/4	8 5/8	32	4200	375
7 7/8	4 1/2	11.6	9900	150

- 1) Survey plat will be filed by John West Engineering, Hobbs, New Mexico.
- 2) Double ram blowout preventers will be used while drilling.
- 3) Form 9-1123 is attached.
- 4) Completion will be through casing perforations with acid used to stimulate.

12. ABOVE SPACE DESCRIBE PROPOSED PROGRAM: If proposal is to deepen or plug back, give data on present productive zone and proposed new productive zone. If proposal is to drill or deepen directionally, give pertinent data on subsurface locations and measured and true vertical depths. Give blowout prevention program, if any.

13. SIGNED: [Signature] TITLE: President DATE: July 8, 1970

14. (This space for Federal or State office use)

15. PERMIT NO. APPROVAL DATE

16. APPROVED BY TITLE DATE

17. CONDITIONS OF APPROVAL, IF ANY:

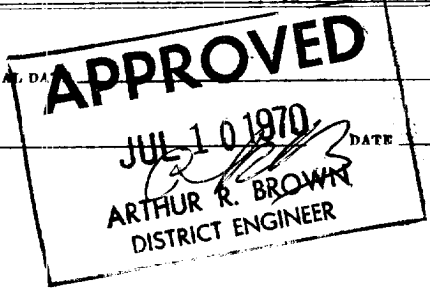

**NEW MEXICO OIL CONSERVATION COMMISSION
WELL LOCATION AND ACREAGE DEDICATION PLAT**

Form C-102
Supersedes C-128
Effective 1-1-65

All distances must be from the outer boundaries of the Section.

Operator BLACKROCK OIL COMPANY			Lease MOBIL-ATLANTIC FEDERAL		Well No. 2
Unit Letter B	Section 10	Township 9 SOUTH	Range 36 EAST	County LEA	
Actual Footage Location of Well: 660 feet from the NORTH line and 1980 feet from the EAST line					
Ground Level Elev. PENN	Producing Formation PENN	Pool ALLISON PENN	Dedicated Acreage: 80 Acres		

1. Outline the acreage dedicated to the subject well by colored pencil or hachure marks on the plat below.
2. If more than one lease is dedicated to the well, outline each and identify the ownership thereof (both as to working interest and royalty).
3. If more than one lease of different ownership is dedicated to the well, have the interests of all owners been consolidated by communitization, unitization, force-pooling, etc?

☐ Yes ☐ No If answer is "yes," type of consolidation _____

If answer is "no," list the owners and tract descriptions which have actually been consolidated. (Use reverse side of this form if necessary.) _____

No allowable will be assigned to the well until all interests have been consolidated (by communitization, unitization, forced-pooling, or otherwise) or until a non-standard unit, eliminating such interests, has been approved by the Commission.

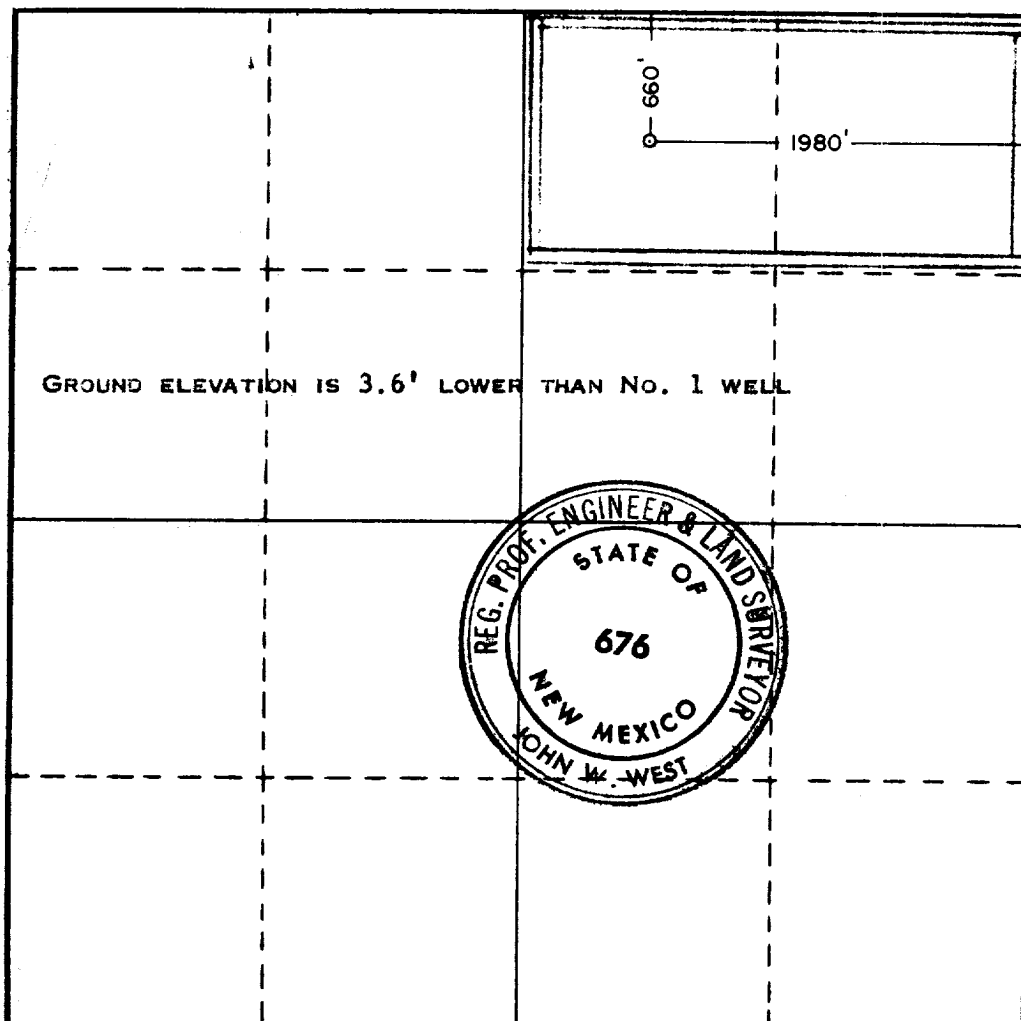

CERTIFICATION

I hereby certify that the information contained herein is true and complete to the best of my knowledge and belief.

Name John W. West
 Position AGENT
 Company BLACKROCK OIL COMPANY
 Date 7-8-1970

I hereby certify that the well location shown on this plat was plotted from field notes of actual surveys made by me or under my supervision, and that the same is true and correct to the best of my knowledge and belief.

Date Surveyed JULY 8, 1970
 Registered Professional Engineer and/or Land Surveyor
John W. West
 Certificate No. 676

