

**NEW MICO OIL CONSERVATION COMMISSION
WELL LOCATION AND ACREAGE DEDICATION PLAT**

Form C-102
Supersedes C-128
Effective 1-1-65

All distances must be from the outer boundaries of the Section.

Operator ANDERSON OIL & GAS COMPANY			Lease AMERADA STATE		Well No. 1
Unit Letter B	Section 33	Township 11-S	Range 33-E	County LEA	
Actual Postage Location of Well: 1980 feet from the East line and 660 feet from the North line					
Ground Level Elev. 4265	Producing Formation Lower Penn		Pool Bagley, Lower Penn, No.		Dedicated Acreage: 80 Acres

1. Outline the acreage dedicated to the subject well by colored pencil or hachure marks on the plat below.
2. If more than one lease is dedicated to the well, outline each and identify the ownership thereof (both as to working interest and royalty).
3. If more than one lease of different ownership is dedicated to the well, have the interests of all owners been consolidated by communitization, unitization, force-pooling, etc?

☐ Yes ☐ No If answer is "yes," type of consolidation _____

If answer is "no," list the owners and tract descriptions which have actually been consolidated. (Use reverse side of this form if necessary.) _____

No allowable will be assigned to the well until all interests have been consolidated (by communitization, unitization, forced-pooling, or otherwise) or until a non-standard unit, eliminating such interests, has been approved by the Commission.

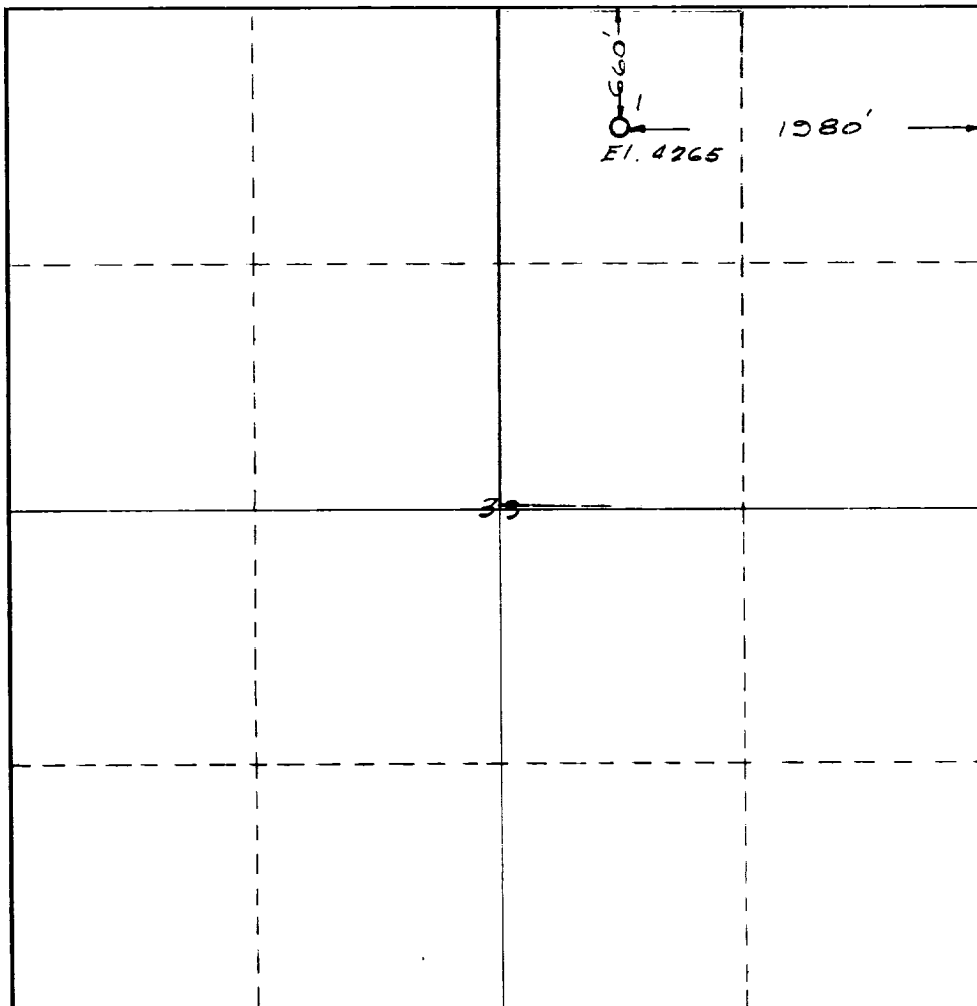

CERTIFICATION

I hereby certify that the information contained herein is true and complete to the best of my knowledge and belief.

William G. Kern
Name

William G. Kern

Position

Engineer

Company

Anderson Oil & Gas Company

Date

September 25, 1970

I hereby certify that the well location shown on this plat was plotted from field notes of actual surveys made by me or under my supervision, and that the same is true and correct to the best of my knowledge and belief.

Date Surveyed

Sept. 24, 1970

Registered Professional Engineer
and/or Land Surveyor

W. E. Shown

Certificate No.

2189

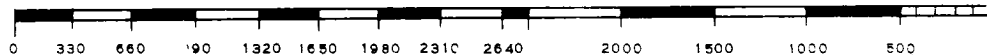

RECEIVED
OFFICE OF THE
DIRECTOR
U.S. DEPARTMENT OF AGRICULTURE
WASHINGTON, D.C.