

COUNTY LLA FIELD Bagley, N. STATE NM 30-023-23 9.

OPR ANDERSON OIL & GAS CO. MAP

1 Amerada - State

Sec 33, T-11-S, R-33-E CO-ORD

460' FNL, 1980' FEL of Sec

Spd 10-9-70 CLASS EL

Chp 11-13-70 FORMATION DATUM FORMATION DATUM

CSG & SX - TUBING
12 3/4" at 400' w/400 SX
8 5/8" at 5750' w/300 SX
5 1/2" at 10,181' w/375 SX

LOGS EL GR RA IND HC A TD 10,131' PED 10,123

12 3/4" - 11 1/2" Perfs 9705-10,030' F 309 BOPD + 17 BW. Pot
based on 24 hr test thru 24/64" chd. CO 1310; Crav 36.7;
CF PKR, 1r 450#.

Distribution limited and publication prohibited by subscribers' agreement.
Reproduction rights reserved by Williams & Lee Scouting Service, Inc.

CONT MORAN PROP DEPTH 10,200' TYPE RT
DATE

F.P. 10-6-70; Opr's Elev. 4265' CL
EL 10,200' RT (ready-to-run)
Contractor - Moran
10-12-70 Drtg 3196'
10-20-70 Drtg. 6680
10-26-70 Drtg. 8308'
11-2-70 Drtg. 9750' 1m
11-9-70 TD 10,181'; WOB
11-16-70 TD 10,181'; PED 10,123'; Istg
Perf @ 9705', 9707', 9711', 9860', 9862', 9864',
9901', 9921', 9924', 9927', 10,023', 10,026',
10,028', 10,030' w/1 3/4"
Acid (9705-10,030' 5000 gals (104)
11-23-70 TD 10,181'; PED 10,123'; Istg

11-23-70 Continued

Flwd 380 EO + 220 SW in 24 hrs thru 32/64" chn, IF 300#

11-30-71

IE 10,181', FBH 10,123'; COMPLETE
100 TOES: Anhydrite 1675', Yates 2423',
San Andre 3720', Glorieta 5117', Abo
1279', Wolfcamp 8422', Canyon 9289', Stewarts
9850'

COMPLETION REPORT

**NEW MEXICO OIL CONSERVATION COMMISSION
WELL LOCATION AND ACREAGE DEDICATION PLAT**

Form O-102
Supersedes G-128
Effective 1-1-65

All distances must be from the outer boundaries of the Section.

Operator ANDERSON OIL & GAS COMPANY			Lease AMERADA STATE		Well No. 1
Unit Letter B	Section 33	Township 11-S	Range 33-E	County Lea	
Actual Footage Location of Well: 1,980 feet from the East line and 660 feet from the North line					
Ground Level Elev. 4,265	Producing Formation Lower Penn		Pool Bagley, Penn, No.		Dedicated Acreage: 80 Acres

1. Outline the acreage dedicated to the subject well by colored pencil or hachure marks on the plat below.
2. If more than one lease is dedicated to the well, outline each and identify the ownership thereof (both as to working interest and royalty).
3. If more than one lease of different ownership is dedicated to the well, have the interests of all owners been consolidated by communitization, unitization, force-pooling, etc?

☐ Yes ☐ No If answer is "yes," type of consolidation _____

If answer is "no," list the owners and tract descriptions which have actually been consolidated. (Use reverse side of this form if necessary.) _____

No allowable will be assigned to the well until all interests have been consolidated (by communitization, unitization, forced-pooling, or otherwise) or until a non-standard unit, eliminating such interests, has been approved by the Commission.

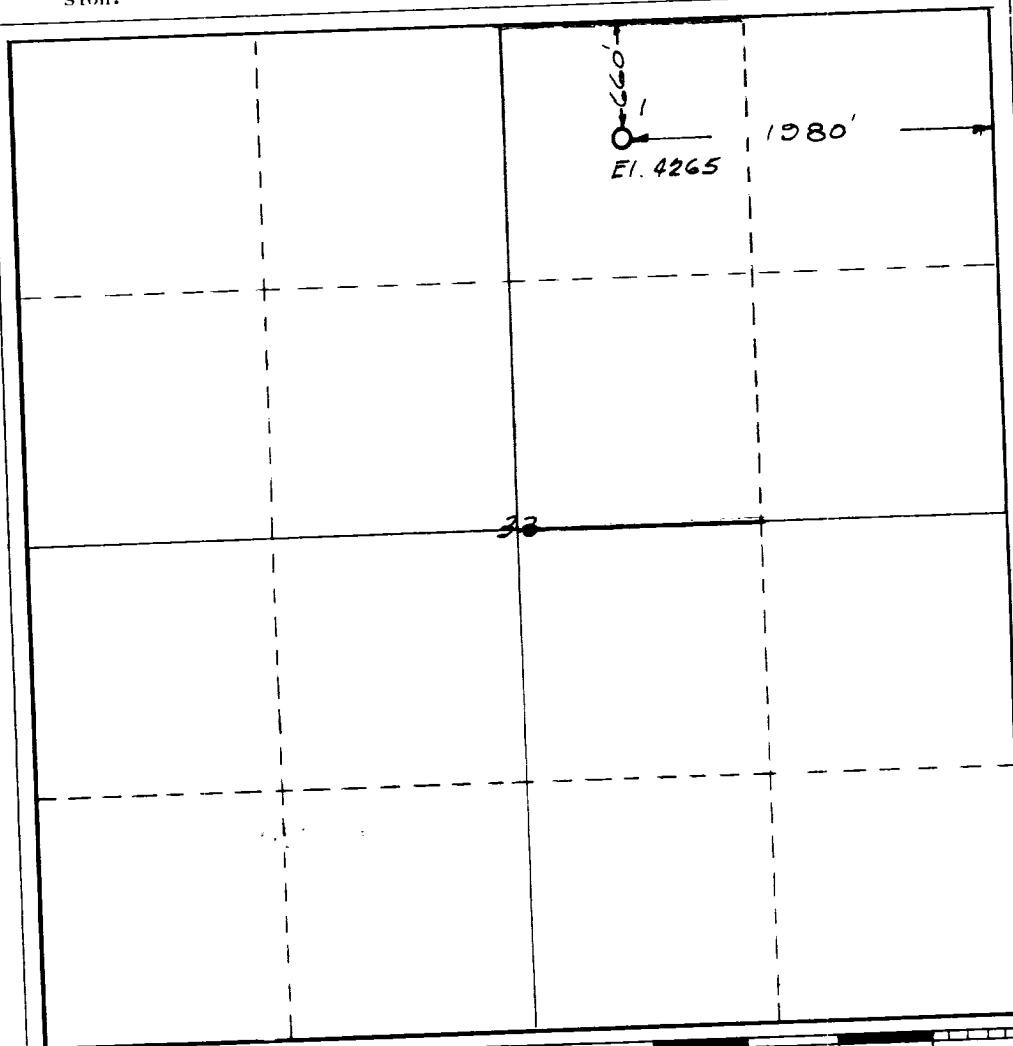

CERTIFICATION

I hereby certify that the information contained herein is true and complete to the best of my knowledge and belief.

Name
William G. Kern
 Position
Engineer
 Company
Anderson Oil & Gas Company
 Date
September 25, 1970

I hereby certify that the well location shown on this plat was plotted from field notes of actual surveys made by me or under my supervision, and that the same is true and correct to the best of my knowledge and belief.

Date Surveyed
Sept. 24, 1970
 Registered Professional Engineer
and/or Land Surveyor

Wm. E. Shor
 Certificate No.
2189