

NO. OF COPIES RECEIVED		
DISTRIBUTION		
SANTA FE		
FILE		
U.S.G.S.		
LAND OFFICE		
OPERATOR		

NEW MEXICO OIL CONSERVATION COMMISSION

Form C-101
Revised 1-1-65

5A. Indicate Type of Lease
STATE FEE

5. State Oil & Gas Lease No.
E-7067

APPLICATION FOR PERMIT TO DRILL, DEEPEN, OR PLUG BACK

1a. Type of Work DRILL <input checked="" type="checkbox"/> DEEPEN <input type="checkbox"/> PLUG BACK <input type="checkbox"/>		7. Unit Agreement Name	
b. Type of Well OIL WELL <input checked="" type="checkbox"/> GAS WELL <input type="checkbox"/> OTHER <input type="checkbox"/>		8. Farm or Lease Name State MP	
2. Name of Operator H. L. Brown, Jr.		9. Well No. 1	
3. Address of Operator 309 Midland Tower, Midland, Texas 79701		10. Field and Pool, or Wildcat South Crossroads	
4. Location of Well UNIT LETTER C LOCATED 660 FEET FROM THE North LINE AND 1980 FEET FROM THE West LINE OF SEC. 10 TWP. 10 S RGE. 36 E NMPM		12. County Lea	
		19. Proposed Depth 12,300	19A. Formation Devonian
		20. Rotary or C.T. Rotary	
21. Elevations (Show whether DF, RT, etc.) 4019' GL	21A. Kind & Status Plug. Bond Active	21B. Drilling Contractor	22. Approx. Date Work will start 12-15-70

PROPOSED CASING AND CEMENT PROGRAM

SIZE OF HOLE	SIZE OF CASING	WEIGHT PER FOOT	SETTING DEPTH	SACKS OF CEMENT	EST. TOP
15"	11-3/4"	42#	300'	300	Circulated
11"	8-5/8"	24 & 32#	4200'	250	3500'

THIS WELL IS TO BE NOTIFIED
BY THE OPERATOR OF THE
CLOSING 11 3/4"

APPROVAL MADE
FEB. 4, 1971

IN ABOVE SPACE DESCRIBE PROPOSED PROGRAM: IF PROPOSAL IS TO DEEPEN OR PLUG BACK, GIVE DATA ON PRESENT PRODUCTIVE ZONE AND PROPOSED NEW PRODUCTIVE ZONE. GIVE BLOWOUT PREVENTER PROGRAM, IF ANY.

I hereby certify that the information above is true and complete to the best of my knowledge and belief.

Signed Bill Baker Title Petroleum Engineer Date November 3, 1970

(This space for State Use)

APPROVED BY John W. Runyan TITLE _____ DATE _____

CONDITIONS OF APPROVAL, IF ANY:

RECEIVED

APR 22 1970

OIL CONSERVATION COMMISSION
WASHINGTON, D.C.

**NEW MEXICO OIL CONSERVATION COMMISSION
WELL LOCATION AND ACREAGE DEDICATION PLAT**

Form C-102
Supersedes C-128
Effective 1-1-65

All distances must be from the outer boundaries of the Section.

Operator H. L. BROWN, JR.			Lease STATE MPC			Well No. 1		
Unit Letter C	Section 10	Township 10 SOUTH	Range 36 EAST	County LEA				
Actual Footage Location of Well: 1980 feet from the WEST line and 660 feet from the NORTH line								
Ground Level Elev. 4019	Producing Formation Devonian			Pool South Crossroads			Dedicated Acreage: 80 Acres	

1. Outline the acreage dedicated to the subject well by colored pencil or hachure marks on the plat below.
2. If more than one lease is dedicated to the well, outline each and identify the ownership thereof (both as to working interest and royalty).
3. If more than one lease of different ownership is dedicated to the well, have the interests of all owners been consolidated by communitization, unitization, force-pooling, etc?

Yes No If answer is "yes," type of consolidation _____

If answer is "no," list the owners and tract descriptions which have actually been consolidated. (Use reverse side of this form if necessary.) _____

No allowable will be assigned to the well until all interests have been consolidated (by communitization, unitization, forced-pooling, or otherwise) or until a non-standard unit, eliminating such interests, has been approved by the Commission.

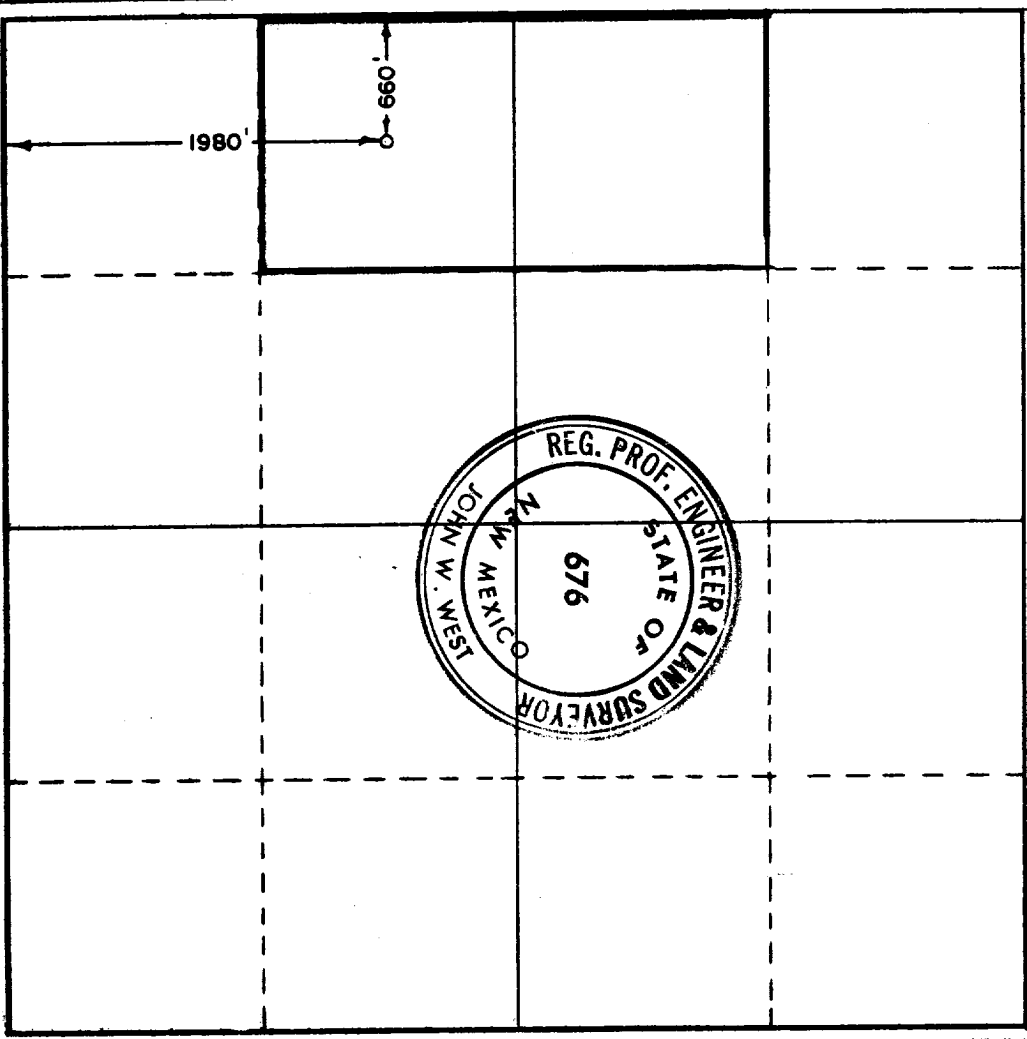

CERTIFICATION

I hereby certify that the information contained herein is true and complete to the best of my knowledge and belief.

Bill Baker

Name
Bill Baker

Position
Petroleum Engineer

Company
H. L. Brown, Jr.

Date
November 3, 1970

I hereby certify that the well location shown on this plat was plotted from field notes of actual surveys made by me or under my supervision, and that the same is true and correct to the best of my knowledge and belief.

Date Surveyed
10-30-1970

Registered Professional Engineer and/or Land Surveyor

John W. West

Certificate No. **676**

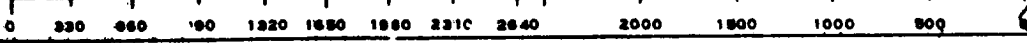

RECEIVED

1970

OIL CONSERVATION COMM.
WASHINGTON, D. C.