

| | |
|------------------------|--|
| NO. OF COPIES RECEIVED | |
| DISTRIBUTION | |
| SANTA FE | |
| FILE | |
| U.S.G.S. | |
| LAND OFFICE | |
| OPERATOR | |

NEW MEXICO OIL CONSERVATION COMMISSION

Form C-101
Revised 1-1-65

| |
|--|
| 5A. Indicate Type of Lease STATE <input checked="" type="checkbox"/> FEE <input type="checkbox"/> |
| 5. State Oil & Gas Lease No. E-9236 |
| 7. Unit Agreement Name |
| 8. Farm or Lease Name Midwest - State |
| 9. Well No. 1 |
| 10. Field and Pool, or Wildcat Vada Penn |
| 12. County Lea |

| | | | |
|---|--|--|--|
| APPLICATION FOR PERMIT TO DRILL, DEEPEN, OR PLUG BACK | | | |
| 1a. Type of Work b. Type of Well DRILL <input checked="" type="checkbox"/> DEEPEN <input type="checkbox"/> PLUG BACK <input type="checkbox"/> OIL WELL <input checked="" type="checkbox"/> GAS WELL <input type="checkbox"/> OTHER <input type="checkbox"/> SINGLE ZONE <input type="checkbox"/> MULTIPLE ZONE <input type="checkbox"/> | | | |
| 2. Name of Operator Belco Petroleum Corporation | | | |
| 3. Address of Operator P. O. Box 19234, Houston, Texas 77024 | | | |
| 4. Location of Well UNIT LETTER A LOCATED 810 FEET FROM THE North LINE AND 660 FEET FROM THE East LINE OF SEC. 2 TWP. 9-S RGE. 34-E NMPM | | | |
| 19. Proposed Depth 9900' | | 19A. Formation Bough "C" | |
| 20. Rotary or C.T. Rotary | | 21. Elevations (Show whether DF, RT, etc.) 4237 Gr. | |
| 21A. Kind & Status Plug. Bond Permanent | | 21B. Drilling Contractor Cactus Drilling Corp. | |
| 22. Approx. Date Work will start 11-21-70 | | 23. | |

PROPOSED CASING AND CEMENT PROGRAM

| SIZE OF HOLE | SIZE OF CASING | WEIGHT PER FOOT | SETTING DEPTH | SACKS OF CEMENT | EST. TOP |
|--------------|----------------|-----------------|---------------|-----------------|-----------|
| 17½" | 12-3/4" | 34# | 400 | 400 Sx | Circulate |
| 11½" | 8-5/8" | 32# | 4000 | 400 Sx | 2000' |
| 7-7/8" | 4½" | 11.6# | 9900' | 300 Sx | 8000' |

APPROVAL VALID
FOR 12 MONTHS
FROM DATE ISSUED,
Feb. 18, 1971

THE COMMISSION MUST BE NOTIFIED
24 HOURS BEFORE TO RUNNING 12 ¾"
CASING

IN ABOVE SPACE DESCRIBE PROPOSED PROGRAM: IF PROPOSAL IS TO DEEPEN OR PLUG BACK, GIVE DATA ON PRESENT PRODUCTIVE ZONE AND PROPOSED NEW PRODUCTIVE ZONE. GIVE BLOWOUT PREVENTER PROGRAM, IF ANY.

I hereby certify that the information above is true and complete to the best of my knowledge and belief.

Signed James D. Roach Title Agent Date 11/19/70

(This space for State Use)

APPROVED BY John W. Remington TITLE Commissioner DATE NOV 20 1970

CONDITIONS OF APPROVAL, IF ANY:

NEW MEXICO OIL CONSERVATION COMMISSION
WELL LOCATION AND ACREAGE DEDICATION PLAT

Form C-102
Supersedes C-128
Effective 1-1-65

All distances must be from the outer boundaries of the Section.

| | | | | | |
|--|------------------------------------|----------------------------|-------------------------------|----------------------|---|
| Operator BELCO PETROLEUM CORP. | | | Lease MIDWEST STATE | | Well No. 1 |
| Unit Letter A | Section 2 | Township 9 SOUTH | Range 34 EAST | County LEA | |
| Actual Footage Location of Well: 810 feet from the NORTH line and 660 feet from the EAST line | | | | | |
| Ground Level Elev. 4237.3 | Producing Formation PENN | | Pool VADA PENN | | Dedicated Acreage: NE 1/4 160 Acres |

1. Outline the acreage dedicated to the subject well by colored pencil or hatchure marks on the plat below.
2. If more than one lease is dedicated to the well, outline each and identify the ownership thereof (both as to working interest and royalty).
3. If more than one lease of different ownership is dedicated to the well, have the interests of all owners been consolidated by communitization, unitization, force-pooling, etc?

☐ Yes ☐ No If answer is "yes," type of consolidation _____

If answer is "no," list the owners and tract descriptions which have actually been consolidated. (Use reverse side of this form if necessary.) _____

No allowable will be assigned to the well until all interests have been consolidated (by communitization, unitization, forced-pooling, or otherwise) or until a non-standard unit, eliminating such interests, has been approved by the Commission.

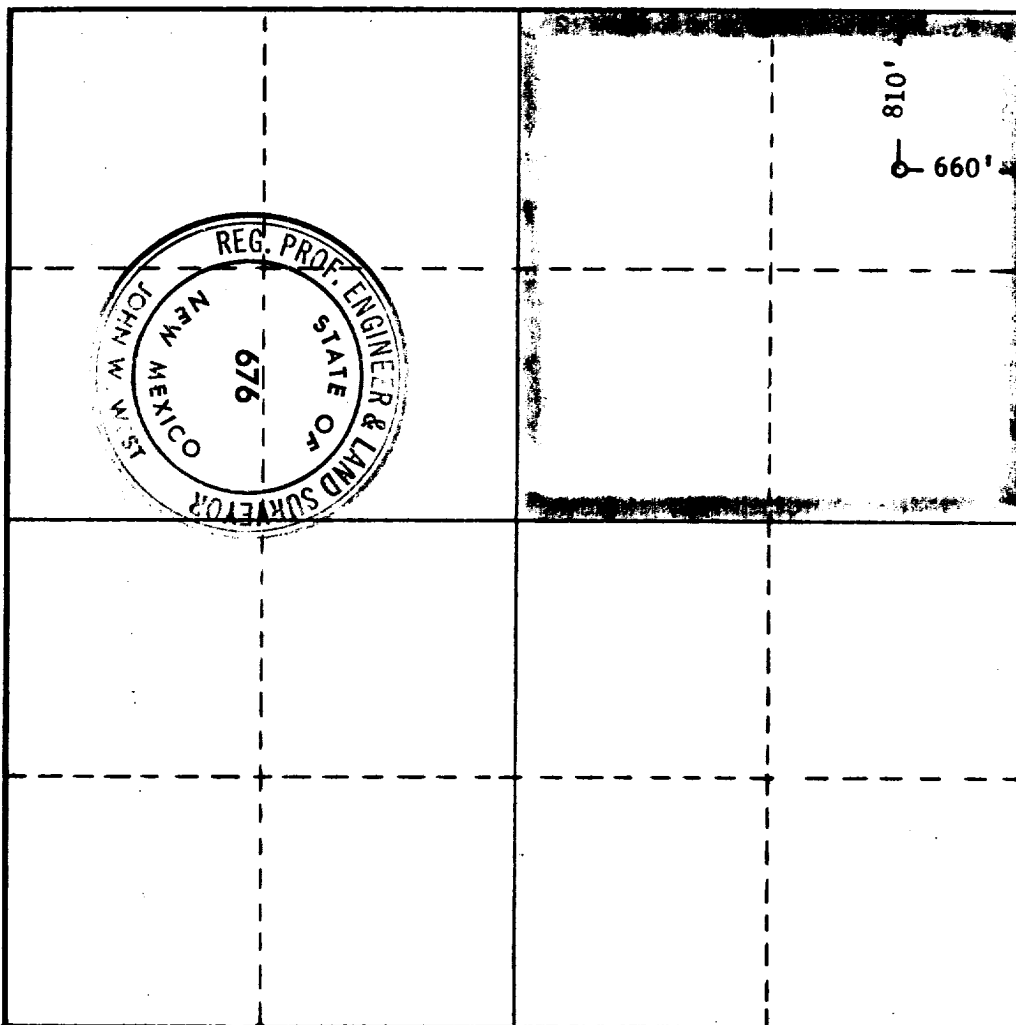

CERTIFICATION

I hereby certify that the information contained herein is true and complete to the best of my knowledge and belief.

Name
Charles D. Roach

Position
AGENT

Company
BELCO OIL CORP

Date
11-19-1970

I hereby certify that the well location shown on this plat was plotted from field notes of actual surveys made by me or under my supervision, and that the same is true and correct to the best of my knowledge and belief.

Date Surveyed
Nov. 18, 1970

Registered Professional Engineer and/or Land Surveyor

John W. West

Certificate No. **676**

