

**NEW MEXICO OIL CONSERVATION COMMISSION  
WELL LOCATION AND ACREAGE DEDICATION PLAT**

Form 102  
Supersedes C-128  
Effective 1-1-65

All distances must be from the outer boundaries of the Section.

Operator <b>TAHOE OIL &amp; CATTLE CO.</b>			Lease <b>ARCO</b>		Well No. <b>128</b>
Unit Letter <b>B</b>	Section <b>28</b>	Township <b>9-S</b>	Range <b>37-E</b>	County <b>LEA</b>	
Actual Footage Location of Well: <div style="display: flex; justify-content: space-between;"> <span>660 feet from the <b>NORTH</b> line and <b>2180</b> feet from the <b>EAST</b> line</span> </div>					
Ground Level Elev. <b>3967</b>	Producing Formation <b>SAN ANDRES</b>		Pool <b>WEST SAWYER SAN ANDRES</b>		Dedicated Acreage: <b>80</b> Acres

1. Outline the acreage dedicated to the subject well by colored pencil or hachure marks on the plat below.
2. If more than one lease is dedicated to the well, outline each and identify the ownership thereof (both as to working interest and royalty).
3. If more than one lease of different ownership is dedicated to the well, have the interests of all owners been consolidated by communitization, unitization, force-pooling, etc?

☐ Yes    ☐ No    If answer is "yes," type of consolidation \_\_\_\_\_

If answer is "no," list the owners and tract descriptions which have actually been consolidated. (Use reverse side of this form if necessary.) \_\_\_\_\_

No allowable will be assigned to the well until all interests have been consolidated (by communitization, unitization, forced-pooling, or otherwise) or until a non-standard unit, eliminating such interests, has been approved by the Commission.

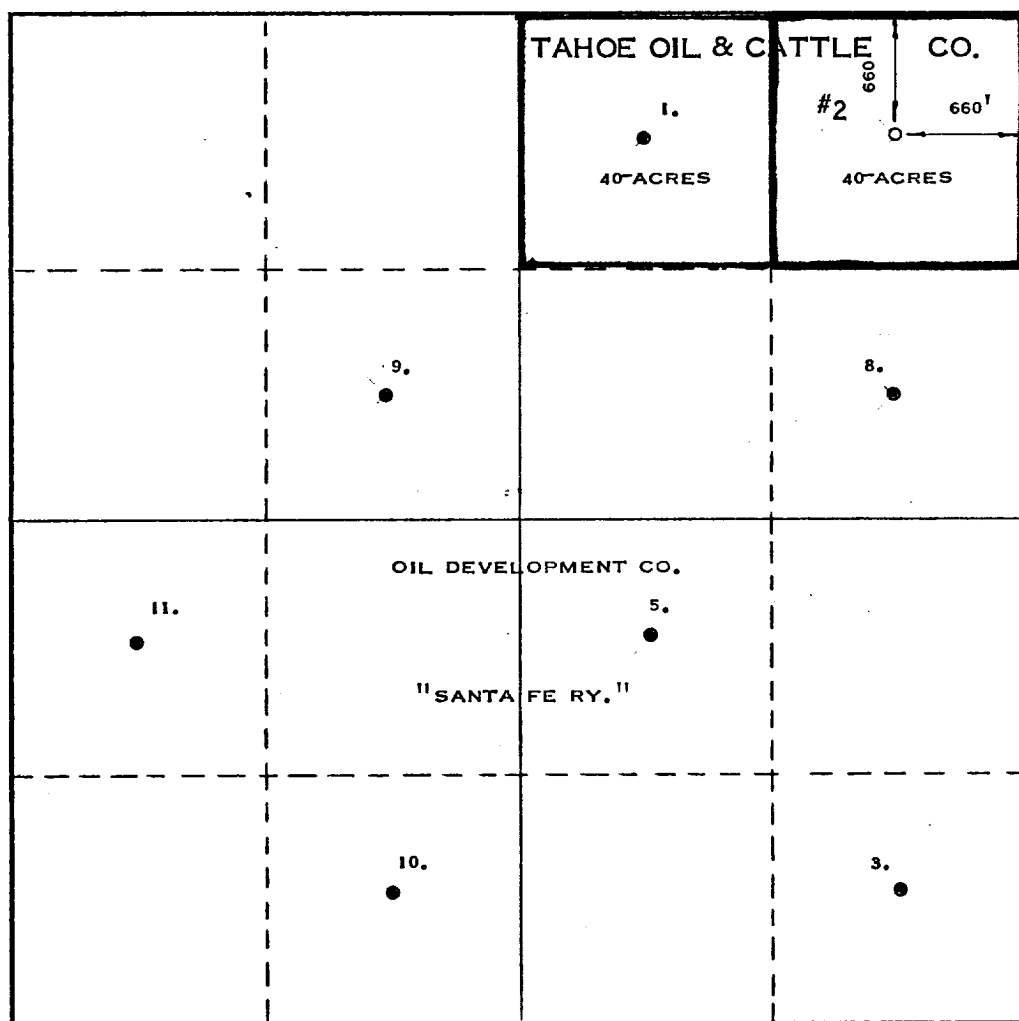

**CERTIFICATION**

I hereby certify that the information contained herein is true and complete to the best of my knowledge and belief.

Name *Max A. Schumann*  
 Position *Petroleum Engineer*  
 Company *Tahoe Oil & Cattle Co.*  
 Date *Sept. 2, 1976*

I hereby certify that the well location shown on this plat was plotted from field notes of actual surveys made by me or under my supervision, and that the same is true and correct to the best of my knowledge and belief.

Date Surveyed **SEPTEMBER 1, 1976**  
 Registered Professional Engineer and ☒ Land Surveyor

**MAX A SCHUMANN JR**

Certificate No. **1510**

RECEIVED

MAR 8 1977

OIL CONSERVATION COMM.  
HOBBS, N. M.

COUNTY	LEA	FIELD	Sawyer, W.	STATE NM	30-025-23650
OPR	D&B OIL, INC.			MAP	
	1 Arco				
	Sec 28, T-9-S, R-37-E			CO-ORD	
	660' FNL, 2180' FEL of Sec				
	Spd 12-9-70				
	Cmp 1-4-71		CLASS	EL	
	FORMATION	DATUM	FORMATION	DATUM	
CSG & SX - TUBING					
8 5/8" at 416' w/250 sx					
4 1/2" at 5036' w/375 sx					
LOGS EL GR RA IND HC A					
	TD 5040'; PBD 5020'				

TP (San Andres) Perfs 4920-92' F 120 BOPD. Pot based on 24 hr test thru 1/2" chk. GOR 600; Grav 20.5; CP 200#; TP 75#.

Distribution limited and publication prohibited by subscribers' agreement.  
Reproduction rights reserved by Williams & Lee Scouting Service, Inc.

CONT	Sitton & Norton	PROP DEPTH	5050'	TYPE	RT
DATE					

	F.R. 11-24-70; Opr's Elev. 3968' GL
	PD 5050' RT (San Andres)
	Contractor - Sitton & Norton
12-14-70	Drlg. 4591'
12-21-70	TD 5040'; WOC
1-4-71	TD 5040'; PBD 5020'; Bldg Tanks
	Perf @ 4920', 4928', 4936', 4938', 4946', 4964',
	4968', 4976', 4982', 4984', 4990', 4992' w/2 SP1
	Acid (4920-92') 9000 gals
1-11-71	TD 5040'; PBD 5020'; WO Potential
1-18-71	TD 5040'; PBD 5020'; COMPLETE
	LOG TOPS: Rustler 2286', Yates 2882',
	San Andres 4274'
1-21-71	COMPLETION REPORTED