

COUNTY TEA

FIELD

Bagley, W.

STATE NM 30-020-2455

OPR MEADCO PROPERTIES, LTD.

MAP

1 Warren American - State

Sec 27, T-11-S, R-33-E

CO-ORD

660' FSL, 510' FWL of Sec

Spd 12-11-70

Cmp 1-25-71

CSG & SX - TUBING	FORMATION		CLASS	
	FORMATION	DATUM	FORMATION	DATUM
12 3/4" at 400' w/375 SX				
8 5/8" at 3740' w/500 SX				
4 1/2" at 10,065' w/400 SX				

LOGS EL GR RA IND HC A

TD 10,065'

IP (Pennsylvanian) Perf's 9277-10,001' 424 BOPD + 800 gal/hr  
 based on 24 hr test thru 30/64" chk. GR 1400; CR 40.8;  
 Pkr; T 493#.

Distribution limited and publication prohibited by subscribers' agreement.  
 Reproduction rights reserved by Williams & Lee Sealing Service, Inc.

CONT MORE

DATE

PROP DEPTH 10,000' TYPE

F.R. 12-15-70; Opr's Elev. 4239' CL  
 TD 10,000' RI (Pennsylvanian)  
 Contractor - Moran  
 Brlg. 2447' anhy & sd  
 Brlg. 5265' 1m  
 Brlg. 9335' 1m  
 TD 10,065'; WOC  
 TD 10,065'; Prep Perf  
 TD 10,065'; Prep Acid (9277-9326')  
 Perf (Penn) 9277-9326', 9388-9462', 9674-80',  
 9819-44', 9862-82', 9892-96', 9931-10', 9998-  
 10,001' w/1 SFE  
 Acid (9998-10,001') 500 gals  
 Plwd 41 BF (75% oil) in 3 hrs (9998-10,001')  
 Acid (9931-50') 500 gals

26-71

Continued

Acid (9674-80') 500 gals  
Flwd 150 BO + 150 BLSAW in 12 hrs, TP 2000'  
(9674-80')

2-1-71

Acid (9388-9462') 1500 gals

TD 10,065'; COMPLETE

Acid (9277-9326') 1000 gals

Flwd 147 BO + 900 BW in 24 hrs thro 35/64" chk.

TP 240# (9277-10,001')

Acid (9277-9326') 1000 gals

LOG TOPS: Anhydrite 1490', Yates 2450',

San Andres 3725', Glorieta 5120', Tubb 6433',

Abo 7510', Wolfcamp 8420', Bough "B" 8942',

2-1-71

Continued

Sanyon 9270', Strawn 9790'

2-4-71

COMPLETION REPORTED

NEW MEXICO OIL CONSERVATION COMMISSION  
WELL LOCATION AND ACREAGE DEDICATION PLAT

Form C-102  
Revised C-128  
Effective 1-1-65

All distances must be from the outer boundaries of the Section

Operator <b>MEADCO PROPERTIES, LTD.</b>			Lease <b>WARREN AMERICAN STATE COM</b>		Well No. <b>1</b>
Unit Letter <b>M</b>	Section <b>27</b>	Township <b>11 SOUTH</b>	Range <b>33 EAST</b>	County <b>LEA</b>	
Actual Footage Location of Well: <b>660</b> feet from the <b>SOUTH</b> line and <b>510</b> feet from the <b>WEST</b> line					
Ground Level Elev. <b>4259.2</b>	Producing Formation <b>Pennsylvanian</b>		Pool <b>North Bagley Penn</b>		Dedicated Acreage: <b>80</b> Acres

1. Outline the acreage dedicated to the subject well by colored pencil or hachure marks on the plat below.
2. If more than one lease is dedicated to the well, outline each and identify the ownership thereof (both as to working interest and royalty).
3. If more than one lease of different ownership is dedicated to the well, have the interests of all owners been consolidated by communitization, unitization, force-pooling, etc?

☒ Yes ☐ No If answer is "yes," type of consolidation communitization

If answer is "no," list the owners and tract descriptions which have actually been consolidated. (Use reverse side of this form if necessary.)

No allowable will be assigned to the well until all interests have been consolidated (by communitization, unitization, forced-pooling, or otherwise) or until a non-standard unit, eliminating such interests, has been approved by the Commission.

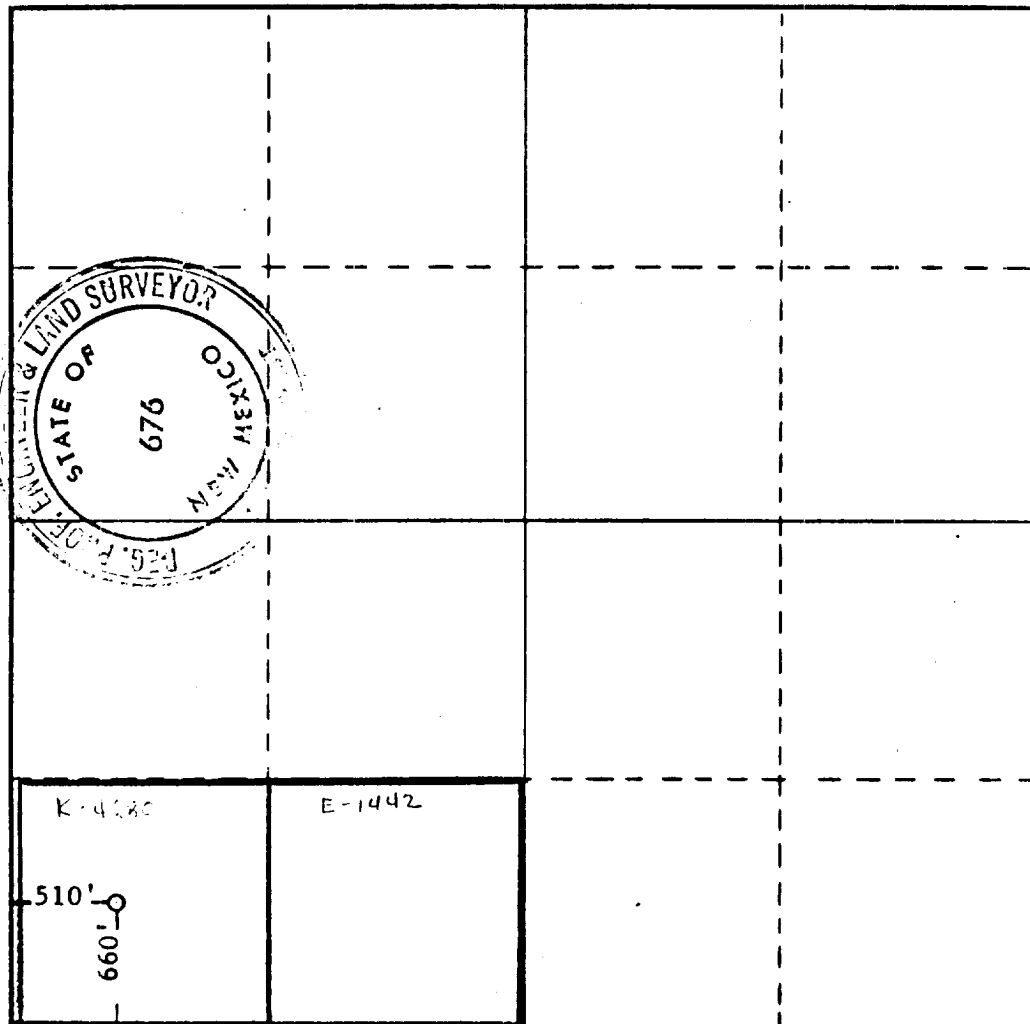

CERTIFICATION

I hereby certify that the information contained herein is true and complete to the best of my knowledge and belief.

*Bill C. Cotner*

Name  
**Bill C. Cotner, Owner**

Position  
**Meadco Properties, Ltd.**

Company  
**February 1, 1971**

Date

I hereby certify that the well location shown on this plat was plotted from field notes of actual surveys made by me or under my supervision, and that the same is true and correct to the best of my knowledge and belief.

Date Surveyed  
**12-2-1970**

Registered Professional Engineer and/or Land Surveyor

*John W. West*  
Certificate No. **676**

RECEIVED

FEB 21 1971

OIL CONSERVATION COMM.  
WASH. D. C.