

UNITED STATES
DEPARTMENT OF THE INTERIOR
GEOLOGICAL SURVEY

APPLICATION FOR PERMIT TO DRILL, DEEPEN, OR PLUG BACK

1a. TYPE OF WORK
 DRILL ☒ DEEPEN ☐ PLUG BACK ☐

b. TYPE OF WELL
 OIL WELL ☒ GAS WELL ☐ OTHER ☐ SINGLE ZONE ☒ MULTIPLE ZONE ☐

2. NAME OF OPERATOR
Coastal States Gas Producing Company

3. ADDRESS OF OPERATOR
P. O. Box 235, Midland, Texas 79701

4. LOCATION OF WELL (Report location clearly and in accordance with any State requirements.*)
 At surface
660' FS&EL of Sec. 24
 At proposed prod. zone

14. DISTANCE IN MILES AND DIRECTION FROM NEAREST TOWN OR POST OFFICE*
4 miles east of Crossroads, New Mexico

10. DISTANCE FROM PROPOSED*
 LOCATION TO NEAREST
 PROPERTY OR LEASE LINE, FT.
 (Also to nearest drlg. unit line, if any) **660'**

16. NO. OF ACRES IN LEASE
360

17. NO. OF ACRES ASSIGNED
 TO THIS WELL
40

18. DISTANCE FROM PROPOSED LOCATION*
 TO NEAREST WELL, DRILLING, COMPLETED,
 OR APPLIED FOR, ON THIS LEASE, FT. **--**

19. PROPOSED DEPTH
10,000

20. ROTARY OR CABLE TOOLS
Rotary

21. ELEVATIONS (Show whether DF, RT, GR, etc.)
4077.5 GR

22. APPROX. DATE WORK WILL START*
12-13-70

12. COUNTY OR PARISH **Lea** 13. STATE **New Mexico**

5. LEASE DESIGNATION AND SERIAL NO.
N-7-0257673

6. IF INDIAN, ALLOTTEE OR TRIBE NAME
--

7. UNIT AGREEMENT NAME
--

8. FARM OR LEASE NAME
Federal "24"

9. WELL NO.
1

10. FIELD AND POOL, OR WILDCAT
Wildcat

11. SEC., T., R., M., OR BLK.
 AND SURVEY OR AREA
Sec. 24, T-9-S, R-35-E

PROPOSED CASING AND CEMENTING PROGRAM				
SIZE OF HOLE	SIZE OF CASING	WEIGHT PER FOOT	SETTING DEPTH	QUANTITY OF CEMENT
17-1/2	13-3/8	48	400	350 APPROXIMATE
11	8-5/8	24 & 32	4,150	300
7-7/8	5-1/2	17	10,000	200

To perforate and treat as necessary

IN ABOVE SPACE DESCRIBE PROPOSED PROGRAM: If proposal is to deepen or plug back, give data on present productive zone and proposed new productive zone. If proposal is to drill or deepen directionally, give pertinent data on subsurface locations and measured and true vertical depths. Give blowout preventer program, if any.

24. SIGNED *J. R. Brown* TITLE Division Production Manager DATE December 10, 1970
 (This space for Federal or State office use)

PERMIT NO. _____ APPROVAL DATE _____
 APPROVED BY _____ TITLE _____
 CONDITIONS OF APPROVAL, IF ANY:

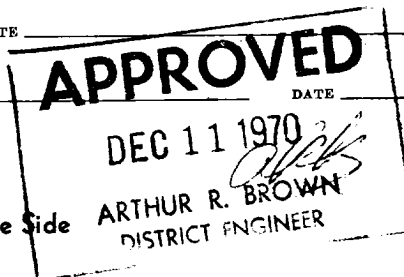

*See Instructions On Reverse Side

Instructions

General: This form is designed for submitting proposals to perform certain well operations, as indicated, on all types of lands and leases for appropriate action by either a Federal or a State agency, or both, pursuant to applicable Federal and/or State laws and regulations. Any necessary special instructions concerning the use of this form and the number of copies to be submitted, particularly with regard to local, area, or regional procedures and practices, either are shown below or will be issued by, or may be obtained from, the local Federal and/or State office.

Item 1: If the proposal is to redrill to the same reservoir at a different subsurface location or to a new reservoir, use this form with appropriate notations. Consult applicable State or Federal regulations concerning subsequent work proposals or reports on the well.

Item 4: If there are no applicable State requirements, locations on Federal or Indian land should be described in accordance with Federal requirements. Consult local State or Federal office for specific instructions.

Item 14: Needed only when location of well cannot readily be found by road from the land or lease description. A plat, or plats, separate or on this reverse side, showing the roads to, and the surveyed location of, the well, and any other required information, should be furnished when required by Federal or State agency offices.

Items 15 and 18: If well is to be, or has been directionally drilled, give distances for subsurface location of hole in any present or objective production zone.

Item 22: Consult applicable Federal or State regulations, or appropriate officials, concerning approval of the proposal before operations are started.

☆ U.S. GOVERNMENT PRINTING OFFICE : 1963-O-711-398

RECEIVED
OCT 10 1970
OIL CONSERVATION COMM.
PO BOX 1000

**NEW MEXICO OIL CONSERVATION COMMISSION
WELL LOCATION AND ACREAGE DEDICATION PLAT**

Form C-102
Supersedes C-128
Effective 1-1-65

All distances must be from the outer boundaries of the Section.

Operator COASTAL STATES GAS PRODUCING CO.			Lease FEDERAL 24		Well No. 1
Unit Letter P	Section 24	Township 9 SOUTH	Range 35 EAST	County LEA	
Actual Footage Location of Well: 660 feet from the SOUTH line and 660 feet from the EAST line					
Ground Level Elev. 4077.5	Producing Formation Pennsylvanian		Pool Wildcat		Dedicated Acreage: 40 Acres

1. Outline the acreage dedicated to the subject well by colored pencil or hachure marks on the plat below.
2. If more than one lease is dedicated to the well, outline each and identify the ownership thereof (both as to working interest and royalty).
3. If more than one lease of different ownership is dedicated to the well, have the interests of all owners been consolidated by communitization, unitization, force-pooling, etc?

☐ Yes ☐ No If answer is "yes," type of consolidation _____

If answer is "no," list the owners and tract descriptions which have actually been consolidated. (Use reverse side of this form if necessary.) _____

No allowable will be assigned to the well until all interests have been consolidated (by communitization, unitization, forced-pooling, or otherwise) or until a non-standard unit, eliminating such interests, has been approved by the Commission.

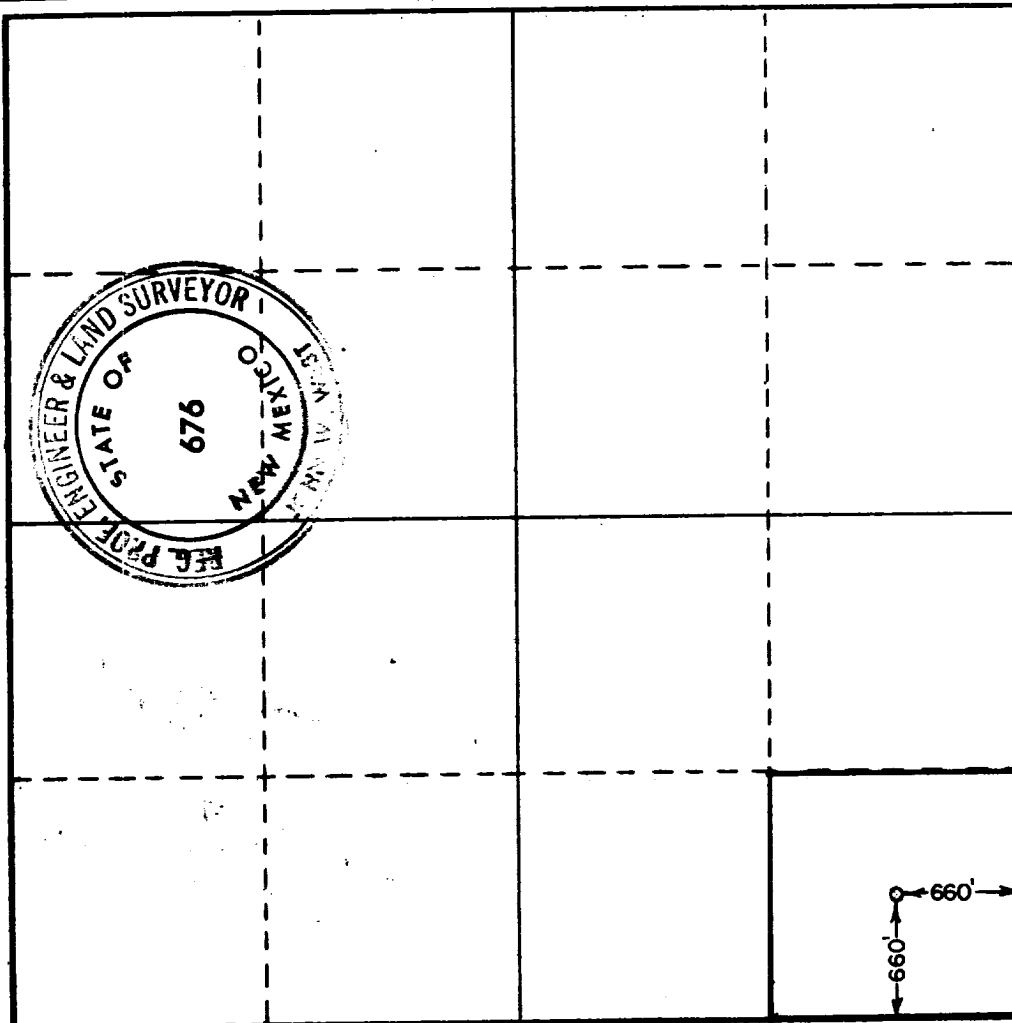

CERTIFICATION

I hereby certify that the information contained herein is true and complete to the best of my knowledge and belief.

Name
Joe R. Howard
Position
Division Production Manager
Company
Coastal States Gas Prod. Co.
Date
December 10, 1970

I hereby certify that the well location shown on this plat was plotted from field notes of actual surveys made by me or under my supervision, and that the same is true and correct to the best of my knowledge and belief.

Date Surveyed
DECEMBER 5, 1970
Registered Professional Engineer and/or Land Surveyor

Certificate No. **676**

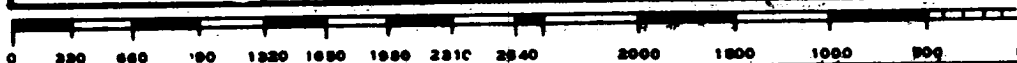

RECEIVED

11 1970

UN. CONSERVATION COMM.
NO. 100-100