

| | | |
|------------------------|--|--|
| NO. OF COPIES RECEIVED | | |
| DISTRIBUTION | | |
| SANTA FE | | |
| FILE | | |
| U.S.G.S. | | |
| LAND OFFICE | | |
| OPERATOR | | |

NEW MEXICO OIL CONSERVATION COMMISSION

Form C-101
Revised 1-1-65 38-125-3913

| | |
|---|------------------------------|
| 5A. Indicate Type of Lease | |
| STATE <input checked="" type="checkbox"/> | FEE <input type="checkbox"/> |
| 5. State Oil & Gas Lease No. | |
| L-188 | |

APPLICATION FOR PERMIT TO DRILL, DEEPEN, OR PLUG BACK

| | | | | | |
|--|--|-------------------------------|--------------------------------|--|----------------------------------|
| 1a. Type of Work | | | 7. Unit Agreement Name | | |
| b. Type of Well OIL WELL <input checked="" type="checkbox"/> GAS WELL <input type="checkbox"/> OTHER <input type="checkbox"/> DRILL <input checked="" type="checkbox"/> DEEPEN <input type="checkbox"/> PLUG BACK <input type="checkbox"/> SINGLE ZONE <input checked="" type="checkbox"/> MULTIPLE ZONE <input type="checkbox"/> | | | 8. Farm or Lease Name | | |
| 2. Name of Operator | | | 9. Well No. | | |
| Tenneco Oil Company | | | 2 | | |
| 3. Address of Operator | | | 10. Field and Pool, or Wildcat | | |
| P. O. Box 1031, Midland, Texas 79701 | | | Flying "M" (Penn) | | |
| 4. Location of Well | | | 12. County | | |
| UNIT LETTER <u>B</u> LOCATED <u>660</u> FEET FROM THE <u>North</u> LINE | | | <u>Lea</u> | | |
| AND <u>1980</u> FEET FROM THE <u>East</u> LINE OF SEC. <u>9</u> TWP. <u>9S</u> RGE. <u>33E</u> NMPM | | | | | |
| 19. Proposed Depth | | | 19A. Formation | | 20. Rotary or C.T. |
| 9500' | | | Bough "C" | | Rotary |
| 21. Elevations (Show whether DE, RT, etc.) | | 21A. Kind & Status Plug. Bond | 21B. Drilling Contractor | | 22. Approx. Date Work will start |
| 4377' GR | | In Effect | Moran Oil Prod. & Drilling Co. | | When Approved |

23.

PROPOSED CASING AND CEMENT PROGRAM

| SIZE OF HOLE | SIZE OF CASING | WEIGHT PER FOOT | SETTING DEPTH | SACKS OF CEMENT | EST. TOP |
|--------------|----------------|-----------------|---------------|------------------|----------|
| 17-1/2" | 13-3/8" | 54.5# | 350' | Circ. to Surface | Surface |
| 11" | 8-5/8" | 32# | 3950' | Sufficient to | 1800' |
| 7-7/8" | 5-1/2" | 17# | 9500' | Sufficient to | 7400' |

Propose to drill 17-1/2" hole to 350' KDB. Run and circulate cement on 13-3/8" casing. Pressure test casing to 600 psi. WOC 24 hours, drill hole to approximately 3950' KDB and reduce hole size to 7-7/8" and drill to approximately 4650' KDB and test San Andres formation. Will then ream 7-7/8" hole to 11" and run 8-5/8" to 4650' or set 8-5/8" at 3950' KDB, and bring cement to 1800'. Pressure test to 1000 psi for 30 minutes. WOC 24 hours and drill 7-7/8" hole to approximately 9500' KDB. Run 5-1/2" casing and bring cement to 7400'. Test casing to 1000 psi and WOC 24 hours.

THE COMMISSION MUST BE NOTIFIED
24 HOURS PRIOR TO RUNNING 13 3/8
CASING.

APPROVAL VALID
FOR 90 DAYS UNLESS
DRILLING COMMENCED,

EXPIRES 8-5-71

IN ABOVE SPACE DESCRIBE PROPOSED PROGRAM: IF PROPOSAL IS TO DEEPEN OR PLUG BACK, GIVE DATA ON PRESENT PRODUCTIVE ZONE AND PROPOSED NEW PRODUCTIVE ZONE. GIVE BLOWOUT PREVENTER PROGRAM, IF ANY.

I hereby certify that the information above is true and complete to the best of my knowledge and belief.

Signed Carley Watkins Title Senior Prod. Clerk Date May 5, 1971

(This space for State Use)

APPROVED BY [Signature] TITLE SUPERVISOR DISTRICT DATE MAY 6 1971

CONDITIONS OF APPROVAL, IF ANY:

RECEIVED

MAY - 6 1971

**OIL CONSERVATION COMM.
HOBBS, N. M.**

**NEW MEXICO OIL CONSERVATION COMMISSION
WELL LOCATION AND ACREAGE DEDICATION PLAT**

Form C-102
Supersedes C-128
Effective 1-1-65

All distances must be from the outer boundaries of the Section.

| | | | | | |
|--|---|----------------------------|----------------------------------|----------------------|---------------------------------------|
| Operator TENNECO OIL COMPANY | | | Lease COASTAL-STATE | | Well No. 2 |
| Unit Letter B | Section 9 | Township 9 SOUTH | Range 33 EAST | County LEA | |
| Actual Footage Location of Well: | | | | | |
| 1980 | feet from the | EAST | line and | 660 | feet from the NORTH line |
| Ground Level Elev. 4377 | Producing Formation Bough "C" | | Pool Flying "M" (Penn) | | Dedicated Acreage: 40 Acres |

1. Outline the acreage dedicated to the subject well by colored pencil or hachure marks on the plat below.
2. If more than one lease is dedicated to the well, outline each and identify the ownership thereof (both as to working interest and royalty).
3. If more than one lease of different ownership is dedicated to the well, have the interests of all owners been consolidated by communitization, unitization, force-pooling, etc?

☐ Yes ☐ No If answer is "yes," type of consolidation _____

If answer is "no," list the owners and tract descriptions which have actually been consolidated. (Use reverse side of this form if necessary.) _____

No allowable will be assigned to the well until all interests have been consolidated (by communitization, unitization, forced-pooling, or otherwise) or until a non-standard unit, eliminating such interests, has been approved by the Commission.

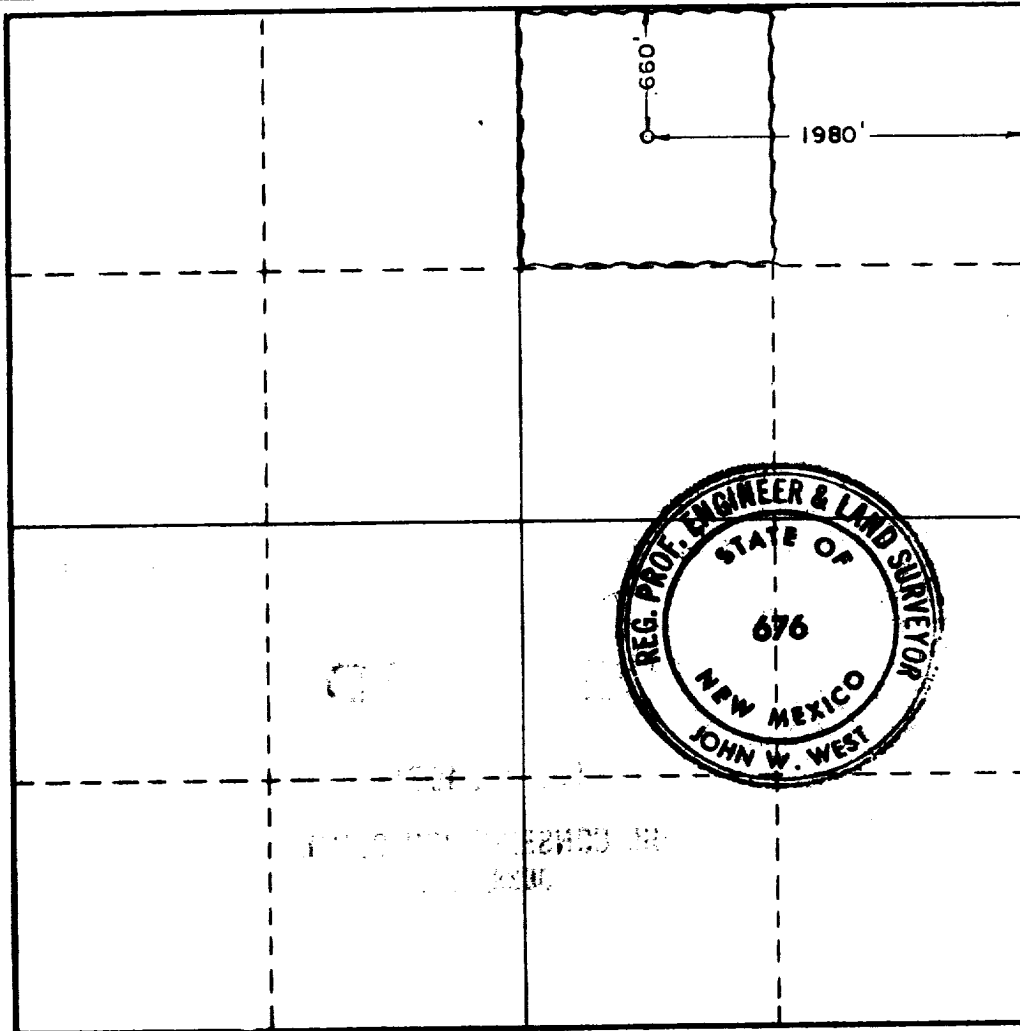

CERTIFICATION

I hereby certify that the information contained herein is true and complete to the best of my knowledge and belief.

Wm. J. Davis
Name
District Drilling Engineer
Position
Tenneco Oil Company
Company
April 5, 1971
Date

I hereby certify that the well location shown on this plat was plotted from field notes of actual surveys made by me or under my supervision, and that the same is true and correct to the best of my knowledge and belief.

Date Surveyed
4-30-1971

Registered Professional Engineer
and/or Land Surveyor

John W. West
Certificate No. **676**

0 330 660 990 1320 1650 1980 2310 2640 2970 3300 3630 3960 4290 4620 4950 5280 5610 5940 6270 6600

RECEIVED

MAY - 61971

OIL CONSERVATION COMM.
HOBBS, N. M.

173