

NO. OF COPIES RECEIVED	
DISTRIBUTION	
SANTA FE	
FILE	
U.S.G.S.	
LAND OFFICE	
OPERATOR	

NEW MEXICO OIL CONSERVATION COMMISSION

Form C-101
Revised 1-1-65

5A. Indicate Type of Lease STATE <input type="checkbox"/> FEE <input checked="" type="checkbox"/>
5. State Oil & Gas Lease No.
7. Unit Agreement Name
8. Farm or Lease Name Willis
9. Well No. 2
10. Field and Pool or Wildcat Vada Penn
12. County Lea
19. Proposed Depth 9800'
19A. Formation Bough "C"
20. Rotary or C.T. Rotary
21. Elevations (Show whether DF, RT, etc.) Gr 4267'
21A. Kind & Status Plug. Bond Statewide
21B. Drilling Contractor M-G-F
22. Approx. Date Work will start immediately

APPLICATION FOR PERMIT TO DRILL, DEEPEN, OR PLUG BACK

1a. Type of Work DRILL <input checked="" type="checkbox"/> DEEPEN <input type="checkbox"/> PLUG BACK <input type="checkbox"/>
b. Type of Well OIL WELL <input checked="" type="checkbox"/> GAS WELL <input type="checkbox"/> OTHER <input type="checkbox"/> SINGLE ZONE <input checked="" type="checkbox"/> MULTIPLE ZONE <input type="checkbox"/>
2. Name of Operator Delaware-Apache Corporation
3. Address of Operator 1720 Wilco Bldg. Midland, Texas 79701
4. Location of Well UNIT LETTER I LOCATED 1980 FEET FROM THE South LINE AND 660 FEET FROM THE East LINE OF SEC. 4 TWP. 9S RGE. 34E NMPM
19. Proposed Depth 9800'
19A. Formation Bough "C"
20. Rotary or C.T. Rotary
21. Elevations (Show whether DF, RT, etc.) Gr 4267'
21A. Kind & Status Plug. Bond Statewide
21B. Drilling Contractor M-G-F
22. Approx. Date Work will start immediately

23.

PROPOSED CASING AND CEMENT PROGRAM

SIZE OF HOLE	SIZE OF CASING	WEIGHT PER FOOT	SETTING DEPTH	SACKS OF CEMENT	EST. TOP
15"	11-3/4"	42#	385	300	Surface
11"	8-5/8"	24 & 32#	4000	400	400'
7-7/8"	5-1/2"	17#	9800	300	4000'

Surface, 900 Series, Double Ram, Hydraulic, 2000 Psi

Intermediate, 900 Series, Double Ram, Hydraulic, 3000 Psi

Please call COLLECT, approval to drill 915 683-5261

THE COMMISSION MUST BE NOTIFIED
24 HOURS PRIOR TO RUNNING
CASING.

APPROVAL VALID
FOR 90 DAYS UNLESS
DRILLING COMMENCED.
EXPIRES **8-7-71**

IN ABOVE SPACE DESCRIBE PROPOSED PROGRAM: IF PROPOSAL IS TO DEEPEN OR PLUG BACK, GIVE DATA ON PRESENT PRODUCTIVE ZONE AND PROPOSED NEW PRODUCTIVE ZONE. GIVE BLOWOUT PREVENTER PROGRAM, IF ANY.

I hereby certify that the information above is true and complete to the best of my knowledge and belief.

Signed Bonnie Husband Title Production Clerk Date May 6, 1971

(This space for State Use)

APPROVED BY [Signature] TITLE SUPERVISOR DISTRICT 1 DATE MAY 7 1971

CONDITIONS OF APPROVAL, IF ANY:

RECEIVED

MAY - 6 1971

OIL CONSERVATION COMM.
HOBBS, N. M.

**NEW MEXICO OIL CONSERVATION COMMISSION
WELL LOCATION AND ACREAGE DEDICATION PLAT**

Form C-102
Supersedes C-128
Effective 1-1-65

All distances must be from the outer boundaries of the Section.

Operator DELAWARE APACHE CORP.			Lease WILLIS		Well No. 2
Unit Letter I	Section 4	Township 9 SOUTH	Range 34 EAST	County LEA	
Actual Footage Location of Well: 1980 feet from the SOUTH line and 660 feet from the EAST line					
Ground Level Elev. 4267	Producing Formation Bough "C"		Pool Vada Penn		Dedicated Acreage: 160 Acres

1. Outline the acreage dedicated to the subject well by colored pencil or hachure marks on the plat below.
2. If more than one lease is dedicated to the well, outline each and identify the ownership thereof (both as to working interest and royalty).
3. If more than one lease of different ownership is dedicated to the well, have the interests of all owners been consolidated by communitization, unitization, force-pooling, etc?

☐ Yes ☐ No If answer is "yes," type of consolidation _____

If answer is "no," list the owners and tract descriptions which have actually been consolidated. (Use reverse side of this form if necessary.) _____

No allowable will be assigned to the well until all interests have been consolidated (by communitization, unitization, forced-pooling, or otherwise) or until a non-standard unit, eliminating such interests, has been approved by the Commission.

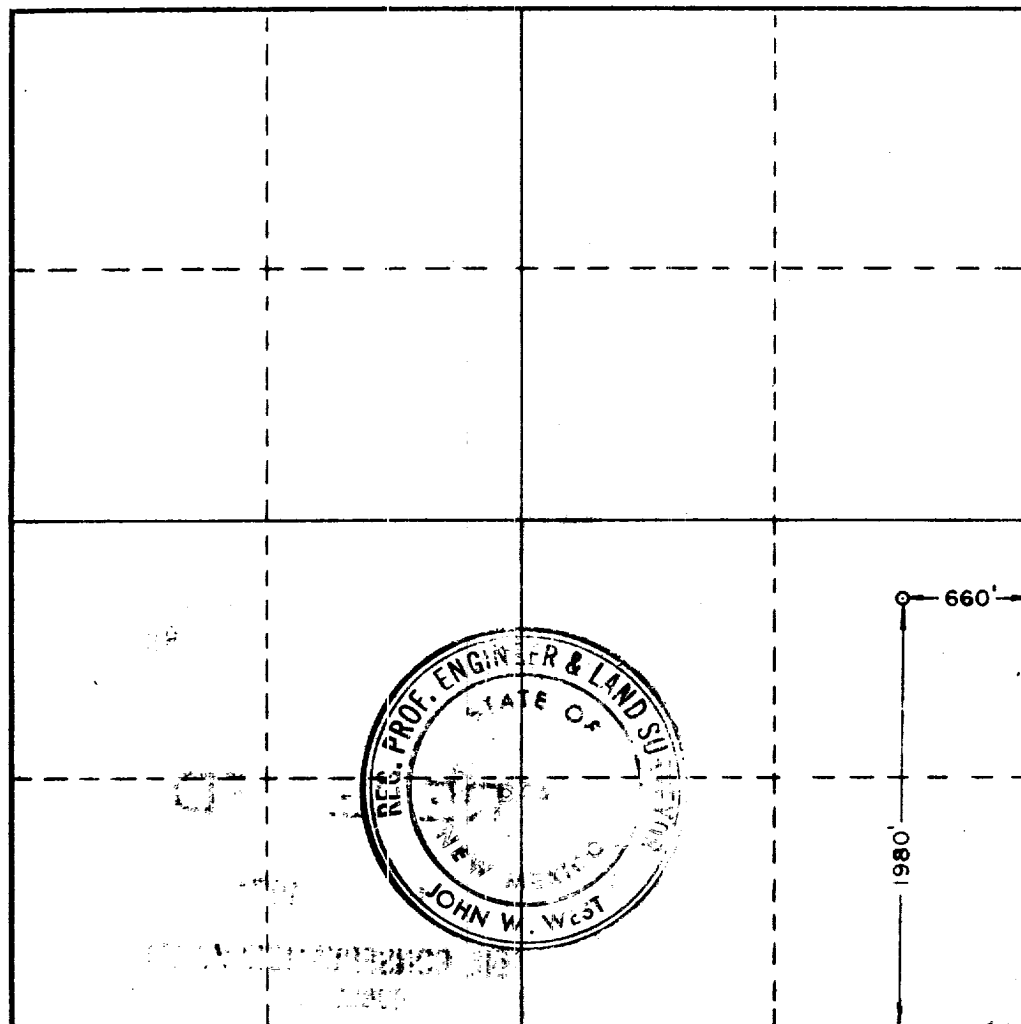

CERTIFICATION

I hereby certify that the information contained herein is true and complete to the best of my knowledge and belief.

Bonnie Husband
Name

Bonnie Husband
Position

Production Clerk
Company

Delaware-Apache Corp.
Date

May 6, 1971

I hereby certify that the well location shown on this plat was plotted from field notes of actual surveys made by me or under my supervision, and that the same is true and correct to the best of my knowledge and belief.

Date Surveyed
5-4-1971

Registered Professional Engineer
and/or Land Surveyor

John W. West
Certificate No.

676

173

RECEIVED

MAY - 6 1971

OIL CONSERVATION COMM.
MOBIL, INC.