

N. OF COPIES RECEIVED	
DISTRIBUTION	
SANTA FE	
FILE	
U.S.G.S.	
LAND OFFICE	
OPERATOR	

# NEW MEXICO OIL CONSERVATION COMMISSION

Form C-101  
Revised 1-1-65

5A. Indicate Type of Lease

STATE ☒ FEE ☐

5. State Oil & Gas Lease No.

K-1881

## APPLICATION FOR PERMIT TO DRILL, DEEPEN, OR PLUG BACK

1a. Type of Work		7. Unit Agreement Name	
b. Type of Well OIL WELL <input checked="" type="checkbox"/> GAS WELL <input type="checkbox"/> OTHER <input type="checkbox"/>		Sand Springs South Unit	
DRILL <input checked="" type="checkbox"/> DEEPEN <input type="checkbox"/> PLUG BACK <input type="checkbox"/>		8. Farm or Lease Name	
SINGLE ZONE <input checked="" type="checkbox"/> MULTIPLE ZONE <input type="checkbox"/>		Sand Springs South Unit	
2. Name of Operator		9. Well No.	
Tennessee Oil Company		1	
3. Address of Operator		10. Field and Pool, or Wildcat	
P.O. Box 1031, Midland, Texas		11-5-71	
4. Location of Well		12. County	
UNIT LETTER P LOCATED 990 FEET FROM THE East LINE		Lea	
AND 990 FEET FROM THE South LINE OF SEC. 30 TWP. 11S RGE. 35E NMPM			
19. Proposed Depth		19A. Formation	
10,300'		Bough "C"	
20. Rotary or C.T.		Rotary	
21. Elevations (Show whether DF, RT, etc.)		22. Approx. Date Work will start	
4128 GR		When Permit Approved	
21A. Kind & Status Plug. Bond			
Blanket			
21B. Drilling Contractor			
Unknown			

### PROPOSED CASING AND CEMENT PROGRAM

SIZE OF HOLE	SIZE OF CASING	WEIGHT PER FOOT	SETTING DEPTH	SACKS OF CEMENT	EST. TOP
17 1/2"	12 3/4"	50 #	350'	Sufficient to Circulate	
11"	8 3/8"	32 #	4150'	Sufficient to 1800' + (-)	
7 7/8"	5 1/2" Liner	17 #	10,300' + (-)	Sufficient to Approx 8200'	

Propose to drill 17 1/2" hole to 350' KDB. Run and circulate cement on 12 3/4" casing. Pressure test casing to 600 psi. WOC 12 hours, drill 11" hole to approximately 4150' KDB, and bring cement to 1800' ±. Pressure test to 1000 psi for 30 minutes. WOC 12 hours and drill 7 7/8" hole to approximately 10,300' ±. Run 5 1/2" casing liner and bring cement to approximately 8200'. Test casing to 1000 psi and WOC 24 hours.

11-5-71

12 3/4

IN ABOVE SPACE DESCRIBE PROPOSED PROGRAM: IF PROPOSAL IS TO DEEPEN OR PLUG BACK, GIVE DATA ON PRESENT PRODUCTIVE ZONE AND PROPOSED NEW PRODUCTIVE ZONE. GIVE BLOWOUT PREVENTER PROGRAM, IF ANY.

I hereby certify that the information above is true and complete to the best of my knowledge and belief.

Signed Carley Watkins Title Sr. Prod. Clerk Date August 2, 1971

(This space for State Use)

APPROVED BY [Signature] TITLE SUPERVISOR DISTRICT I DATE AUG 5 1971

CONDITIONS OF APPROVAL, IF ANY:

RECEIVED

AUG 11 1971

OIL CONSERVATION COMM.  
HOZES, H. L.

**NEW MEXICO OIL CONSERVATION COMMISSION  
WELL LOCATION AND ACREAGE DEDICATION PLAT**

Form C-102  
Supersedes C-128  
Effective 1-1-65

All distances must be from the outer boundaries of the Section.

Operator <b>TENNECO OIL CO.</b>			Lease <b>SANDS SPRINGS SOUTH UNIT</b>		Well No. <b>1</b>
Unit Letter <b>P</b>	Section <b>30</b>	Township <b>11 SOUTH</b>	Range <b>35 EAST</b>	County <b>LEA</b>	
Actual Footage Location of Well: <b>990</b> feet from the <b>EAST</b> line and <b>990</b> feet from the <b>SOUTH</b> line					
Ground Level Elev. <b>4138</b>	Producing Formation <b>Bough C</b>		Pool <b>Wildcat</b>	Dedicated Acreage: <b>40</b> <del>320</del> Acres	

1. Outline the acreage dedicated to the subject well by colored pencil or hatchure marks on the plat below.
2. If more than one lease is dedicated to the well, outline each and identify the ownership thereof (both as to working interest and royalty).
3. If more than one lease of different ownership is dedicated to the well, have the interests of all owners been consolidated by communitization, unitization, force-pooling, etc?

☒ Yes    ☐ No    If answer is "yes," type of consolidation Unitization

If answer is "no," list the owners and tract descriptions which have actually been consolidated. (Use reverse side of this form if necessary.) \_\_\_\_\_

No allowable will be assigned to the well until all interests have been consolidated (by communitization, unitization, forced-pooling, or otherwise) or until a non-standard unit, eliminating such interests, has been approved by the Commission.

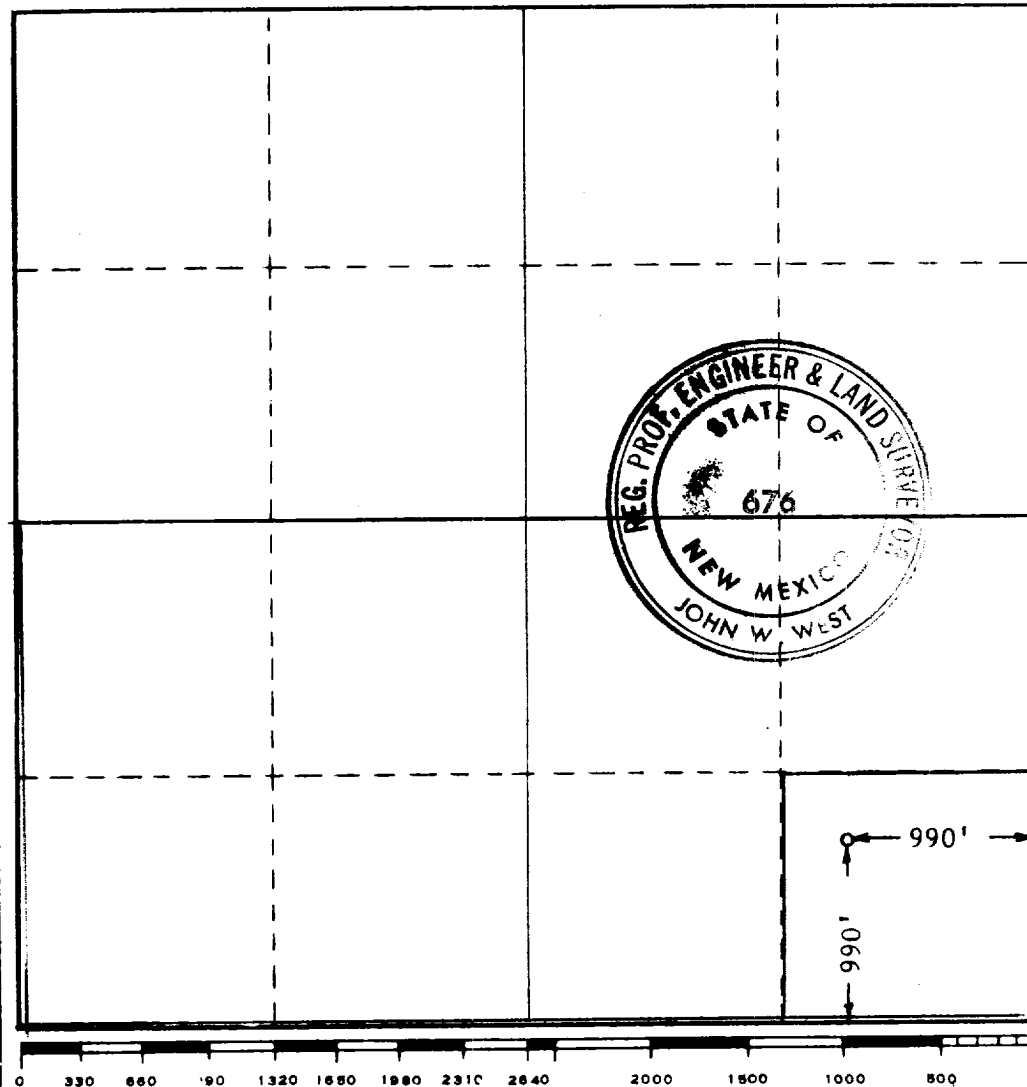

**CERTIFICATION**

I hereby certify that the information contained herein is true and complete to the best of my knowledge and belief.

Name Carley Watkins

Position Sr. Prod. Clerk

Company Tenneco Oil Company

Date 8/2/71

I hereby certify that the well location shown on this plat was plotted from field notes of actual surveys made by me or under my supervision, and that the same is true and correct to the best of my knowledge and belief.

Date Surveyed  
**JULY 23, 1971**

Registered Professional Engineer  
and/or Land Surveyor

John W. West  
Certificate No. **676**

413

RECEIVED

AUG 11 1971

OIL CONSERVATION COMM.  
HOBBES, N. L.