

NO. OF COPIES RECEIVED	
DISTRIBUTION	
SANTA FE	
FILE	
U.S.G.S.	
LAND OFFICE	
OPERATOR	

NEW MEXICO OIL CONSERVATION COMMISSION

Form C-101
Revised 1-1-65

5A. Indicate Type of Lease
STATE <input checked="" type="checkbox"/> FEE <input type="checkbox"/>
5. State Oil & Gas Lease No.
L-494

APPLICATION FOR PERMIT TO DRILL, DEEPEN, OR PLUG BACK

1a. Type of Work		7. Unit Agreement Name	
b. Type of Well DRILL <input checked="" type="checkbox"/> DEEPEN <input type="checkbox"/> PLUG BACK <input type="checkbox"/> OIL WELL <input checked="" type="checkbox"/> GAS WELL <input type="checkbox"/> OTHER <input type="checkbox"/> SINGLE ZONE <input type="checkbox"/> MULTIPLE ZONE <input type="checkbox"/>		8. Farm or Lease Name Midwest State	
2. Name of Operator Hanson Oil Corporation		9. Well No. 1	
3. Address of Operator P. O. Box 1515 - Roswell, New Mexico 88201		10. Field and Pool, or Wildcat Wildcat	
4. Location of Well UNIT LETTER <u>81</u> LOCATED <u>990</u> FEET FROM THE <u>South</u> LINE AND <u>990</u> FEET FROM THE <u>East</u> LINE OF SEC. <u>2</u> TWP. <u>9-S</u> RGE. <u>33-E</u> NMPM		12. County Lea	
19. Proposed Depth 9500'		19A. Formation Bough "C"	
20. Rotary or C.T. Rotary		21. Elevations (Show whether DF, RT, etc.) 4340 GL	
21A. Kind & Status Plug. Bond Statewide		21B. Drilling Contractor M-G-F Drilling Co.	
22. Approx. Date Work will start February 15, 1972			

PROPOSED CASING AND CEMENT PROGRAM

SIZE OF HOLE	SIZE OF CASING	WEIGHT PER FOOT	SETTING DEPTH	SACKS OF CEMENT	EST. TOP
17"	12-3/4"	34#	400'	400 sx.	Surface
11"	8-5/8"	24#, 28#, 32#	4650'	400 sx.	3000'
7-7/8"	5-1/2"	15.5# & 17#	9500'	600 sx.	7500'

We propose drilling the above referenced well with rotary tools to a total depth of 9500 feet to test the Bough "C" formation. The proposed casing and cement program will be followed. In the event that conditions encountered during drilling operations warrant, the potential producing zone will be perforated and stimulated as conditions dictate.

APPROVAL
BY
(PRINT NAME)
EXPIRES 5-10-72

12 3/4
CASH

IN ABOVE SPACE DESCRIBE PROPOSED PROGRAM: IF PROPOSAL IS TO DEEPEN OR PLUG BACK, GIVE DATA ON PRESENT PRODUCTIVE ZONE AND PROPOSED NEW PRODUCTIVE ZONE. GIVE BLOWOUT PREVENTER PROGRAM, IF ANY.

I hereby certify that the information above is true and complete to the best of my knowledge and belief.

Signed Gerald E. Harrington Title Geologist Date February 7, 1972

(This space for State Use)

APPROVED BY [Signature] TITLE SUPERVISOR, DISTRICT I DATE FEB 10 1972

CONDITIONS OF APPROVAL, IF ANY:

RECEIVED

FEB 9 1972

**OIL CONSERVATION COMM.
HOBBS, N. M.**

NEW MEXICO OIL CONSERVATION COMMISSION
WELL LOCATION AND ACREAGE DEDICATION PLAT

RECEIVED FEB 4 1972

Form C-102
Supersedes C-128
Effective 1-1-65

All distances must be from the outer boundaries of the Section.

Operator HANSON OIL CORP.		Lease MIDWEST STATE		Well No. 1
Unit Letter P	Section 2	Township 9 SOUTH	Range 33 EAST	County LEA
Actual Footage Location of Well: 990 feet from the SOUTH line and 990 feet from the EAST line				
Ground Level Elev. 4340⁰	Producing Formation	Pool Wildcat	Dedicated Acreage: 160 Acres	

1. Outline the acreage dedicated to the subject well by colored pencil or hachure marks on the plat below.
2. If more than one lease is dedicated to the well, outline each and identify the ownership thereof (both as to working interest and royalty).
3. If more than one lease of different ownership is dedicated to the well, have the interests of all owners been consolidated by communitization, unitization, force-pooling, etc?

☐ Yes ☐ No If answer is "yes," type of consolidation _____

If answer is "no," list the owners and tract descriptions which have actually been consolidated. (Use reverse side of this form if necessary.) _____

No allowable will be assigned to the well until all interests have been consolidated (by communitization, unitization, forced-pooling, or otherwise) or until a non-standard unit, eliminating such interests, has been approved by the Commission.

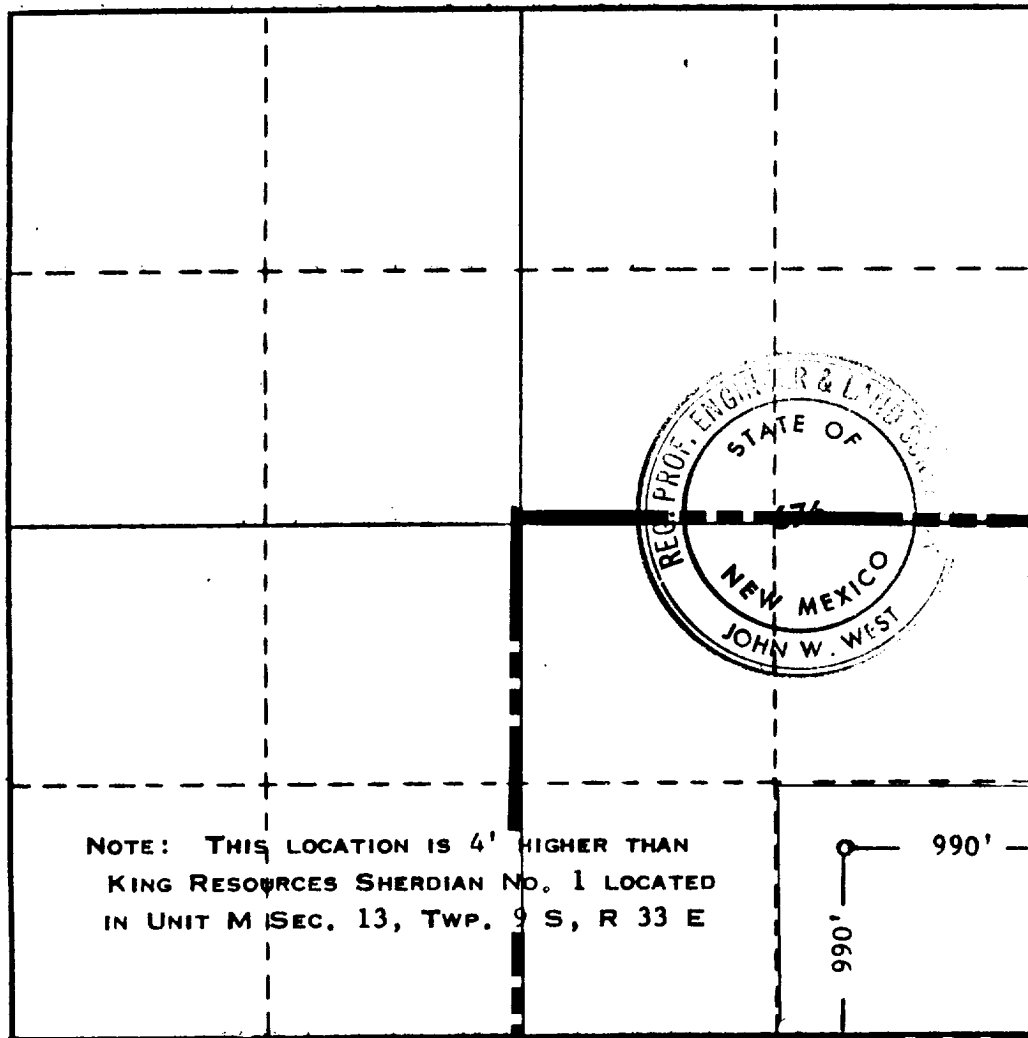

CERTIFICATION

I hereby certify that the information contained herein is true and complete to the best of my knowledge and belief.

Gerald E. Harrington
Name

Gerald E. Harrington

Position

Geologist

Company

Hanson Oil Corporation

Date

February 7, 1972

I hereby certify that the well location shown on this plat was plotted from field notes of actual surveys made by me or under my supervision, and that the same is true and correct to the best of my knowledge and belief.

Date Surveyed

JAN 29, 1972

Registered Professional Engineer and/or Land Surveyor

John W. West
Certificate No.

676

0 200 400 600 800 1000 1200 1400 1600 1800 2000 2200 2400 2600 2800 3000 3200 3400 3600 3800 4000

173

RECEIVED

FEB 1 1972

OIL CONSERVATION COMM.
HOBBS, N. M.