

NO. OF COPIES RECEIVED	
DISTRIBUTION	
SANTA FE	
FILE	
U.S.G.S.	
LAND OFFICE	
OPERATOR	

# NEW MEXICO OIL CONSERVATION COMMISSION

Form C-101  
Revised 1-1-65

5A. Indicate Type of Lease STATE <input type="checkbox"/> FEE <input checked="" type="checkbox"/>
5. State Oil & Gas Lease No. --
7. Unit Agreement Name --
8. Farm or Lease Name U. D. Sawyer
9. Well No. 8
10. Field and Pool, or Wildcat Crossroads Siluro Dev.
12. County Lea
19. Proposed Depth 12,100
19A. Formation Devonian
20. Rotary or C.T. Rotary
21. Elevations (Show whether DF, RT, etc.) GR. 4031.5
21A. Kind & Status Plug. Bond Blanket
21B. Drilling Contractor To be selected
22. Approx. Date Work will start 7-1-72

## APPLICATION FOR PERMIT TO DRILL, DEEPEN, OR PLUG BACK

1a. Type of Work b. Type of Well OIL WELL <input checked="" type="checkbox"/> GAS WELL <input type="checkbox"/> OTHER <input type="checkbox"/> SINGLE ZONE <input checked="" type="checkbox"/> MULTIPLE ZONE <input type="checkbox"/>	DRILL <input checked="" type="checkbox"/> DEEPEN <input type="checkbox"/> PLUG BACK <input type="checkbox"/>
2. Name of Operator Sun Oil Company	
3. Address of Operator P. O. Box 1861, Midland, Texas 79701	
4. Location of Well UNIT LETTER B LOCATED 2310 FEET FROM THE East LINE AND 990 FEET FROM THE North LINE OF SEC. 27 TWP. 9S RGE. 36E NMPM	
21. Elevations (Show whether DF, RT, etc.) GR. 4031.5	21A. Kind & Status Plug. Bond Blanket
21B. Drilling Contractor To be selected	22. Approx. Date Work will start 7-1-72

## PROPOSED CASING AND CEMENT PROGRAM

SIZE OF HOLE	SIZE OF CASING	WEIGHT PER FOOT	SETTING DEPTH	SACKS OF CEMENT	EST. TOP
17 1/2"	13-3/8	43#	260'	275	Surface (Circ)
12 1/4"	9-5/8	36#	4250'	1440	Surface (Circ)
8-3/4"	7"	23# & 26#	TD	250	10,100'

- Set 13-3/8" OD 48# H-40 casing at 260'. Circulate cement to surface. WOC 18 hrs. Test casing to 600# for 30 minutes.
- Set 9-5/8" OD 36# K-55 & H-40 casing at 4250'. Circulate cement to surface. WOC 13 hrs. Test casing to 1000# for 30 minutes.
- Drill 8-3/4" hole to TD.
- Run open hole Gamma Ray-Neutron Logs.
- Set 7" OD 26# S-95 & 23# N-80 casing at TD. Cement with sufficient cement to fill-up 2000' above shoe. WOC 36 hrs. Test casing to 1000# for 30 minutes.
- Perforate Devonian porosity.
- Set packer on 2-7/8" OD 6.5# C-75 tubing above perforations.
- Acidize perforations with 750 gals. Acid.
- Test - Anticipate flowing well.

(APPROVAL VALID FOR 90 DAYS UNLESS OTHERWISE SPECIFIED)

EXPIRES 9-26-72

BOVE SPACE DESCRIBE PROPOSED PROGRAM: IF PROPOSAL IS TO DEEPEN OR PLUG BACK, GIVE DATA ON PRESENT PRODUCTIVE ZONE AND PROPOSED NEW PRODUCTION. GIVE BLOWOUT PREVENTER PROGRAM, IF ANY.

certify that the information above is true and complete to the best of my knowledge and belief.

*Charles Gray* Title Proration Clerk Date 6-23-72  
(This space for State Use)  
*[Signature]* TITLE SUPERVISOR DISTRICT I DATE JUN 26 1972  
VAL, IF ANY:

RECEIVED

JUN 20 1972

OIL CONSERVATION COMM.  
HOBBS, N. M.

NEW MEXICO OIL CONSERVATION COMMISSION  
WELL LOCATION AND ACREAGE DEDICATION PLAT

Form O-122  
Supersedes O-120  
Effective 1-1-63

All distances must be from the outer boundaries of the Section.

Operator <b>SUN OIL COMPANY of Delaware</b>		Lessee <b>U. D. SAWYER</b>		Well No. <b>8</b>
Well No. <b>8</b>	Section <b>27</b>	Township <b>9 NORTH</b>	Range <b>36 EAST</b>	County <b>LEA</b>
Actual Surface Location of Well: <b>2310'</b> feet from the <b>EAST</b> line and <b>990'</b> feet from the <b>NORTH</b> line				
Ground Level Elev. <b>4031.5</b>	Producing Formation <b>Devonian</b>	Pool <b>Crossroads Siluca Devonian</b>	Dedicated Acreage <b>40</b> Acres	

1. Outline the acreage dedicated to the subject well by colored pencil or hatchure marks on the plat below.
2. If more than one lease is dedicated to the well, outline each and identify the ownership thereof (both as to working interest and royalty).
3. If more than one lease of different ownership is dedicated to the well, have the interests of all owners been consolidated by communitization, unitization, force-pooling, etc?

☐ Yes ☐ No If answer is "yes," type of consolidation \_\_\_\_\_

If answer is "no," list the owners and tract descriptions which have actually been consolidated. (Use reverse side of this form if necessary.) \_\_\_\_\_

No additional will be assigned to the well until all interests have been consolidated (by communitization, unitization, force-pooling, or otherwise) or until a non-standard unit, eliminating such interests, has been approved by the Commission.

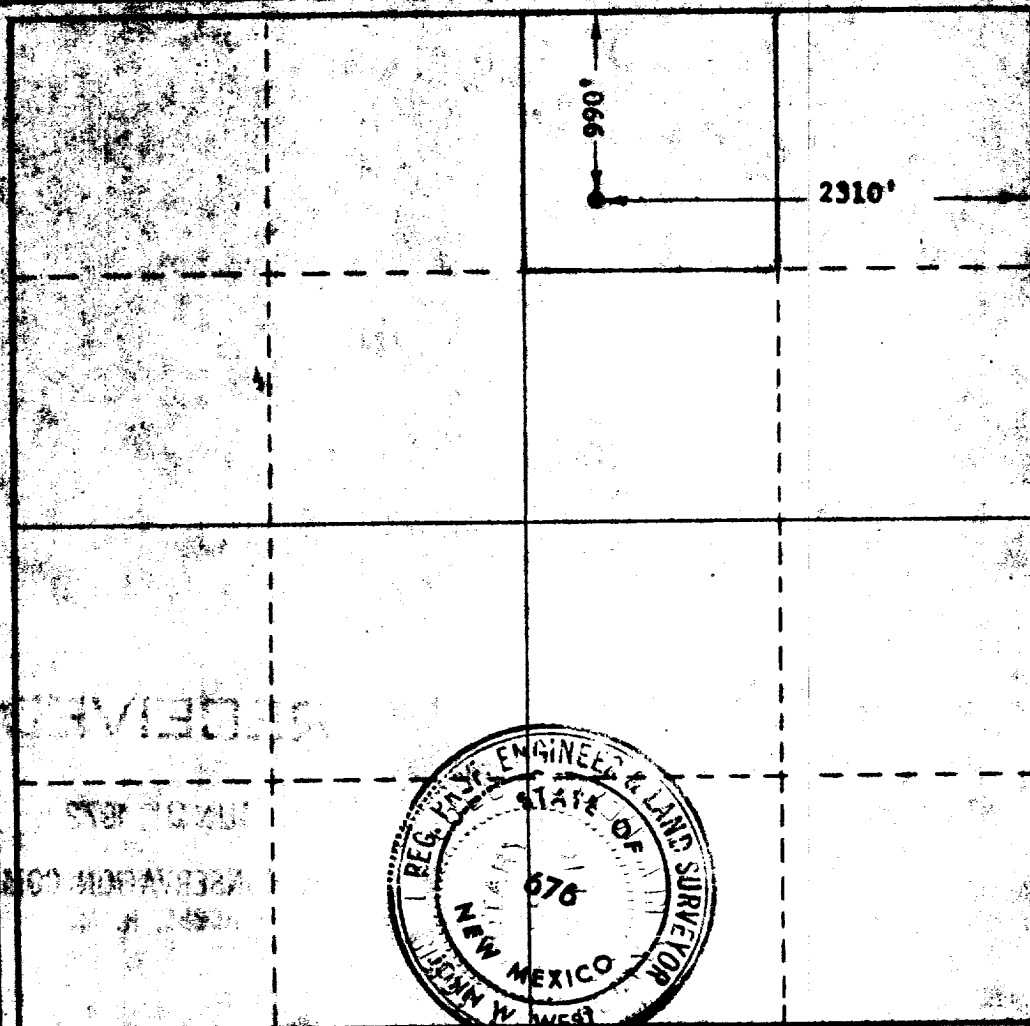

CERTIFICATION

I hereby certify that the information contained herein is true and correct to the best of my knowledge and belief.

Name *Charles J. Gray*  
Position **Proration Clerk**  
Company **Sun Oil Company of Delaware**  
Date **June 23, 1972**

I hereby certify that the well location shown on this plat was plotted from field notes of actual surveys made by me or under my supervision, and that the same is true and correct to the best of my knowledge and belief.

Date Surveyed **JUNE 22, 1972**  
Registered Professional Engineer and/or Land Surveyor  
*John W. Wheat*  
Certificate No. **676**

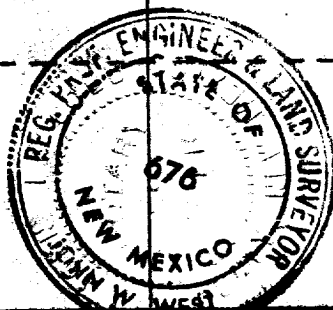

0 200 400 600 800 1000 1200 1400 1600 1800 2000 2200 2400 2600 2800 3000 3200 3400 3600 3800 4000

173

RECEIVED

JUN 26 1972

OIL CONSERVATION COMM.  
HOBBS, N. M.