

NO. OF COPIES RECEIVED	
DISTRIBUTION	
SANTA FE	
FILE	
U.S.G.S.	
LAND OFFICE	
OPERATOR	

NEW MEXICO OIL CONSERVATION COMMISSION

Form C-101
Revised 1-1-65

5A. Indicate Type of Lease
STATE ☐ FEE ☒

5. State Oil & Gas Lease No.

APPLICATION FOR PERMIT TO DRILL, DEEPEN, OR PLUG BACK

1a. Type of Work DRILL <input checked="" type="checkbox"/> DEEPEN <input type="checkbox"/> PLUG BACK <input type="checkbox"/>		7. Unit Agreement Name
b. Type of Well OIL WELL <input checked="" type="checkbox"/> GAS WELL <input type="checkbox"/> OTHER <input type="checkbox"/> SINGLE ZONE <input checked="" type="checkbox"/> MULTIPLE ZONE <input type="checkbox"/>		8. Farm or Lease Name Sheridan Unit
2. Name of Operator Apache Exploration Corporation		9. Well No. 1
3. Address of Operator P. O. Box 2299, Tulsa, Oklahoma 74101		10. UNDESIGNATED Vada Penn
4. Location of Well UNIT LETTER P LOCATED 660 FEET FROM THE South LINE AND 667 FEET FROM THE East LINE OF SEC. 12 TWP. 9S RGE. 34E NMPM		12. County Lea
19. Proposed Depth 9625'		19A. Formation Bough C
20. Rotary or C.T. Rotary		
21. Elevations (Show whether DF, RT, etc.) 4324.2	21A. Kind & Status Plug. Bond Statewide active	21B. Drilling Contractor M-G-F Drilling Co.
22. Approx. Date Work will start July 25, 1972		

23.

PROPOSED CASING AND CEMENT PROGRAM

SIZE OF HOLE	SIZE OF CASING	WEIGHT PER FOOT	SETTING DEPTH	SACKS OF CEMENT	EST. TOP
15"	11 3/4	42#	375	350	Surface
11"	8 5/8	24 & 32#	4000	375	3000
7 7/8"	5 1/2	17#	9625	400	7500

Operator will install double-ram blowout preventers rated at 3000# wp. 6000# test to assure proper well control at all times.

IN ABOVE SPACE DESCRIBE PROPOSED PROGRAM; IF PROPOSAL IS TO DEEPEN OR PLUG BACK, GIVE DATA ON PRESENT PRODUCTIVE ZONE AND PROPOSED NEW PRODUCTIVE ZONE. GIVE BLOWOUT PREVENTER PROGRAM, IF ANY.

I hereby certify that the information above is true and complete to the best of my knowledge and belief.

Signed Lloyd A. Somers Title Regional Production Manager Date July 14, 1972

(This space for State Use)

APPROVED BY [Signature] TITLE SUPERVISOR DISTRICT I DATE AUG 14 1972

CONDITIONS OF APPROVAL, IF ANY:

RECEIVED

JUL 10 1972

OIL CONSERVATION COMM.
HOBBES, K. M.

1 T 13 32

**NEW MEXICO OIL CONSERVATION COMMISSION
WELL LOCATION AND ACREAGE DEDICATION PLAT**

Form C-102
Supersedes C-128
Effective 1-4-65

All distances must be from the outer boundaries of the Section.

Operator APACHE EXPLORATION CORP.		Lease Sheridan		Well No. 1
Unit Letter P	Section 12	Township 9 SOUTH	Range 33 EAST	County LEA
Actual Footage Location of Well: 660 feet from the SOUTH line and 667 feet from the EAST line				
Ground Level Elev. 4324.2	Producing Formation Bough C	Pool Vada Penn	Dedicated Acreage 160 Acres	

1. Outline the acreage dedicated to the subject well by colored pencil or hachure marks on the plat below.
2. If more than one lease is dedicated to the well, outline each and identify the ownership thereof (both as to working interest and royalty).
3. If more than one lease of different ownership is dedicated to the well, have the interests of all owners been consolidated by communitization, unitization, force-pooling, etc?

☐ Yes ☐ No If answer is "yes," type of consolidation _____

If answer is "no," list the owners and tract descriptions which have actually been consolidated. (Use reverse side of this form if necessary.) _____

No allowable will be assigned to the well until all interests have been consolidated (by communitization, unitization, forced-pooling, or otherwise) or until a non-standard unit, eliminating such interests, has been approved by the Commission.

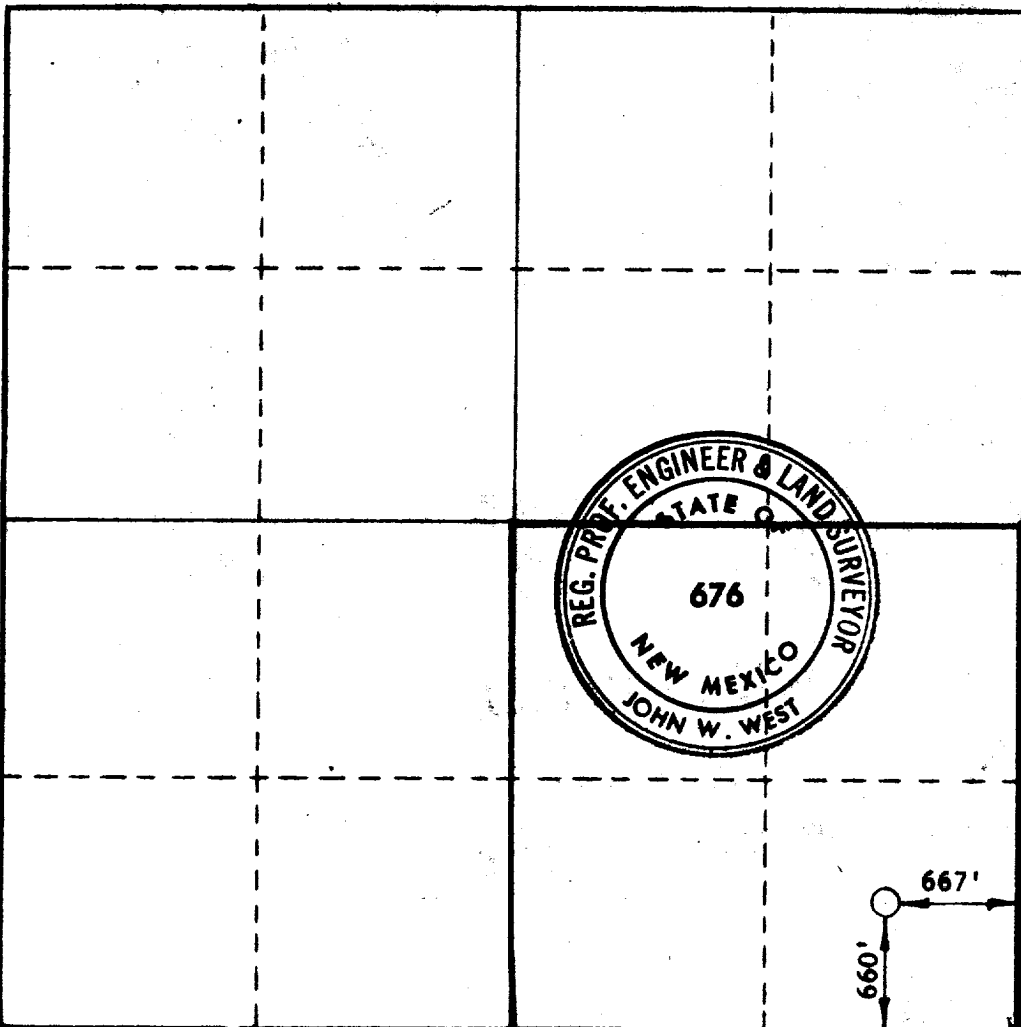

CERTIFICATION

I hereby certify that the information contained herein is true and complete to the best of my knowledge and belief.

Name *Raymond J. Somers*
Position
Regional Production Manager

Company
APACHE EXPLORATION CORPORATION

Date
July 14, 1972

I hereby certify that the well location shown on this plat was plotted from field notes of actual surveys made by me or under my supervision, and that the same is true and correct to the best of my knowledge and belief.

John W. West
Date Surveyed
JULY 13, 1972

Registered Professional Engineer and/or Land Surveyor

Certificate No. **676**

0 320 640 960 1280 1600 1920 2240 2560 2880 3200 3520 3840 4160 4480 4800 5120 5440 5760 6080 6400 6720 7040 7360 7680 8000 8320 8640 8960 9280 9600 9920 10240 10560 10880 11200 11520 11840 12160 12480 12800 13120 13440 13760 14080 14400 14720 15040 15360 15680 16000

173

RECEIVED

JUL 18 1972

OIL CONSERVATION COMM.
HOBBS, N. M.