

NEW MEXICO OIL CONSERVATION COMMISSION

Form O-101
Revised 1-1-65

FILE	
U.S.O.S.	
LAND OFFICE	
OPERATOR	

5A. Indicate type of Lease	
STATE <input checked="" type="checkbox"/>	FED. <input type="checkbox"/>
5. State or Federal Lease No.	
L-61	

APPLICATION FOR PERMIT TO DRILL, DEEPEN, OR PLUG BACK

1a. Type of Work		7. Unit Assignment Name	
b. Type of Well DRILL <input checked="" type="checkbox"/> DEEPEN <input type="checkbox"/> PLUG BACK <input type="checkbox"/> OIL WELL <input type="checkbox"/> GAS WELL <input type="checkbox"/> OTHER <input type="checkbox"/> SINGLE ZONE <input type="checkbox"/> MULTIPLE ZONE <input type="checkbox"/>		New Mexico State Lease L-61	
2. Name of Operator		8. Farm or Lease Name	
Victory Petroleum Company		New Mexico State Lease L-61	
3. Address of Operator		9. Well No.	
P. O. Box 36666 Houston, Texas 77036		1	
4. Location of Well		10. Field and Pool, or Wildcat	
UNIT LETTER B LOCATED 1980 FEET FROM THE East LINE AND 660 FEET FROM THE North LINE OF SEC. 6 TWP. 10S RGE. 33E N.M.P.M.		Mesquite	
		11. Rotary	
		Lea	
12. Proposed Depth		13A. Formation	
4,600'		San Andres	
13B. Drilling Contractor		13C. Rotary or C.T.	
Multiple Well in force.		Rotary	
14. Approx. Date Well will start		15. Approx. Date Well will start	
Approx. 4,200' GL		October 10, 1972	

PROPOSED CASING AND CEMENT PROGRAM

SIZE OF HOLE	SIZE OF CASING	WEIGHT PER FOOT	SETTING DEPTH	SACKS OF CEMENT	EST. TOP
12-1/4"	8-5/8"	24.0	350'	185	Surface of Ground
7-7/8"	5-1/2"	15.5	4600'	85	3500'

To drill to approximately 4600' and test, core and/or log selected intervals.
A double ram blowout preventer will be used after setting surface casing.

1-2-73

IN ABOVE SPACE DESCRIBE PROPOSED PROGRAM: IF PROPOSAL IS TO DEEPEN OR PLUG BACK, GIVE DATA ON PRESENT PRODUCTIVE ZONE AND PROPOSED NEW PRODUCTIVE ZONE. GIVE BLOWOUT PREVENTER PROGRAM, IF ANY.

I hereby certify that the information above is true and complete to the best of my knowledge and belief.

Signed R.B. Tull Title Production Manager Date September 22, 1972

(This space for State Use)

APPROVED BY [Signature] TITLE SECRETARY DATE October 1, 1972

CONDITIONS OF APPROVAL, IF ANY:

NEW MEXICO OIL CONSERVATION COMMISSION
WELL LOCATION AND ACREAGE DEDICATION PLAT

Form O-102
Supersedes O-128
Effective 1-1-75

All distances must be from the outer boundaries of the Section.

Operator Victory Petroleum Company		Lease New Mexico State Lease 1-05		Section 1
Unit Letter B	Section 6	Range 10S	Range 33E	County Lea
Actual Postage Location of Well 1980 feet from the East line 660 feet from the North line				
Ground Level Elev. Approx. 4200'	Proven Formation San Andres	Pool Consolidated	Dedicated Acreage 40 Acres	

1. Outline the acreage dedicated to the subject well by colored pencil or hachure marks on the plat below.
2. If more than one lease is dedicated to the well, outline each and identify the ownership thereof (both as to working interest and royalty).
3. If more than one lease of different ownership is dedicated to the well, have the interests of all owners been consolidated by communitization, unitization, force-pooling, etc?

☐ Yes ☐ No If answer is "yes," type of consolidation _____

If answer is "no," list the owners and tract descriptions which have actually been consolidated. (Use reverse side of this form if necessary.) _____

No allowable will be assigned to the well until all interests have been consolidated (by communitization, unitization, forced-pooling, or otherwise) or until a non-standard unit, eliminating such interests, has been approved by the Commission.

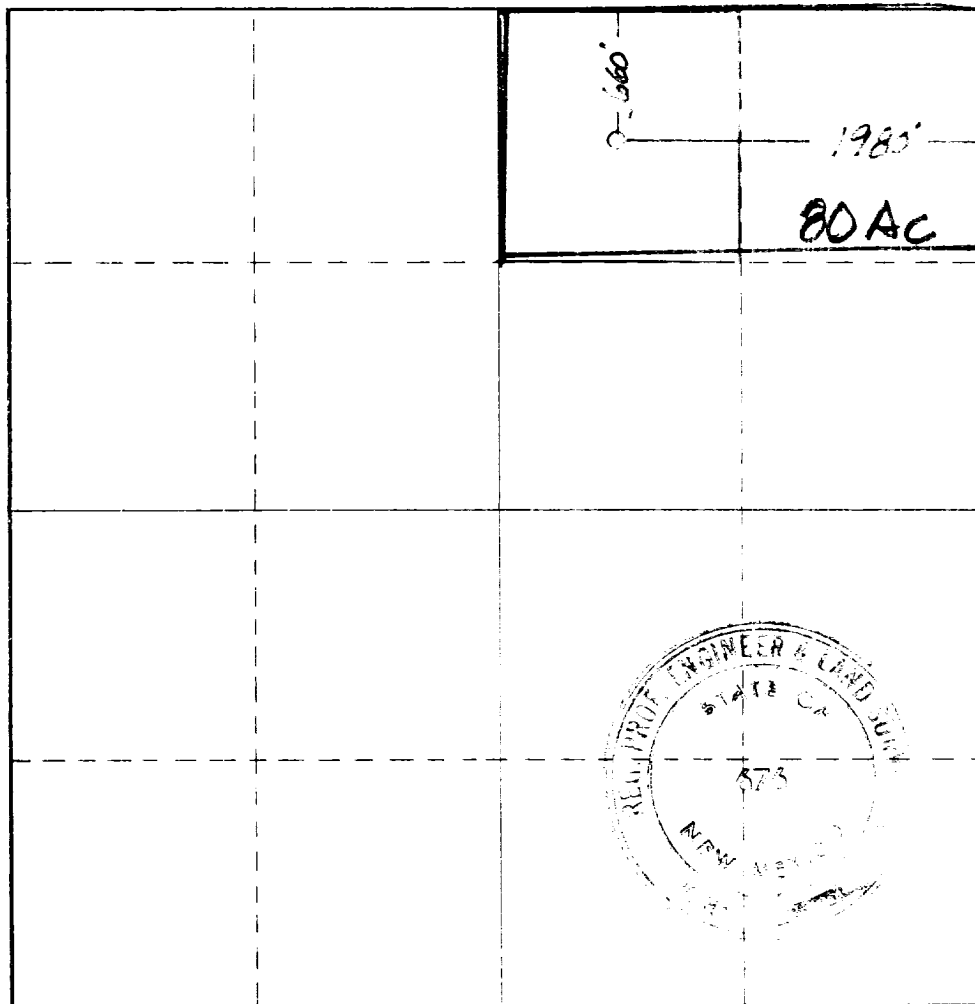

CERTIFICATION

I hereby certify that the information contained herein is true and complete to the best of my knowledge and belief.

Name
R. B. HUFF
Position
PRODUCTION MANAGER
Company
VICTORY PETROLEUM COMPANY
Date
September 22, 1972

I hereby certify that the well location shown on this plat was plotted from field notes of actual surveys made by me or under my supervision, and that the same is true and correct to the best of my knowledge and belief.

Date Surveyed
9-25-1972

Registered Professional Engineer and/or Land Surveyor

John W. West
Certificate No.
676