

UNITED STATES
DEPARTMENT OF THE INTERIOR
GEOLOGICAL SURVEY

5. LEASE DESIGNATION AND SERIAL NO.

NM- 0103893

APPLICATION FOR PERMIT TO DRILL, DEEPEN, OR PLUG BACK

1a. TYPE OF WORK

DRILL ☒DEEPEN ☐PLUG BACK ☐

b. TYPE OF WELL

OIL
WELL ☒GAS
WELL ☐

OTHER

SINGLE
ZONE ☐MULTIPLE
ZONE ☐

2. NAME OF OPERATOR

Flag-Redfern Oil Company

3. ADDRESS OF OPERATOR

P. O. Box 23 Midland, Texas 79701

4. LOCATION OF WELL (Report location clearly and in accordance with any State requirements.*)

At surface 660' FNL & 660' FWL of section 24, T-9-S, R-37-E

At proposed prod. zone

Same

14. DISTANCE IN MILES AND DIRECTION FROM NEAREST TOWN OR POST OFFICE*

15 miles east of Crossroads, New Mexico

10. DISTANCE FROM PROPOSED*

LOCATION TO NEAREST
PROPERTY OR LEASE LINE, FT.
(Also to nearest drlg. unit line, if any)

660'

16. NO. OF ACRES IN LEASE

40

17. NO. OF ACRES ASSIGNED
TO THIS WELL

40

18. DISTANCE FROM PROPOSED LOCATION*
TO NEAREST WELL, DRILLING, COMPLETED,
OR APPLIED FOR, ON THIS LEASE, FT.

None

19. PROPOSED DEPTH

20. ROTARY OR CABLE TOOLS

Rotary

21. ELEVATIONS (Show whether DF, RT, GR, etc.)

3978' Ground

22. APPROX. DATE WORK WILL START*

December 15, 1972

23.

PROPOSED CASING AND CEMENTING PROGRAM

SIZE OF HOLE	SIZE OF CASING	WEIGHT PER FOOT	SETTING DEPTH	QUANTITY OF CEMENT
12-1/4"	8 5/8"	24# J-55	400	250 sx - circulate
7 7/8"	4 1/2"	9.5# J-55	5100	250 sx -

Drill 12 1/4" hole from surface to approximately 400' - Run & set 8 5/8" casing, circulate cement to surface with 250 sx class H, 2% Cacl. Drill 7 7/8" hole to approximately 5100'. Run open hole logs. Run 4 1/2", 9.5 lb/ft., J-55 production casing. Cement with 250 sx Class C, 2% gel, 0.75% CFR-2, 8 lb salt per sack. Run correlation log. Perforate San Andres. Treat with acid. Swab to test. Potential well.

Mud Program - 0-4800 - Native Mud

4800 - TD - Salt Base Mud - Wt 10.3, Vis 38, WL 15cc

Blowout Preventor - Shaffer 10" - Series 900 - Installed on surface pipe.

IN ABOVE SPACE DESCRIBE PROPOSED PROGRAM: If proposal is to deepen or plug back, give data on present productive zone and proposed new productive zone. If proposal is to drill or deepen directionally, give pertinent data on subsurface locations and measured and true vertical depths. Give blowout preventer program, if any.

24.

SIGNED

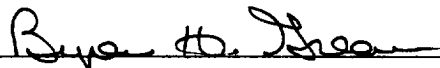

TITLE Production Manager

DATE

11-21-72

(This space for Federal or State office use)

PERMIT NO.

APPROVAL DATE

APPROVED BY

TITLE

DATE

CONDITIONS OF APPROVAL, IF ANY:

RECEIVED

DEC 1 1972

OIL CONSERVATION COMM.
HOBBS, N. M.



O I L C O M P A N Y

410 WALL TOWERS WEST • MIDLAND, TEXAS 79701

P. O. BOX 23 • PHONE (915) 683-5184

November 21, 1972

FILE:

U. S. Department of Interior
Geological Survey
Post Office Box 1157
Hobbs, New Mexico 88240

Attention: Mr. Arthur Brown

Gentlemen:

Re: Flag-Redfern Oil Company
Allied "93" #1
Section 24, 9S, 37E
Lea County, New Mexico

The following is the development plan for surface use as required to accompany application to drill the captioned well:

- 1) State Highway 125 from Tatum, New Mexico to Bledsoe, Texas crosses Section 24 one mile east of the captioned location. Existing caliche lease roads provide access across Section 24 to a point 660' north of the proposed location.
- 2) Access road to the captioned well will be a lateral to the existing roads for a distance of 660' south to the location.
- 3) Additional lateral roads in Section 24 will be required if development proceeds in this section.
- 4) The planned access road will be the only road into the lease and additional roads, if required, will be lateral from this road.
- 5) It is anticipated that the tank battery will be installed in the southeast corner of the drilling pad, the size and number of tanks and separator to be determined after the well is completed.

U. S. Department of Interior
November 21, 1972
Page two of two

- 6) There is no known supply of drilling water in the immediate area and we consequently plan to haul drilling water into this location.
- 7) All solid waste from the drilling operation will be either buried or hauled away.
- 8) Produced brine will be stored in tanks and trucked by Permian into an approved subsurface disposal zone.
- 9) Casinghead gas will be contracted to either Warren Petroleum Corporation or Cities Service Gas Company. Contracts will be requested of these companies immediately upon completion of the well.
- 10) Location layout and rig plan are detailed on the attached development plat.
- 11) Should this well be a dry hole, pits will be filled and the surface restored as near as possible to the original contours. Should this well produce, pits will be filled and leveled and the pad maintained during the life of production.

Please advise if we can furnish additional information that you might desire.

Yours very truly,

FLAG-REDFERN OIL COMPANY



Byron H. Greaves
Production Manager

BHG:elf

Attachment

DEVELOPMENT PLAN FOR

SURFACE USE

FLAG-REDFERN OIL COMPANY
SAWYER SAN ANDRES FIELD
LEA COUNTY, NEW MEXICO

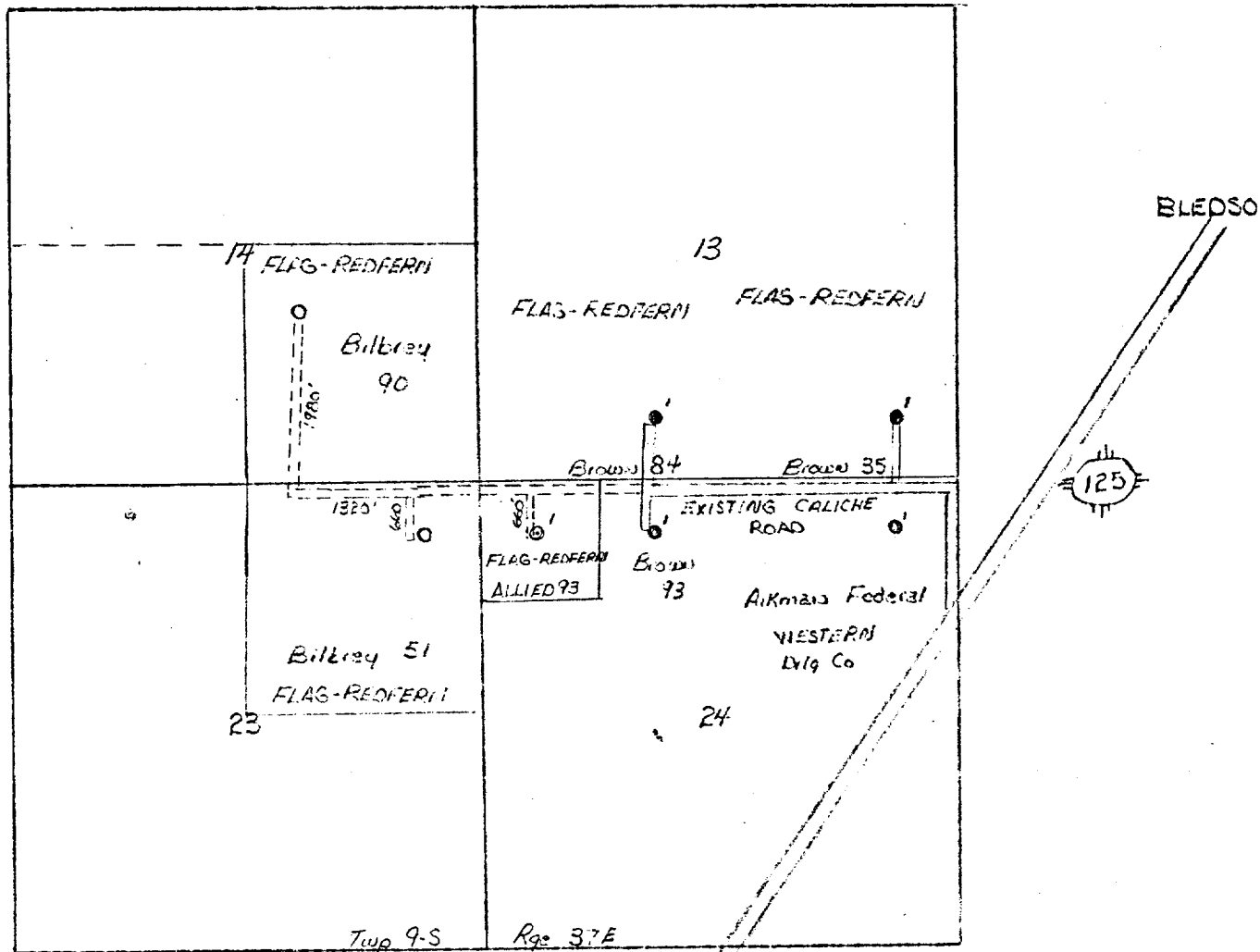

PAD DETAIL

TATUM

