

NO. OF COPIES RECEIVED		
DISTRIBUTION		
SANTA FE		
FILE		
U.S.G.S.		
LAND OFFICE		
OPERATOR		

NEW MEXICO OIL CONSERVATION COMMISSION

Form C-101
Revised 1-1-65

5A. Indicate Type of Lease

STATE ☒ FEE ☐

5. State Oil & Gas Lease No.
K-3135

APPLICATION FOR PERMIT TO DRILL, DEEPEN, OR PLUG BACK

1a. Type of Work			7. Unit Agreement Name		
b. Type of Well OIL WELL <input checked="" type="checkbox"/> GAS WELL <input type="checkbox"/> OTHER <input type="checkbox"/> DRILL <input checked="" type="checkbox"/> DEEPEN <input type="checkbox"/> PLUG BACK <input type="checkbox"/> SINGLE ZONE <input checked="" type="checkbox"/> MULTIPLE ZONE <input type="checkbox"/>			8. Farm or Lease Name LARIO STATE		
2. Name of Operator WIL MAC OIL CORP. <i>The Phil-Mac</i>			9. Well No. 1		
3. Address of Operator 607 FIDELITY UNION LIFE BLDG. DALLAS, TEXAS			10. Field and Pool, or Wildcat UNDEVELOPED		
4. Location of Well UNIT LETTER <u>C</u> LOCATED <u>660</u> FEET FROM THE <u>NORTH</u> LINE AND <u>1980</u> FEET FROM THE <u>WEST</u> LINE OF SEC. <u>12</u> TWP. <u>10 S</u> RGE. <u>36 E</u> NMPM			12. County LEA		
19. Proposed Depth <u>5000</u>			19A. Formation <u>San Andres</u>		20. Rotary or C.T. <u>Rot</u>
21. Elevations (Show whether DF, RT, etc.)		21A. Kind & Status Plug. Bond APPR'D BLANKET		22. Approx. Date Work will start MARCH 19, 1973	
21B. Drilling Contractor SITTON & NORTON DRLG. CO. LUBBOCK, TEXAS					

23.

PROPOSED CASING AND CEMENT PROGRAM

SIZE OF HOLE	SIZE OF CASING	WEIGHT PER FOOT	SETTING DEPTH	SACKS OF CEMENT	EST. TOP
12 3/4"	8 5/8"	20#	400'	200	CIRCULATE
7 7/8"	4 1/2"	9 1/2#	5000	5000	4400'

APPROVAL VALID
FOR 90 DAYS UNLESS
DRILLING COMMENCED,

EXPIRES 6-19-73

IN ABOVE SPACE DESCRIBE PROPOSED PROGRAM; IF PROPOSAL IS TO DEEPEN OR PLUG BACK, GIVE DATA ON PRESENT PRODUCTIVE ZONE AND PROPOSED NEW PRODUCTIVE ZONE, GIVE BLOWOUT PREVENTER PROGRAM, IF ANY.

I hereby certify that the information above is true and complete to the best of my knowledge and belief.

Signed JOHN W. WEST Title AGENT Date MARCH 16, 1973

(This space for State Use)

APPROVED BY [Signature] TITLE SUPERVISOR DISTRICT I DATE MAR 19 1973

CONDITIONS OF APPROVAL, IF ANY:

**NEW MEXICO OIL CONSERVATION COMMISSION
WELL LOCATION AND ACREAGE DEDICATION PLAT**

Form C-102
Supersedes C-128
Effective 1-1-65

All distances must be from the outer boundaries of the Section.

Operator WIL-MAC OIL CORP. <i>The Phil Mc</i>		Lease LARIO STATE		Well No. 1
Unit Letter C	Section 12	Township 10 SOUTH	Range 36 EAST	County LEA
Actual Footage Location of Well: 660 feet from the NORTH line and 1980 feet from the WEST line				
Ground Level Elev.	Producing Formation SAN ANDRES	Pool UNDESIGNATED WEST SAN ANDRES (UNITED)	Dedicated Acreage: 40 NE NW 1 80 Acres	

1. Outline the acreage dedicated to the subject well by colored pencil or hachure marks on the plat below.
2. If more than one lease is dedicated to the well, outline each and identify the ownership thereof (both as to working interest and royalty).
3. If more than one lease of different ownership is dedicated to the well, have the interests of all owners been consolidated by communitization, unitization, force-pooling, etc?

☐ Yes ☐ No If answer is "yes," type of consolidation _____

If answer is "no," list the owners and tract descriptions which have actually been consolidated. (Use reverse side of this form if necessary.) _____

No allowable will be assigned to the well until all interests have been consolidated (by communitization, unitization, forced-pooling, or otherwise) or until a non-standard unit, eliminating such interests, has been approved by the Commission.

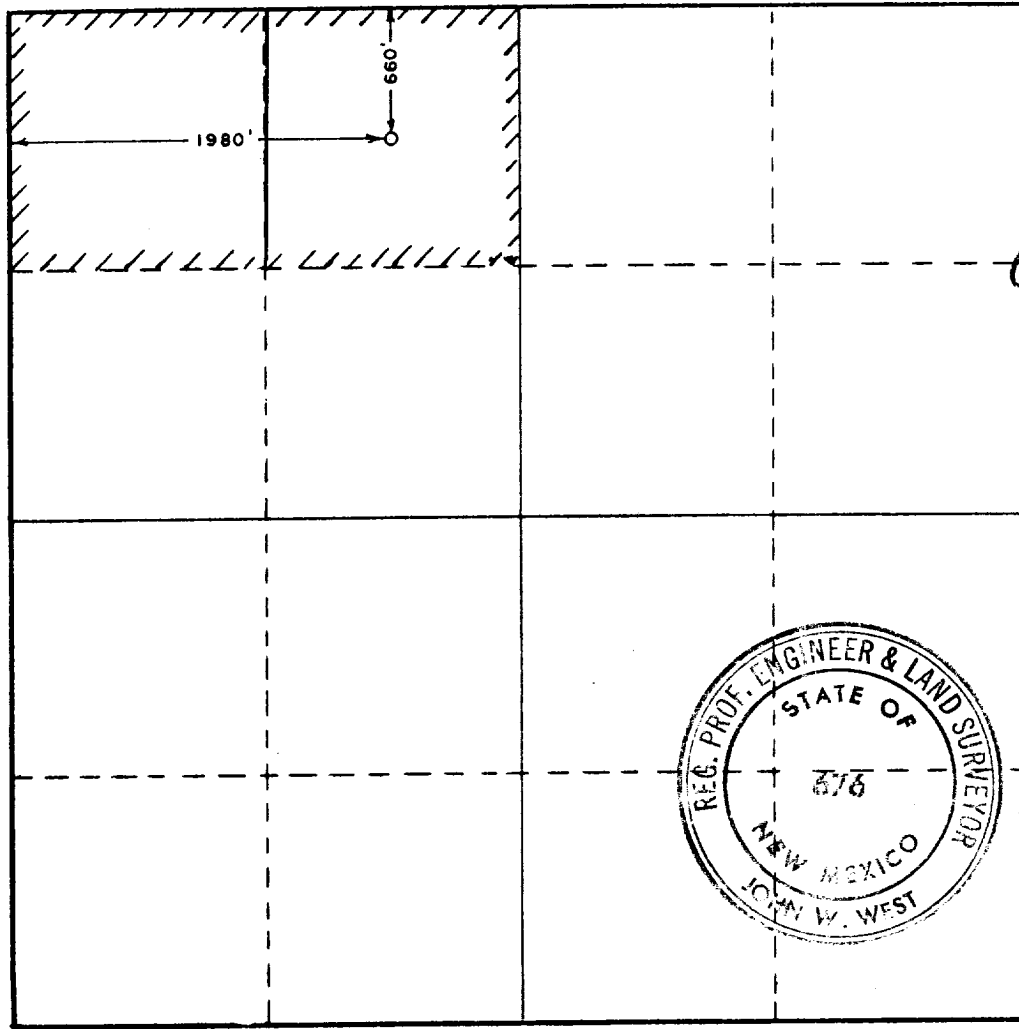

CERTIFICATION

I hereby certify that the information contained herein is true and complete to the best of my knowledge and belief.

John W. West
Name **JOHN W. WEST**
AGENT

Position **WIL-MAC OIL CORP.**

Company **MARCH 16, 1973**

Date

I hereby certify that the well location shown on this plat was plotted from field notes of actual surveys made by me or under my supervision, and that the same is true and correct to the best of my knowledge and belief.

MARCH 16, 1973

Date Surveyed

Registered Professional Engineer and/or Land Surveyor

John W. West
Certificate No. **676**

