

UNITED STATES  
DEPARTMENT OF THE INTERIOR  
GEOLOGICAL SURVEY

## APPLICATION FOR PERMIT TO DRILL, DEEPEN, OR PLUG BACK

1a. TYPE OF WORK DRILL <input checked="" type="checkbox"/> DEEPEN <input type="checkbox"/> PLUG BACK <input type="checkbox"/>		5. LEASE DESIGNATION AND SERIAL NO. NM-0659
b. TYPE OF WELL OIL WELL <input checked="" type="checkbox"/> GAS WELL <input type="checkbox"/> OTHER <input type="checkbox"/> SINGLE ZONE <input checked="" type="checkbox"/> MULTIPLE ZONE <input type="checkbox"/>		6. IF INDIAN, ALLOTTEE OR TRIBE NAME
2. NAME OF OPERATOR Flag-Redfern Oil Company		7. UNIT AGREEMENT NAME
3. ADDRESS OF OPERATOR P. O. Box 23, Midland, Texas 79701		8. FARM OR LEASE NAME Marathon Federal
4. LOCATION OF WELL (Report location clearly and in accordance with any State requirements.)* At surface 2180' FNL & 1980' FWL, Sec. 23, T-9-S, R-37-E At proposed prod. zone Same		9. WELL NO. 1
14. DISTANCE IN MILES AND DIRECTION FROM NEAREST TOWN OR POST OFFICE* 15 miles east of Crossroads, New Mexico		10. FIELD AND POOL, OR LOCAT Sawyer (West) San Andres
15. DISTANCE FROM PROPOSED* LOCATION TO NEAREST PROPERTY OR LEASE LINE, FT. (Also to nearest drlg. unit line, if any) 460'		11. SEC. T., R., M., OR BLK. AND SURVEY OR AREA Sec. 23, T-9-S, R-37-E
16. NO. OF ACRES IN LEASE 160		12. COUNTY OR PARISH Lea
17. NO. OF ACRES ASSIGNED TO THIS WELL 80		13. STATE New Mexico
18. DISTANCE FROM PROPOSED LOCATION* TO NEAREST WELL, DRILLING, COMPLETED, OR APPLIED FOR, ON THIS LEASE, FT. None		19. PROPOSED DEPTH 5100'
20. ROTARY OR CABLE TOOLS Rotary		21. APPROX. DATE WORK WILL START* September 1, 1973
21. ELEVATIONS (Show whether DF, RT, GR, etc.) 3990' DF		

23. PROPOSED CASING AND CEMENTING PROGRAM				
SIZE OF HOLE	SIZE OF CASING	WEIGHT PER FOOT	SETTING DEPTH	QUANTITY OF CEMENT
12-1/4"	8-5/8"	24 J-55	400'	250 sx Class H - 2% CaCl <sub>2</sub>
7-7/8"	4-1/2"	9.5 J-55	5100'	250 sx Poz. 2% gel, 0.75% CFR-2

Drill 12 1/4" hole from surface to approximately 400'. Run and set 8-5/8" casing, circulate cement to surface with 250 sx Class H - 2% CaCl<sub>2</sub>. Drill 7-7/8" hole to approximately 5100'. Run open hole logs. Run 4 1/2" 9.5 lb/ft, J-55 production casing, cement with 250 sx Class C, 2% gel, 0.75% CFR-2, and 8 lbs salt/sack. Run correlation log, perforate San Andres. Treat with acid. Swab to test. Potential well.

Mud Program - 0-4800' native mud.

4800-TD salt base mud - Wt 10.3#, Vis 38, WL 15 cc

Blowout Preventer - Shaffer 10" - Series 900 - Installed on surface casing.

IN ABOVE SPACE DESCRIBE PROPOSED PROGRAM: If proposal is to deepen or plug back, give data on present productive zone and proposed new productive zone. If proposal is to drill or deepen directionally, give pertinent data on subsurface locations and measured and true vertical depths. Give blowout preventer program, if any.

24. SIGNED Bry H. Brown TITLE Production Manager DATE August 14, 1973  
(This space for Federal or State office use)

PERMIT NO. \_\_\_\_\_

APPROVAL DATE

APPROVED BY \_\_\_\_\_ TITLE \_\_\_\_\_  
CONDITIONS OF APPROVAL, IF ANY:

NEW MEXICO OIL CONSERVATION COMMISSION  
WELL LOCATION AND ACREAGE DEDICATION PLAT

Form O-192  
Supersedes O-128  
Effective 1-1-65

All distances must be from the outer boundaries of the Section.

Operator <b>Flag-Redfern Oil Company</b>			Lease <b>Marathon Federal</b>		Well No. <b>1</b>
Unit Letter <b>F</b>	Section <b>23</b>	Township <b>9-S</b>	Range <b>37-E</b>	County <b>Lea</b>	
Actual Location of Well:					
2180 feet from the <b>North</b> line and		1980 feet from the <b>West</b> line			
Ground Level Elev. <b>3980</b>	Producing Formation <b>San Andres</b>	Pool <b>Sawyer (West)</b>	Dedicated Acreage: <b>80</b> Acres		

1. Outline the acreage dedicated to the subject well by colored pencil or hatchure marks on the plat below.
2. If more than one lease is dedicated to the well, outline each and identify the ownership thereof (both as to working interest and royalty).
3. If more than one lease of different ownership is dedicated to the well, have the interests of all owners been consolidated by communitization, unitization, force-pooling, etc?

☐ Yes ☐ No. If answer is "yes," type of consolidation \_\_\_\_\_

If answer is "no," list the owners and tract descriptions which have actually been consolidated. (Use reverse side of this form if necessary.) \_\_\_\_\_

No allowable will be assigned to the well until all interests have been consolidated (by communitization, unitization, forced-pooling, or otherwise) or until a non-standard unit, eliminating such interests, has been approved by the Commission.

		<p align="center"><b>CERTIFICATION</b></p> <p>I hereby certify that the information contained herein is true and complete to the best of my knowledge and belief.</p>	
		<p>Name <i>Dwight H. Green</i></p>	
		<p>Position <b>Production Manager</b></p>	
		<p>Company <b>Flag-Redfern Oil Company</b></p>	
<p>Date <b>August 14, 1973</b></p>		<p>I hereby certify that the well location shown on this plat was plotted from field notes of actual surveys made by me or under my supervision, and that the same is true and correct to the best of my knowledge and belief.</p>	
<p>Date Surveyed <b>7-28-73</b></p>		<p>Registered Professional Engineer and/or Land Surveyor <i>[Signature]</i></p>	
<p>Certificate No. <b>754</b></p>			

FLAG - FEDERAL OIL COMPANY  
SAUTER GAS ADDRESS FIELD  
LEA COUNTY, NEW MEXICO

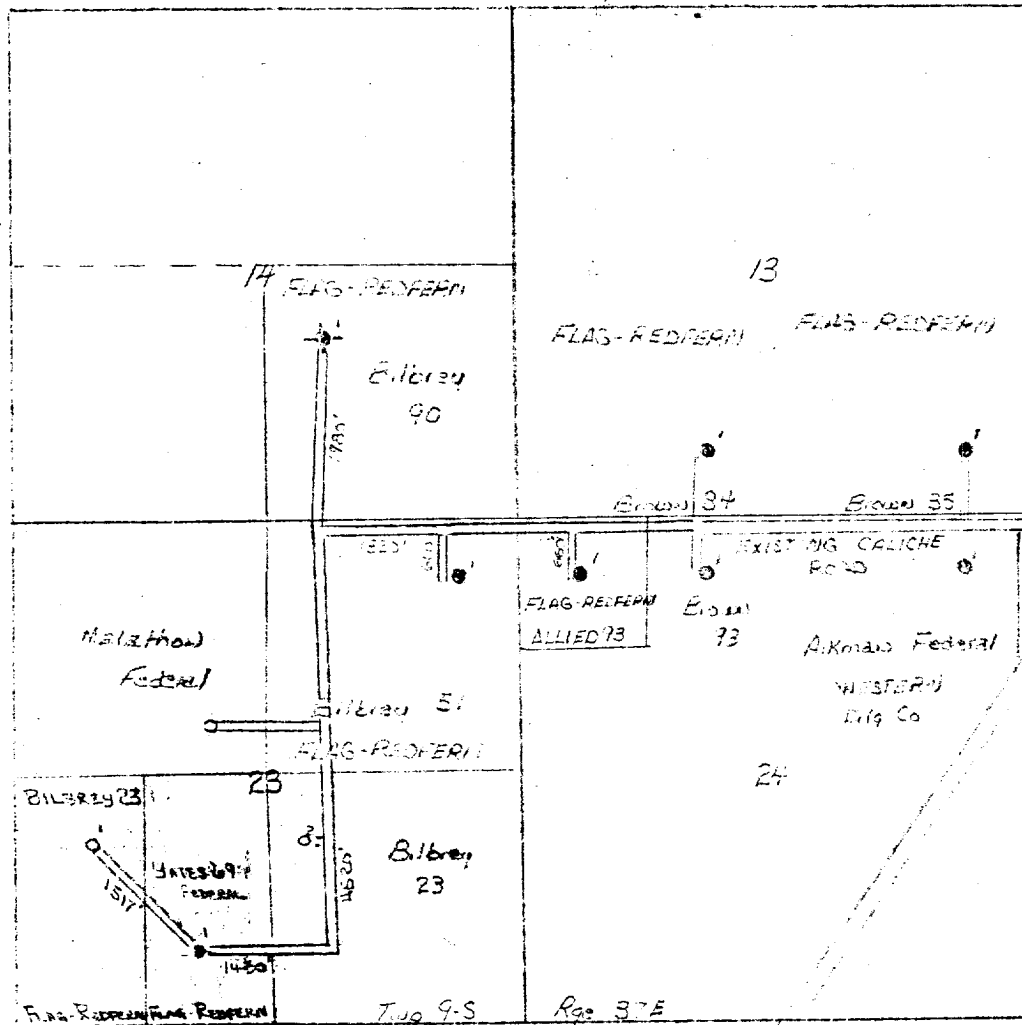

TATUM

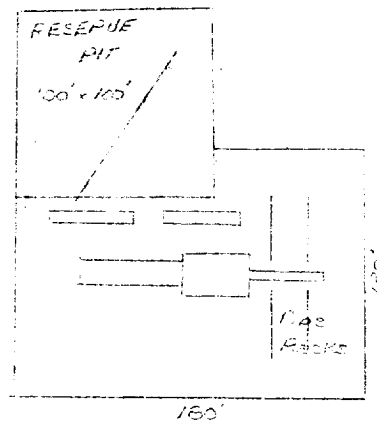



O I L C O M P A N Y

410 WALL TOWERS WEST • MIDLAND, TEXAS 79701

P. O. BOX 23 • PHONE (715) 433-5134

August 14, 1973

U. S. Department of Interior  
Geological Survey  
P. O. Box 1157  
Hobbs, New Mexico 88240

Attention: Mr. Arthur Brown

Gentlemen:

Re: Flag-Redfern Oil Company  
Marathon Federal No. 1  
Section 23, T-9-S, R-37-E  
Lea County, New Mexico

The following is a Development Plan for Surface Use as required to accompany application to drill the captioned well.

1. State Highway 125 from Tatum, New Mexico to Bledsoe, Texas crosses Section 24 one and one-half miles east of the captioned location. Existing caliche roads extend west and south into the northwest of Section 23.
2. The existing caliche road will be extended 1000 feet west into the northwest of Section 23.
3. Additional lateral roads in Section 23 will be required as development progresses.
4. The planned access road will be the only road into the lease.
5. It is anticipated that the tank battery will be installed in the southeast corner of the drilling pad, the size and number of tanks and separators to be determined after the well is completed.
6. There is no known supply of drilling water in the immediate area, and we consequently plan to haul drilling water to this location.
7. All solid waste from the drilling operation will be either buried or hauled away.
8. Produced brine will be stored in tanks and be trucked by permit into an approved subsurface disposal zone.

U. S. Department of Interior  
August 14, 1973  
Page 2

9. Casinghead gas will be purchased by either Warren Petroleum Company or Cities Service Gas Company. Immediately upon completion of the well, contracts will be requested of each company.
10. Location layout and pad detail are diagramed on the attached development plat.
11. Should this be a dry hole, the pits will be filled and surface restored as near as possible to the original contours. Should this well produce, the pits will be filled and leveled and the pad maintained during the life of production.

Please advise if we can furnish any additional information which you might desire.

Yours very truly,

FLAG-REDFERN OIL COMPANY

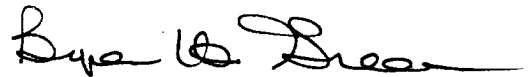

Byron H. Greaves  
Production Manager

BHG:ss

Attachments