

UNITED STATES
DEPARTMENT OF THE INTERIOR
GEOLOGICAL SURVEY

APPLICATION FOR PERMIT TO DRILL, DEEPEN, OR PLUG BACK

1a. TYPE OF WORK

DRILL ☒DEEPEN ☐PLUG BACK ☐

b. TYPE OF WELL

OIL
WELL ☒GAS
WELL ☐

OTHER

SINGLE
ZONE ☐MULTIPLE
ZONE ☐

2. NAME OF OPERATOR

Flag-Redfern Oil Company

3. ADDRESS OF OPERATOR

P. O. Box 23, Midland, Texas 79701

4. LOCATION OF WELL (Report location clearly and in accordance with any State requirements.)*

At surface

660' FWL & 660' FSL

At proposed prod. zone

Same

14. DISTANCE IN MILES AND DIRECTION FROM NEAREST TOWN OR POST OFFICE*

15 miles east of Crossroads, New Mexico

15. DISTANCE FROM PROPOSED*

LOCATION TO NEAREST
PROPERTY OR LEASE LINE, FT.
(Also to nearest drilg. unit line, if any)

660'

16. NO. OF ACRES IN LEASE

240

17. NO. OF ACRES ASSIGNED
TO THIS WELL

40 80

18. DISTANCE FROM PROPOSED LOCATION*
TO NEAREST WELL, DRILLING, COMPLETED,
OR APPLIED FOR, ON THIS LEASE, FT.

1179'

19. PROPOSED DEPTH

5100'

20. ROTARY OR CABLE TOOLS

Rotary

21. ELEVATIONS (Show whether DF, RT, GR, etc.)

22. APPROX. DATE WORK WILL START*

March 18, 1974

23.

PROPOSED CASING AND CEMENTING PROGRAM

SIZE OF HOLE	SIZE OF CASING	WEIGHT PER FOOT	SETTING DEPTH	QUANTITY OF CEMENT
12 1/4"	8-5/8"	20# H-40	375'	250 sx - circulate
7-7/8"	4-1/2"	9.5# J-55	5100'	250 sx

Drill 12 1/4" hole from surface to approximately 375'. Run & set 8-5/8" casing, circulate cement to surface with 250 sx Class "H", 2% CaCl₂. Drill 7-7/8" hole to approximately 5100'. Run open hole logs. Run 4 1/2", 9.5 lb/ft, J-55 production casing, cement with 250 sx Class "C", 2% gel, 0.75% CFR-2, and 8 lbs salt per sack. Run correlation log, perforate San Andres. Treat with acid. Swab to test. Potential well.

Mud Program: 0-4800' Native mud
4800-TD Salt base mud - Wt 10.3, Vis 38, WL 15 cc

Blowout Preventer: Shaffer 10" - Series 900 - Installed on surface pipe.

2nd well on prod. unit

IN ABOVE SPACE DESCRIBE PROPOSED PROGRAM: If proposal is to deepen or plug back, give data on present productive zone and proposed new productive zone. If proposal is to drill or deepen directionally, give pertinent data on subsurface locations and measured and true vertical depths. Give blowout preventer program, if any.

24.

SIGNED

John A. Lunday

TITLE

Petroleum Engineer

DATE February 7, 1974

(This space for Federal or State office use)

PERMIT NO.

APPROVAL DATE

APPROVED BY

TITLE

CONDITIONS OF APPROVAL, IF ANY:

*See Instructions On Reverse Side

NEW MEXICO OIL CONSERVATION COMMISSION
WELL LOCATION AND ACREAGE DEDICATION PLAT

Form C-102
Supersedes C-128
Effective 1-1-65

All distances must be from the outer boundaries of the Section.

Operator Flag-Redfern Oil Company			Lease Bilbrey "23"		Well No. 3
Unit Letter M	Section 23	Township 9-S	Range 37-E	County Lea	
Actual Footage Location of Well: 660' feet from the South line and 660' feet from the West line					
Ground Level Elev.	Producing Formation San Andres		Pool West-Sawyer (West) San Andres.	Dedicated Acreage 40.80 Acres	

- Outline the acreage dedicated to the subject well by colored pencil or hachure marks on the plat below.
- If more than one lease is dedicated to the well, outline each and identify the ownership thereof (both as to working interest and royalty).
- If more than one lease of different ownership is dedicated to the well, have the interests of all owners been consolidated by communitization, unitization, force-pooling, etc?

☐ Yes ☐ No If answer is "yes," type of consolidation _____

If answer is "no," list the owners and tract descriptions which have actually been consolidated. (Use reverse side of this form if necessary.) _____

No allowable will be assigned to the well until all interests have been consolidated (by communitization, unitization, forced-pooling, or otherwise) or until a non-standard unit, eliminating such interests, has been approved by the Commission.

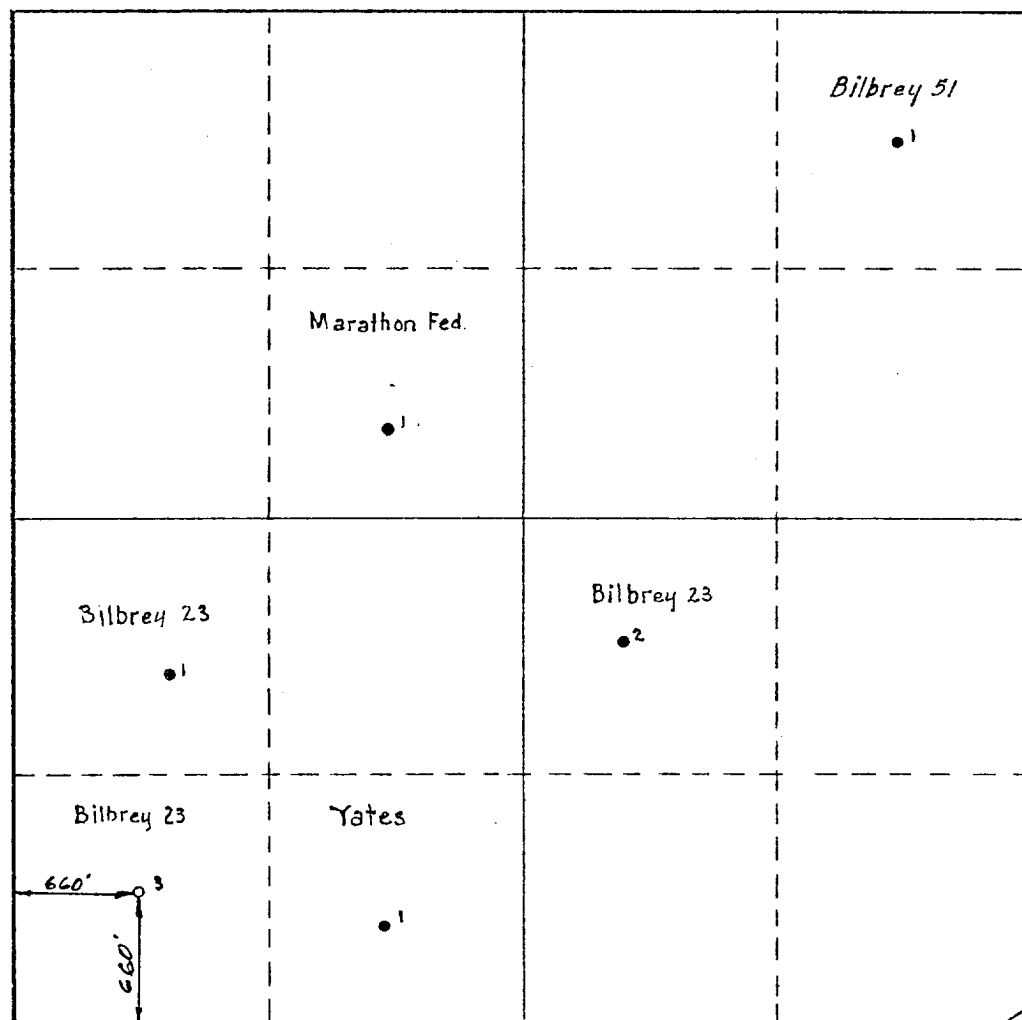

CERTIFICATION

I hereby certify that the information contained herein is true and complete to the best of my knowledge and belief.

Name John H. Lumberg
Position Petroleum Engineer
Company Flag-Redfern Oil Company
Date February 7, 1974

I hereby certify that the well location shown on this plat was plotted from field notes of actual surveys made by me or under my supervision, and that the same is true and correct to the best of my knowledge and belief.

Date Surveyed February 4, 1974

Registered Professional Engineer and/or Land Surveyor

[Signature]
Certificate No. 754

FLAG-REDFERN OIL COMPANY DEVELOPMENT PLAN FOR SURFACE USE

Lea Co., New Mexico

R-37-E

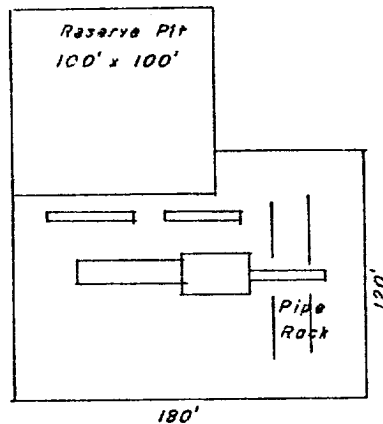
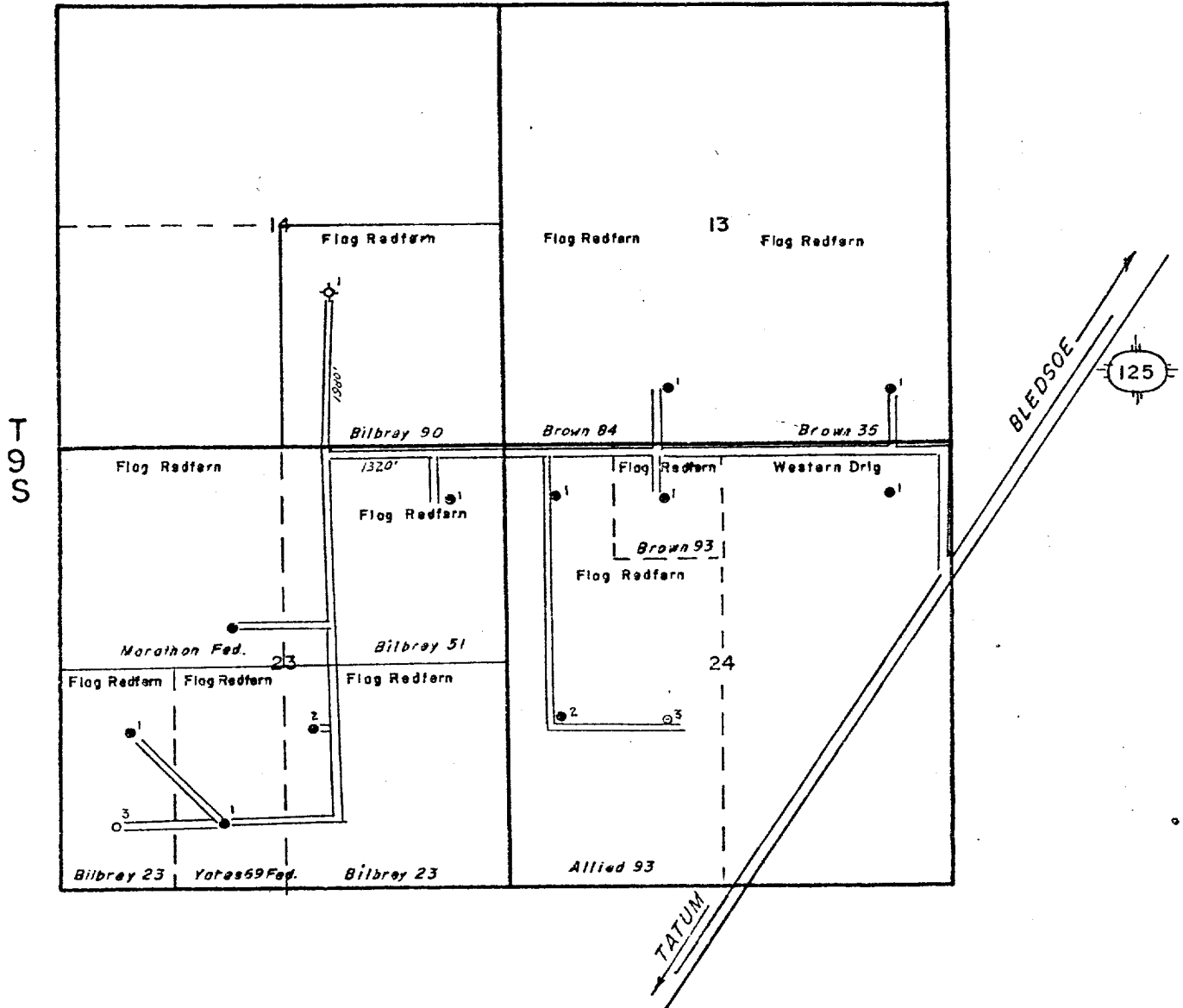

PAD DETAIL



O I L C O M P A N Y

410 WALL TOWERS WEST • MIDLAND, TEXAS 79701

P. O. BOX 23 • PHONE (915) 683-5184

February 7, 1974

U. S. Department of Interior
Geological Survey
P. O. Box 1157
Hobbs, New Mexico 88240

Attention: Mr. Arthur Brown

Gentlemen:

Re: Flag-Redfern Oil Company
Bilbrey "23" No. 3
Sec. 23, T-9-S, R-37-E
Lea County, New Mexico

The following is a Development Plan for Surface Use as required to accompany application to drill the captioned well.

1. State Highway 125 from Tatum, New Mexico to Bledsoe, Texas crosses Section 24 east of the captioned location. Existing caliche roads extend west and south into the southwest of Section 23.
2. The existing caliche road will be extended 1320 feet west from the Yates "69th" Federal No. 1 to the new location.
3. Additional lateral roads in Section 24 will be required as development progresses.
4. The planned access road will be the only road into the lease.
5. It is anticipated that the tank battery will be installed in the southeast corner of the drilling pad, the size and number of tanks and separators to be determined after the well is completed.
6. There is no known supply of drilling water in the immediate area, and we consequently plan to haul drilling water to this location.
7. All solid waste from the drilling operation will be either buried or hauled away.
8. Produced brine will be stored in tanks and be trucked by permit into an approved subsurface disposal zone.

U. S. Department of Interior
February 7, 1974
Page 2

9. Casinghead gas will be purchased by either Warren Petroleum Company or Cities Service Gas Company. Immediately upon completion of the well, contracts will be requested of each company.
10. Location layout and pad detail are diagramed on the attached development plat.
11. Should this be a dry hole, the pits will be filled and surface restored as near as possible to the original contours. Should this well produce, the pits will be filled and leveled and the pad maintained during the life of production.

Please advise if we can furnish any additional information which you might desire.

Yours very truly,

FLAG-REDFERN OIL COMPANY



John H. Swendig
Petroleum Engineer

JHS:ss

Attachments