

NO. OF COPIES RECEIVED		
DISTRIBUTION		
SANTA FE		
FILE		
U.S.G.S.		
LAND OFFICE		
OPERATOR		

# NEW MEXICO OIL CONSERVATION COMMISSION

Form C-101  
Revised 1-1-65

5A. Indicate Type of Lease	
STATE <input checked="" type="checkbox"/>	FEE <input type="checkbox"/>
5. State Oil & Gas Lease No.	

## APPLICATION FOR PERMIT TO DRILL, DEEPEN, OR PLUG BACK

1a. Type of Work		7. Unit Agreement Name	
b. Type of Well DRILL <input checked="" type="checkbox"/> DEEPEN <input type="checkbox"/> PLUG BACK <input type="checkbox"/> OIL WELL <input checked="" type="checkbox"/> GAS WELL <input type="checkbox"/> OTHER <input type="checkbox"/> SINGLE ZONE <input type="checkbox"/> MULTIPLE ZONE <input type="checkbox"/>		8. Farm or Lease Name LCH 689 B Ltd.	
2. Name of Operator BTA Oil Producers		9. Well No. 2	
3. Address of Operator 104 South Pecos Midland, Texas 79701		10. Field and Pool, or Wildcat N. Bagley (L) Penn	
4. Location of Well UNIT LETTER "N" LOCATED 660' FEET FROM THE South LINE AND 2130' FEET FROM THE West LINE OF SEC. 31 TWP. 11-S RGE. 33-E NMPM		12. County Lea	
19. Proposed Depth 10,500'		19A. Formation Pennsylvanian	20. Rotary or C.T. Rotary
21. Elevations (Show whether DF, RT, etc.) 4301' G. L.	21A. Kind & Status Plug. Bond Blanket on file	21B. Drilling Contractor Hondo Drilling Co.	22. Approx. Date Work will start upon approval

## PROPOSED CASING AND CEMENT PROGRAM

SIZE OF HOLE	SIZE OF CASING	WEIGHT PER FOOT	SETTING DEPTH	SACKS OF CEMENT	EST. TOP
17-1/2"	12-3/4"	33#, 38#	375'	375	circulated
12-1/4"	8-5/8"	24#, 28#, 32#	4,100'	400	
7-7/8"	5-1/2"	17#	10,500'	300	

APPROVAL VALID  
FOR 90 DAYS UNLESS  
DRILLING COMMENCED,  
EXPIRES 2-12-74

IN ABOVE SPACE DESCRIBE PROPOSED PROGRAM: IF PROPOSAL IS TO DEEPEN OR PLUG BACK, GIVE DATA ON PRESENT PRODUCTIVE ZONE AND PROPOSED NEW PRODUCTIVE ZONE. GIVE BLOWOUT PREVENTER PROGRAM, IF ANY.

I hereby certify that the information above is true and complete to the best of my knowledge and belief.

Signed R. D. Boyce Title R. D. Boyce, Production Foreman Date 4/12/74

(This space for State Use)

APPROVED BY [Signature] TITLE [Signature] DATE [Signature]  
CONDITIONS OF APPROVAL, IF ANY:

**NEW MEXICO OIL CONSERVATION COMMISSION**  
**WELL LOCATION AND ACREAGE DEDICATION PLAT**

Form C-102  
 Supersedes C-128  
 Effective 1-1-65

All distances must be from the outer boundaries of the Section.

Operator <b>BTA OIL PRODUCERS</b>		Lease <b>689 "B" LTD LCH</b>		Well No. <b>2</b>
Unit Letter <b>"N"</b>	Section <b>31</b>	Township <b>11-S</b>	Range <b>33-E</b>	County <b>LEA</b>
Actual Footage Location of Well: <b>660</b> feet from the <b>SOUTH</b> line and <b>2130</b> feet from the <b>WEST</b> line				
Ground Level Elev. <b>4301</b>	Producing Formation <b>PENNSYLVANIAN</b>	Pool <b>NORTH BAGLEY (LOWER)</b>	Dedicated Acreage: <b>80</b> Acres	

1. Outline the acreage dedicated to the subject well by colored pencil or hachure marks on the plat below.
2. If more than one lease is dedicated to the well, outline each and identify the ownership thereof (both as to working interest and royalty).
3. If more than one lease of different ownership is dedicated to the well, have the interests of all owners been consolidated by communitization, unitization, force-pooling, etc?

☐ Yes    ☐ No    If answer is "yes," type of consolidation \_\_\_\_\_

If answer is "no," list the owners and tract descriptions which have actually been consolidated. (Use reverse side of this form if necessary.) \_\_\_\_\_

No allowable will be assigned to the well until all interests have been consolidated (by communitization, unitization, forced-pooling, or otherwise) or until a non-standard unit, eliminating such interests, has been approved by the Commission.

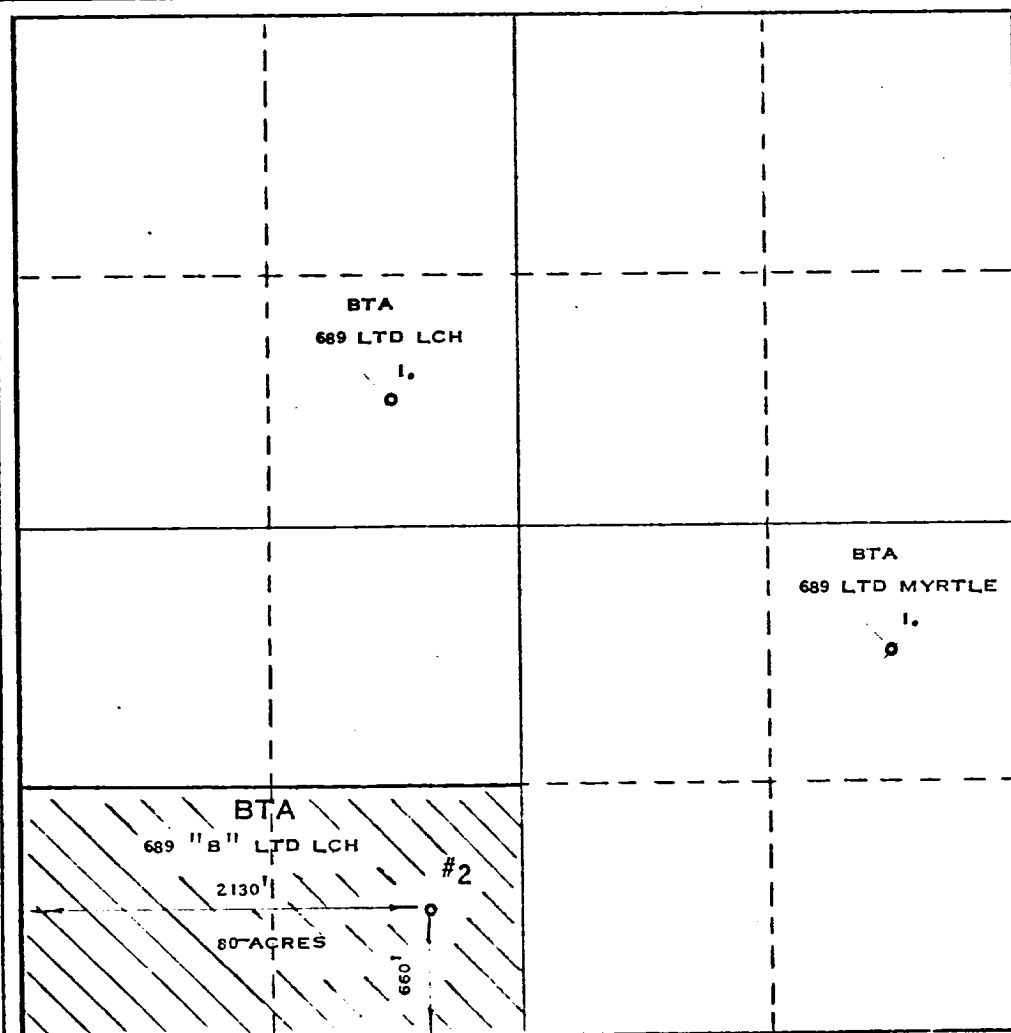

**CERTIFICATION**

I hereby certify that the information contained herein is true and complete to the best of my knowledge and belief.

Name **R. D. Boyce**  
 Position **Production Foreman**

Company **BTA Oil Producers**

Date **4/12/74**

I hereby certify that the well location shown on this plat was plotted from field notes of actual surveys made by me or under my supervision, and that the same is true and correct to the best of my knowledge and belief.

Date Surveyed  
**FEBRUARY 26, 1974**

Registered Professional Engineer  
 and/or Land Surveyor  
**MAX A. SCHUMANN JR.**

Certificate No. **1510**