

NO. OF COPIES RECEIVED		
DISTRIBUTION		
SANTA FE		
FILE		
U.S.G.S.		
LAND OFFICE		
OPERATOR		

NEW MEXICO OIL CONSERVATION COMMISSION

Form C-101

Revised 1-1-65

5A. Indicate Type of Lease
 STATE ☐ FEE ☒

5. State Oil & Gas Lease No.

APPLICATION FOR PERMIT TO DRILL, DEEPEN, OR PLUG BACK

1a. Type of Work b. Type of Well OIL WELL <input checked="" type="checkbox"/> GAS WELL <input type="checkbox"/> OTHER <input type="checkbox"/> DRILL <input checked="" type="checkbox"/> DEEPEN <input type="checkbox"/> PLUG BACK <input type="checkbox"/> SINGLE ZONE <input type="checkbox"/> MULTIPLE ZONE <input type="checkbox"/>		7. Unit Agreement Name
2. Name of Operator BTA Oil Producers		8. Farm or Lease Name Brewer 689-C
3. Address of Operator 104 South Pecos Midland, Texas 79701		9. Well No. 2
4. Location of Well UNIT LETTER "H" LOCATED 1900 FEET FROM THE North LINE AND 560 FEET FROM THE East LINE OF SEC. 6 TWP. 12-S RGE. 33-E NMPM		10. Field and Pool, or Wildcat N. Bagley (L) Penn
		12. County Lea
19. Proposed Depth 10,500'		19A. Formation Pennsylvanian
20. Rotary or C.T. Rotary		
21. Elevations (Show whether DE, RT, etc.) 4289' GL; 4299' KB	21A. Kind & Status Plug. Bond Blanket on file	21B. Drilling Contractor Hondo Drilling Co.
		22. Approx. Date Work will start Upon approval

23.

PROPOSED CASING AND CEMENT PROGRAM

SIZE OF HOLE	SIZE OF CASING	WEIGHT PER FOOT	SETTING DEPTH	SACKS OF CEMENT	EST. TOP
17-1/2"	12-3/4"	33#, 38#	385'	375	Circ.
11"	8-5/8"	24#, 28#	3,725'	400	
7-7/8"	5-1/2"	17#, 20#, 23#	10,450'	500	

AMENDED REPORT--CORRECTED SECTION.

APPROVAL VALID
 FOR 90 DAYS UNLESS
 DRILLING COMMENCED,

EXPIRES Sept. 12, 1974

IN ABOVE SPACE DESCRIBE PROPOSED PROGRAM; IF PROPOSAL IS TO DEEPEN OR PLUG BACK, GIVE DATA ON PRESENT PRODUCTIVE ZONE AND PROPOSED NEW PRODUCTIVE ZONE. GIVE BLOWOUT PREVENTER PROGRAM, IF ANY.

I hereby certify that the information above is true and complete to the best of my knowledge and belief.

Signed Janis Jones Title Production Clerk Janis Jones Date 6/12/74

(This space for State Use)

APPROVED BY John W. Runyan TITLE Geologist DATE JUN 14 1974

CONDITIONS OF APPROVAL, IF ANY:

NATIONAL OIL CONSERVATION COMMISSION
WELL LOCATION AND ACREAGE DEDICATION PLAT

Form C-102
Supersedes C-128
Effective 1-1-65

All distances must be from the outer boundaries of the Section.

Operator BTA OIL PRODUCERS		Lease 689-C-LTD, BREWER		Well No. 2
Unit Letter "H"	Section 6	Township 12-S	Range 33-E	County LEA
Actual Footage Location of Well: 1900 feet from the NORTH line and 560 feet from the EAST line				
Ground Level Elev. 4289	Producing Formation PENNSYLVANIAN	Pool NORTH BAGLEY (LOWER)	Dedicated Acreage: 80 Acres	

1. Outline the acreage dedicated to the subject well by colored pencil or hachure marks on the plat below.
2. If more than one lease is dedicated to the well, outline each and identify the ownership thereof (both as to working interest and royalty).
3. If more than one lease of different ownership is dedicated to the well, have the interests of all owners been consolidated by communitization, unitization, force-pooling, etc?

☐ Yes ☐ No If answer is "yes," type of consolidation _____

If answer is "no," list the owners and tract descriptions which have actually been consolidated. (Use reverse side of this form if necessary.) _____

No allowable will be assigned to the well until all interests have been consolidated (by communitization, unitization, forced-pooling, or otherwise) or until a non-standard unit, eliminating such interests, has been approved by the Commission.

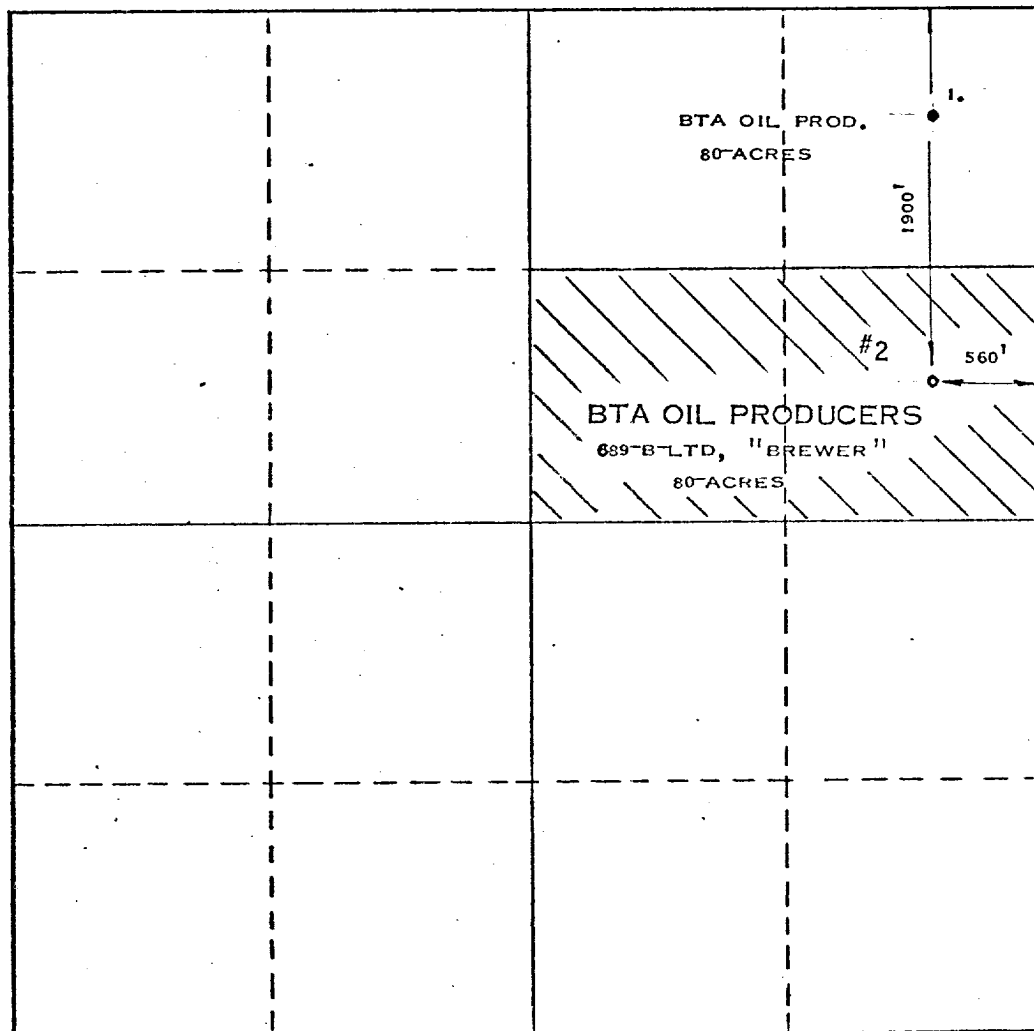

CERTIFICATION

I hereby certify that the information contained herein is true and complete to the best of my knowledge and belief.

Name **Janis Jones**
Production Clerk

Position

BTA Oil Producers

Company

May 14, 1974

Date

I hereby certify that the well location shown on this plat was plotted from field notes of actual surveys made by me or under my supervision, and that the same is true and correct to the best of my knowledge and belief.

Date Surveyed
MAY 10, 1974

Registered Professional Engineer
and/or Land Surveyor

Max A. Schumann, Jr.
MAX A. SCHUMANN, JR.

Certificate No. **1510**