

**NEW MEXICO OIL CONSERVATION COMMISSION
WELL LOCATION AND ACREAGE DEDICATION PLAT**

Rev. 1-1977
Supersedes C-128
Effective 1-1-78

All distances must be from the outer boundaries of the Section

Operator WOOD & COCKBURN, INC.			Lease SUN-STATE		Well No. 1
Unit Letter "F"	Section 23	Township 11-S	Range 34-E	County LEA	
Actual Footage Location of Well:					
1980	feet from the	NORTH	line and	1980	feet from the
1980				WEST	line
Ground Level Elev. 4144	Producing Formation DEVONIAN		Well WILDCAT		Estimated Acreage 40 Acres

1. Outline the acreage dedicated to the subject well by colored pencil or hatchure marks on the plat below.
2. If more than one lease is dedicated to the well, outline each and identify the ownership thereof (both as to working interest and royalty).
3. If more than one lease of different ownership is dedicated to the well, have the interests of all owners been consolidated by communitization, unitization, force-pooling, etc?

☐ Yes ☐ No If answer is "yes," type of consolidation _____

If answer is "no," list the owners and tract descriptions which have actually been consolidated. (Use reverse side of this form if necessary.) _____

No allowable will be assigned to the well until all interests have been consolidated (by communitization, unitization, forced-pooling, or otherwise) or until a non-standard unit, eliminating such interests, has been approved by the Commission.

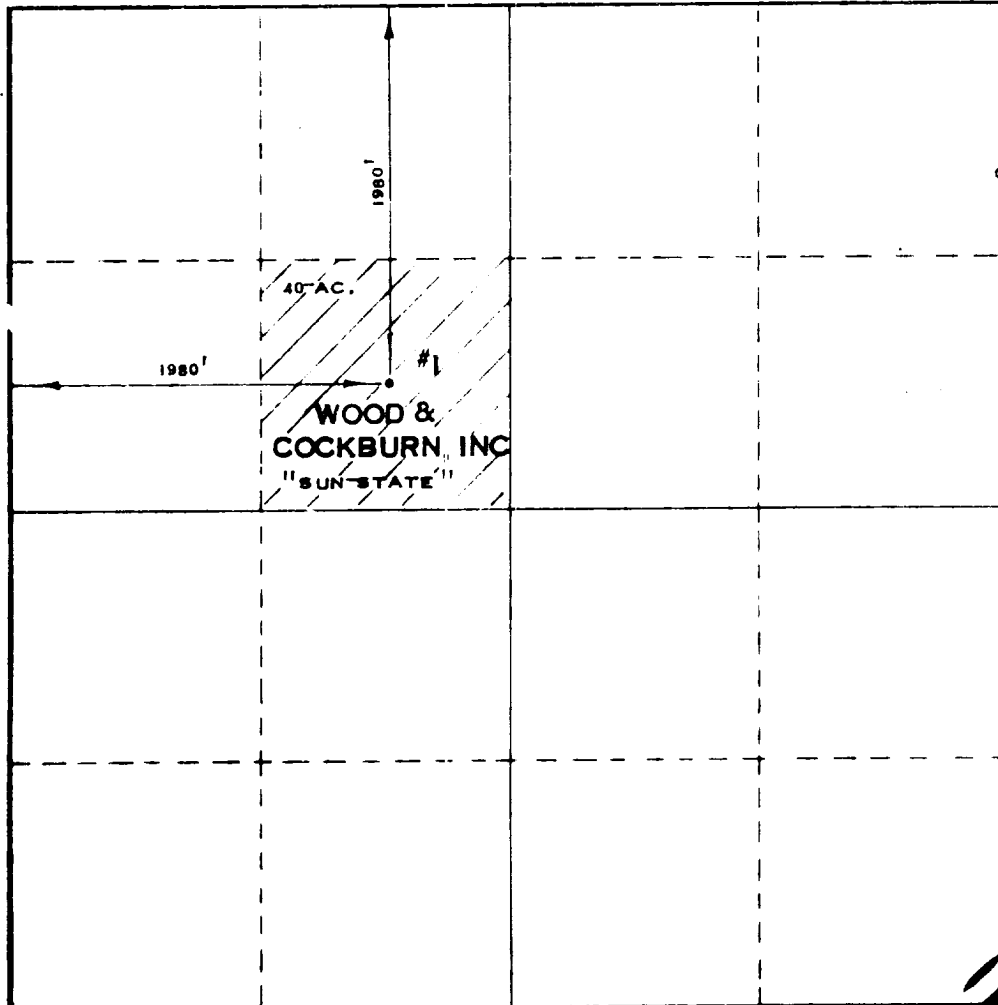

CERTIFICATION

I hereby certify that the information contained herein is true and complete to the best of my knowledge and belief.

R. K. Belcher
Name **R. K. Belcher**
Position **Vice President Production**
Company **WOOD & COCKBURN, INC.**
Date **July 22, 1974**

I hereby certify that the well location shown on this plat was plotted from field notes of actual surveys made by me or under my supervision, and that the same is true and correct to the best of my knowledge and belief.

Date Surveyed
JULY 22, 1974
Registered Professional Engineer
and Land Surveyor

[Signature]
Certificate No.

1510

