

NEW MEXICO OIL CONSERVATION COMMISSION
WELL LOCATION AND ACREAGE DEDICATION PLAT

Form C-102
Supersedes C-128
Effective 1-1-65

All distances must be from the outer boundaries of the Section.

Operator Phillips Petroleum Company		Lease Marg-A "COM"		Well No. 1	
Unit Letter K	Section 25	Township 9-S	Range 32-E	County Lea	
Actual Footage Location of Well: 1980 feet from the south line and 1980 feet from the west line					
Ground Level Elev. 4299.3'	Producing Formation Atoka		Pool Undesignated Atoka - Gas		Dedicated Acreage: 320 Acres

1. Outline the acreage dedicated to the subject well by colored pencil or hachure marks on the plat below.
2. If more than one lease is dedicated to the well, outline each and identify the ownership thereof (both as to working interest and royalty). See reverse side for lease descriptions.
3. If more than one lease of different ownership is dedicated to the well, have the interests of all owners been consolidated by communitization, unitization, force-pooling, etc?

☒ Yes ☐ No If answer is "yes," type of consolidation Communitization

If answer is "no," list the owners and tract descriptions which have actually been consolidated. (Use reverse side of this form if necessary.) _____

No allowable will be assigned to the well until all interests have been consolidated (by communitization, unitization, forced-pooling, or otherwise) or until a non-standard unit, eliminating such interests, has been approved by the Commission.

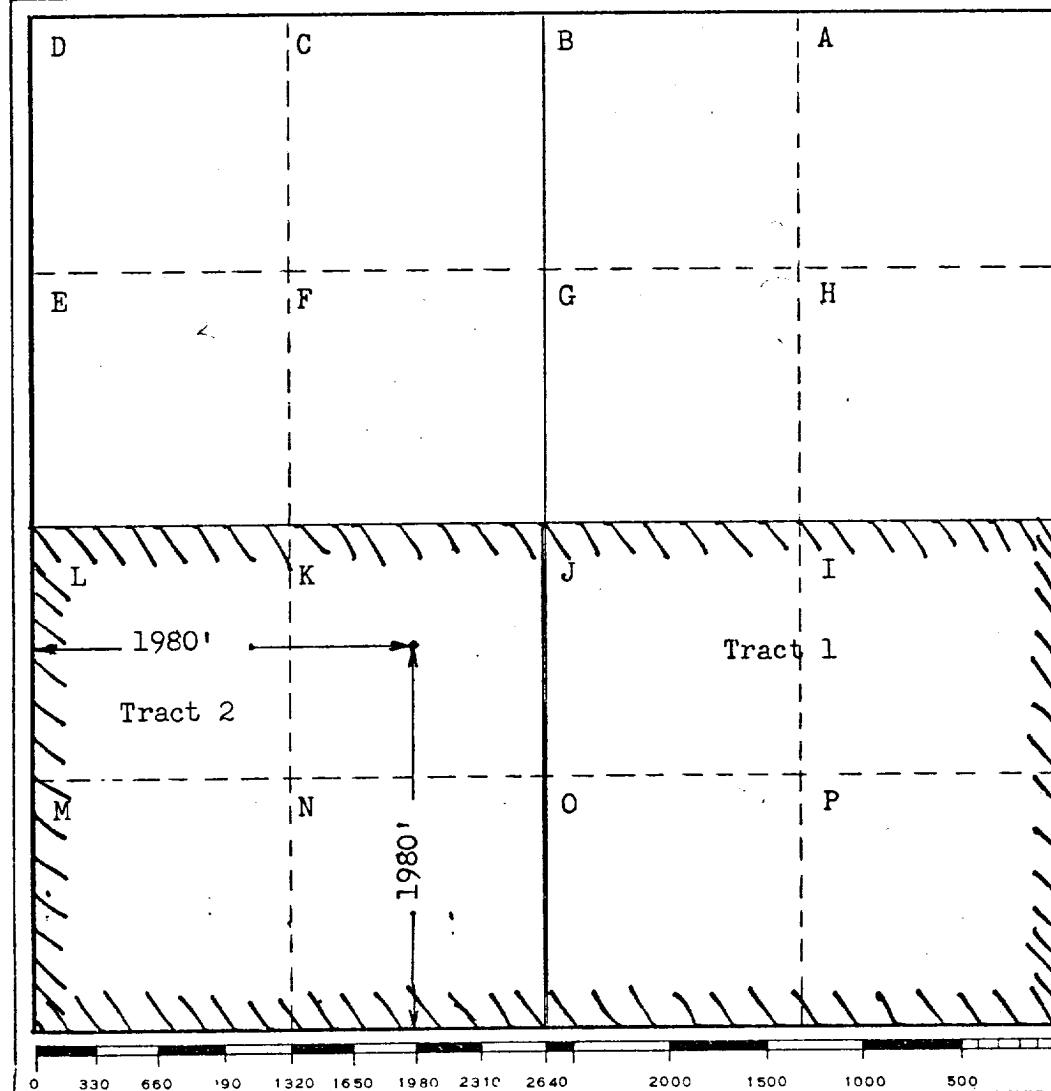

CERTIFICATION

I hereby certify that the information contained herein is true and complete to the best of my knowledge and belief.

Name

G. W. Edwards

Position

Supvr., Reservoir Engineering

Company

Phillips Petroleum Company

Date

December 4, 1974

I hereby certify that the well location shown on this plat was plotted from field notes of actual surveys made by me or under my supervision, and that the same is true and correct to the best of my knowledge and belief.

Date Surveyed

August 8, 1974

Registered Professional Engineer and/or Land Surveyor

John W. West

Certificate No.

676

Tract 1: SE/4 Section 25

Ownership: Working Interest - Phillips Petroleum Company

Royalty Interest - USA - Department of Interior
Lease No. NM-15903-B

Tract 2: SW/4 Section 25

Ownership: Working Interest - Texas Crude, Inc.

Royalty Interest - USA - Department of Interior
Lease No. NM-0421214