

NO. OF COPIES RECEIVED		
DISTRIBUTION		
SANTA FE		
FILE		
U.S.G.S.		
LAND OFFICE		
OPERATOR		

NEW MEXICO OIL CONSERVATION COMMISSION

Form C-101
Revised 1-1-65

5A. Indicate Type of Lease	
STATE <input checked="" type="checkbox"/>	FEE <input type="checkbox"/>
5. State Oil & Gas Lease No.	
L2802	
7. Unit Agreement Name	
8. Farm or Lease Name	
Thornton State	
9. Well No.	
10. Field and Pool, or Wildcat	
No. Mescalero Cisco	
12. County	
Lea	
19. Proposed Depth	19A. Formation
9100	Cisco
20. Rotary or C.T.	
Rotary	
21. Elevations (Show whether DF, RT, etc.)	21A. Kind & Status Plug. Bond
4331 GR	Blanket on File
21B. Drilling Contractor	22. Approx. Date Work will start
Amini Drilling Co.	When rig available

APPLICATION FOR PERMIT TO DRILL, DEEPEN, OR PLUG BACK

1a. Type of Work	
DRILL <input checked="" type="checkbox"/>	DEEPEN <input type="checkbox"/>
PLUG BACK <input type="checkbox"/>	
b. Type of Well	
OIL WELL <input checked="" type="checkbox"/>	GAS WELL <input type="checkbox"/>
OTHER <input type="checkbox"/>	
2. Name of Operator	
Teal Petroleum Company	
3. Address of Operator	
P.O. Drawer 2358 Midland, Texas 79701	
4. Location of Well	
UNIT LETTER <u>O</u>	LOCATED <u>1980</u> FEET FROM THE <u>East</u> LINE
AND <u>330</u> FEET FROM THE <u>South</u> LINE OF SEC. <u>3</u> TWP. <u>10S</u> RGE. <u>32E</u> NMPM	
21. Elevations (Show whether DF, RT, etc.)	
4331 GR	
21A. Kind & Status Plug. Bond	
Blanket on File	
21B. Drilling Contractor	
Amini Drilling Co.	
22. Approx. Date Work will start	
When rig available	

23.

PROPOSED CASING AND CEMENT PROGRAM

SIZE OF HOLE	SIZE OF CASING	WEIGHT PER FOOT	SETTING DEPTH	SACKS OF CEMENT	EST. TOP
17-1/2	12-3/4"	31.3#	350'	425	circulate
11	8-5/8"	28 & 32#	3450'	300	2500
7-7/8	4-1/2"	10.5 & 11.6#	9100'	500	7300

APPROVAL VALID
FOR 90 DAYS UNLESS
DRILLING COMMENCED,

EXPIRES 3-5-75

IN ABOVE SPACE DESCRIBE PROPOSED PROGRAM: IF PROPOSAL IS TO DEEPEN OR PLUG BACK, GIVE DATA ON PRESENT PRODUCTIVE ZONE AND PROPOSED NEW PRODUCTIVE ZONE. GIVE BLOWOUT PREVENTER PROGRAM, IF ANY.

I hereby certify that the information above is true and complete to the best of my knowledge and belief.

Signed Douglas W. Rice Title District Engineer Date December 3 1974
(This space for State Use)

APPROVED BY [Signature] TITLE SUPERVISOR DISTRICT I DATE DEC 5 1974

CONDITIONS OF APPROVAL, IF ANY:

**NEW MEXICO OIL CONSERVATION COMMISSION
WELL LOCATION AND ACREAGE DEDICATION FORM**

Form C-102
Supersedes C-128
Effective 1-1-55

All distances must be from the outer boundaries of the Section.

Operator TEAL PETROLEUM COMPANY			Lease THORNTON-STATE		Well No. 1
Unit Letter "O"	Section 3	Township 10-S	Range 32-E	County LEA	
Actual Footage Location of Well: 330 feet from the SOUTH line and 1980 feet from the EAST line					
Ground Level Elev. 4331	Producing Formation CISCO		Pool N. MESCALERO-CISCO		Dedicated Acreage; 40 Acres

1. Outline the acreage dedicated to the subject well by colored pencil or hachure marks on the plat below.
2. If more than one lease is dedicated to the well, outline each and identify the ownership thereof (both as to working interest and royalty).
3. If more than one lease of different ownership is dedicated to the well, have the interests of all owners been consolidated by communitization, unitization, force-pooling, etc?

☐ Yes ☐ No If answer is "yes," type of consolidation _____

If answer is "no," list the owners and tract descriptions which have actually been consolidated. (Use reverse side of this form if necessary.) _____

No allowable will be assigned to the well until all interests have been consolidated (by communitization, unitization, forced-pooling, or otherwise) or until a non-standard unit, eliminating such interests, has been approved by the Commission.

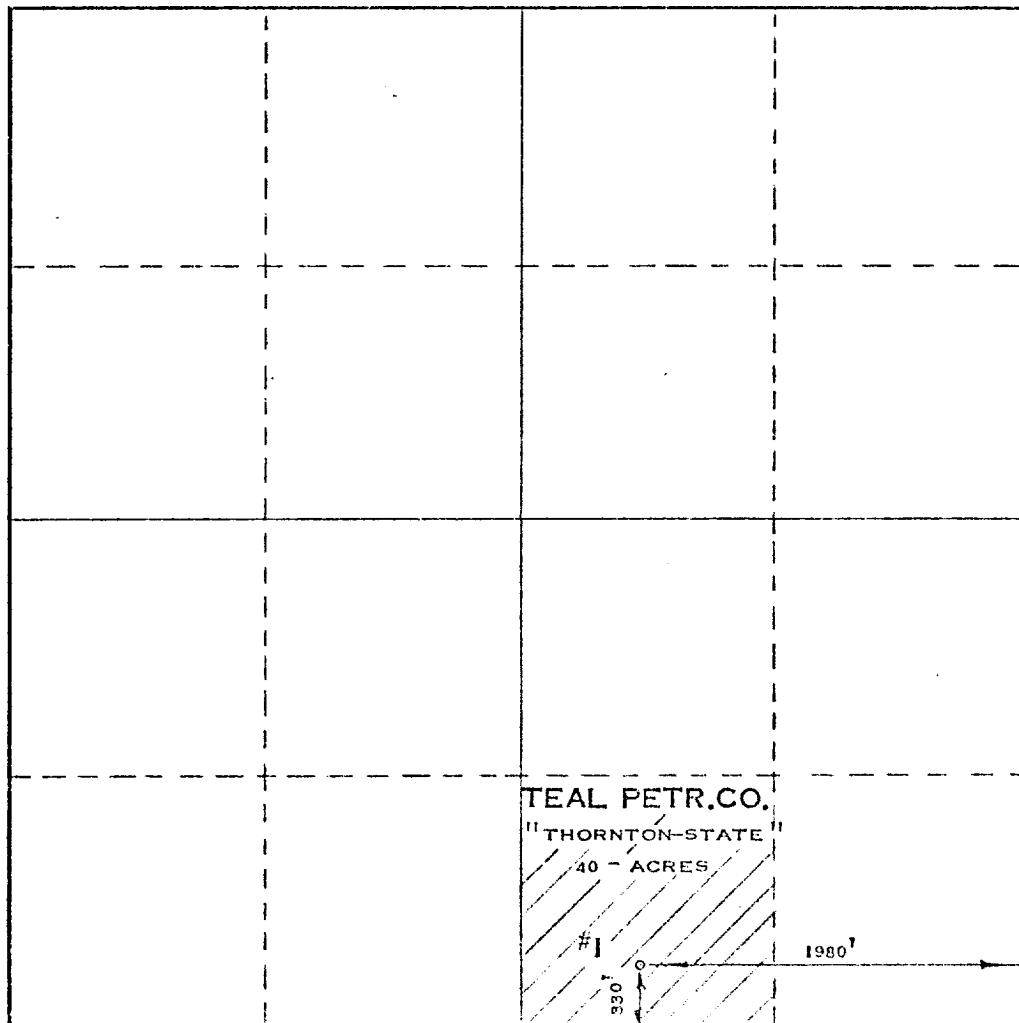

CERTIFICATION

I hereby certify that the information contained herein is true and complete to the best of my knowledge and belief.

D.W. Rice **D.W. Rice**

Name
District Engineer
Position
Teal Petroleum Company
Company
December 3, 1974
Date

I hereby certify that the well location shown on this plat was plotted from field notes of actual surveys made by me or under my supervision, and that the same is true and correct to the best of my knowledge and belief.

Date Surveyed
NOVEMBER 26, 1974

Registered Professional Engineer,
and/or Land Surveyor

Max A. Schumann, Jr.
MAX A. SCHUMANN, JR.

Certificate No. **1510**