

| | |
|------------------------|--|
| NO. OF COPIES RECEIVED | |
| DISTRIBUTION | |
| SANTA FE | |
| FILE | |
| U.S.G.S. | |
| LAND OFFICE | |
| OPERATOR | |

NEW MEXICO OIL CONSERVATION COMMISSION

Form C-101
Revised 1-1-65

5A. Indicate Type of Lease

STATE ☐ FEE ☒

5. State Oil & Gas Lease No.

APPLICATION FOR PERMIT TO DRILL, DEEPEN, OR PLUG BACK

| | | | |
|--|--|--|--|
| 1a. Type of Work | | 7. Unit Agreement Name | |
| b. Type of Well DRILL <input checked="" type="checkbox"/> DEEPEN <input type="checkbox"/> PLUG BACK <input type="checkbox"/> OIL WELL <input type="checkbox"/> GAS WELL <input checked="" type="checkbox"/> OTHER <input type="checkbox"/> SINGLE ZONE <input type="checkbox"/> MULTIPLE ZONE <input type="checkbox"/> | | 8. Farm or Lease Name Brown "17" | |
| 2. Name of Operator Flag-Redfern Oil Company | | 9. Well No. 1 | |
| 3. Address of Operator P. O. Box 23, Midland, Texas 79701 | | 10. Field and Pool, or Wildcat Sawyer San Andres | |
| 4. Location of Well UNIT LETTER F LOCATED 1980 FEET FROM THE North LINE AND 1980 FEET FROM THE West LINE OF SEC. 17 TWP. 9S RGE. 38E NMPM | | 12. County Lea | |
| 19. Proposed Depth 5050' | | 19A. Formation San Andres | |
| 20. Rotary or C.T. Rotary | | 21. Elevations (Show whether DF, RT, etc.) 3951' GR | |
| 21A. Kind & Status Plug. Bond Blanket | | 21B. Drilling Contractor Sitton and Norton | |
| 22. Approx. Date Work will start March 15, 1975 | | | |

23.

PROPOSED CASING AND CEMENT PROGRAM

| SIZE OF HOLE | SIZE OF CASING | WEIGHT PER FOOT | SETTING DEPTH | SACKS OF CEMENT | EST. TOP |
|--------------|----------------|-----------------|---------------|-----------------|-----------|
| 12-1/4" | 8-5/8" | 24# K-55 | 350' | 250 | Circulate |
| 7-7/8" | 4-1/2" | 10.60# H-40 | 5050' | 250 | 3000' |

Drill 12 1/4" hole from surface to approximately 350'. Run and set 8-5/8" casing and cement to surface with 250 sacks Class "C" w/2% CaCl. Drill 7-7/8" hole to approximately 5050'. Run open hole logs. Run & set 4 1/2" casing and cmt with 250 sx Class "C" Poz with 2% gel, 0.75% CFR-2, 8 lbs salt per sack. Run correlation logs and perforate San Andres formation. Treat with acid. Swab to test. Potential well.

Mud Program: 0- 375' Native Mud
375-4850' Native Mud and Oil
4850-T.D. Starch, Oil Emulsion

Blowout Preventer: Shaffer 10" - Series 900 - Installed on surface pipe.

IN ABOVE SPACE DESCRIBE PROPOSED PROGRAM: IF PROPOSAL IS TO DEEPEN OR PLUG BACK, GIVE DATA ON PRESENT PRODUCTIVE ZONE AND PROPOSED NEW PRODUCTIVE ZONE. GIVE BLOWOUT PREVENTER PROGRAM, IF ANY.

I hereby certify that the information above is true and complete to the best of my knowledge and belief.

Signed Alvin H. Lundy Title Petroleum Engineer Date January 17, 1975

(This space for State Use)

APPROVED BY _____ TITLE _____ DATE _____

CONDITIONS OF APPROVAL, IF ANY:

**NEW MEXICO OIL CONSERVATION COMMISSION
WELL LOCATION AND ACREAGE DEDICATION PLAT**

Form C-102
Supersedes C-128
Effective 1-1-65

All distances must be from the outer boundaries of the Section.

| | | | | | |
|---|--|---|----------------------------|--|----------------------|
| Operator Flag-Redfern Oil Company | | | Lease Brown "17" | | Well No. 1 |
| Unit Letter F | Section 17 | Township 9S | Range 38E | County Lea | |
| Actual Footage Location of Well: | | | | | |
| 1980 feet from the North line and | | 1980 feet from the South line | | | |
| Ground Level Elev. 3951' | Producing Formation San Andres | Pool Sawyer | | Dedicated Acreage: 160 Acres | |

1. Outline the acreage dedicated to the subject well by colored pencil or hachure marks on the plat below.
2. If more than one lease is dedicated to the well, outline each and identify the ownership thereof (both as to working interest and royalty).
3. If more than one lease of different ownership is dedicated to the well, have the interests of all owners been consolidated by communitization, unitization, force-pooling, etc?

☐ Yes ☐ No If answer is "yes," type of consolidation _____

If answer is "no," list the owners and tract descriptions which have actually been consolidated. (Use reverse side of this form if necessary.) _____

No allowable will be assigned to the well until all interests have been consolidated (by communitization, unitization, forced-pooling, or otherwise) or until a non-standard unit, eliminating such interests, has been approved by the Commission.

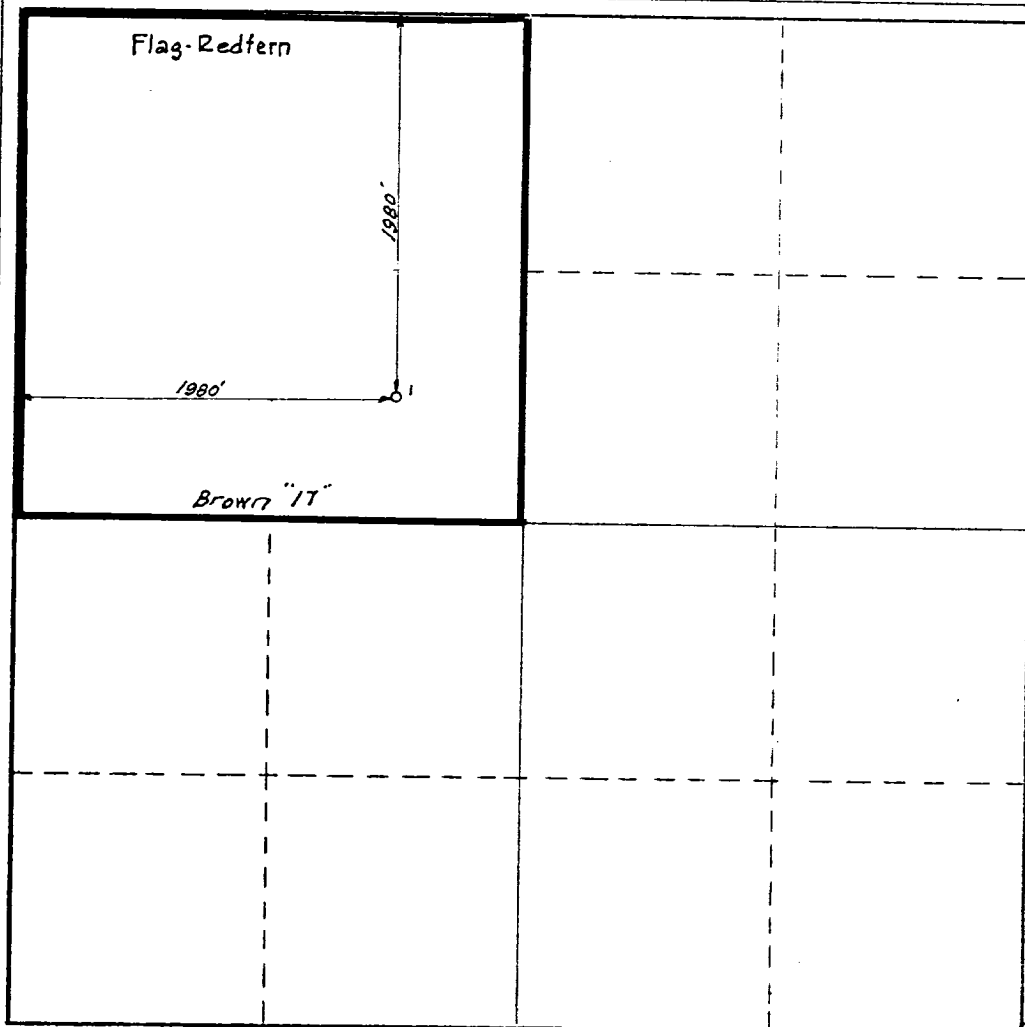

CERTIFICATION

I hereby certify that the information contained herein is true and complete to the best of my knowledge and belief.

Name *John A. Lunday*
 Position **Petroleum Engineer**
 Company **Flag-Redfern Oil Company**
 Date **January 17, 1975**

I hereby certify that the well location shown on this plat was plotted from field notes of actual surveys made by me or under my supervision, and that the same is true and correct to the best of my knowledge and belief.

Date Surveyed
January 15, 1975

Registered Professional Engineer
and/or Land Surveyor

Certificate No.

754

0 330 660 990 1320 1650 1980 2310 2640 2000 1500 1000 500