

NO. OF COPIES RECEIVED	
DISTRIBUTION	
SANTA FE	
FILE	
U.S.G.S.	
LAND OFFICE	
OPERATOR	

# NEW MEXICO OIL CONSERVATION COMMISSION

Form C-101  
Revised 1-1-65

5A. Indicate Type of Lease	
STATE <input checked="" type="checkbox"/>	FEE <input type="checkbox"/>
5. State Oil & Gas Lease No.	
LG - 1820	

## APPLICATION FOR PERMIT TO DRILL, DEEPEN, OR PLUG BACK

1a. Type of Work		7. Unit Agreement Name	
b. Type of Well DRILL <input checked="" type="checkbox"/> DEEPEN <input type="checkbox"/> PLUG BACK <input type="checkbox"/> OIL WELL <input checked="" type="checkbox"/> GAS WELL <input type="checkbox"/> OTHER <input type="checkbox"/> SINGLE ZONE <input checked="" type="checkbox"/> MULTIPLE ZONE <input type="checkbox"/>		8. Farm or Lease Name Maxie	
2. Name of Operator John L. Cox		9. Well No. 1	
3. Address of Operator Box 2217, Midland, Tx 79701		10. Field and Pool, or Wildcat N. Bagley (Penn.)	
4. Location of Well UNIT LETTER <u>A</u> LOCATED <u>660</u> FEET FROM THE <u>North</u> LINE AND <u>510</u> FEET FROM THE <u>East</u> LINE OF SEC. <u>1</u> TWP. <u>12S</u> RGE. <u>32E</u> NMPM		12. County Lea	
19. Proposed Depth 10,500		19A. Formation Penn.	
20. Rotary or C.T. Rotary		21. Elevations (Show whether DF, RT, etc.) 4314.7 Gr.	
21A. Kind & Status Plug. Bond Blanket		21B. Drilling Contractor Hondo Drilling Co.	
22. Approx. Date Work will start Feb. 16, 1976			

23.

## PROPOSED CASING AND CEMENT PROGRAM

SIZE OF HOLE	SIZE OF CASING	WEIGHT PER FOOT	SETTING DEPTH	SACKS OF CEMENT	EST. TOP
17½"	12 3/4"	33#	375'	400 sx.	Surface
11"	8 5/8"	24# and 32#	3800'	400 sx.	1850'
7"	4½"	11.6#&N-80	10,500'	300 sx.	8200'

BLOW OUT PROGRAM: SHAFFER 10" SERIES 900 BLOW OUT PREVENTOR,  
HYDRAULIC OPERATED, 300# WORKING PRESSURE.

APPROVAL VALID  
FOR 90 DAYS UNLESS  
DRILLING COMMENCED,

EXPIRES 5 4 76

IN ABOVE SPACE DESCRIBE PROPOSED PROGRAM: IF PROPOSAL IS TO DEEPEN OR PLUG BACK, GIVE DATA ON PRESENT PRODUCTIVE ZONE AND PROPOSED NEW PRODUCTIVE ZONE. GIVE BLOWOUT PREVENTER PROGRAM, IF ANY.

I hereby certify that the information above is true and complete to the best of my knowledge and belief.

Signed Martha Wittenbach Title Production Clerk Date February 2, 1976  
(This space for State Use)

APPROVED BY [Signature] TITLE  DATE

CONDITIONS OF APPROVAL, IF ANY:

NEW MEXICO OIL CONSERVATION COMMISSION  
WELL LOCATION AND ACREAGE DEDICATION PLAT

Form O-122  
Supersedes O-128  
Effective 12-65

All distances must be from the outer boundaries of the Section

John L. Cox			Lease MAXIE		Acres 1
A	1	12 South	32 East	Lea	
660 feet from the North line and 510 feet from the East line					
4314.7	Lower Penn.	North Bagley (Penn.)		80	Acres

1. Outline the acreage dedicated to the subject well by colored pencil or hatchure marks on the plat below.
2. If more than one lease is dedicated to the well, outline each and identify the ownership thereof (both as to working interest and royalty).
3. If more than one lease of different ownership is dedicated to the well, have the interests of all owners been consolidated by communitization, unitization, force-pooling, etc?

☐ Yes ☐ No If answer is "yes," type of consolidation \_\_\_\_\_

If answer is "no," list the owners and tract descriptions which have actually been consolidated. (Use reverse side of this form if necessary.) \_\_\_\_\_

No allowable will be assigned to the well until all interests have been consolidated (by communitization, unitization, forced-pooling, or otherwise) or until a non-standard unit, eliminating such interests, has been approved by the Commission.

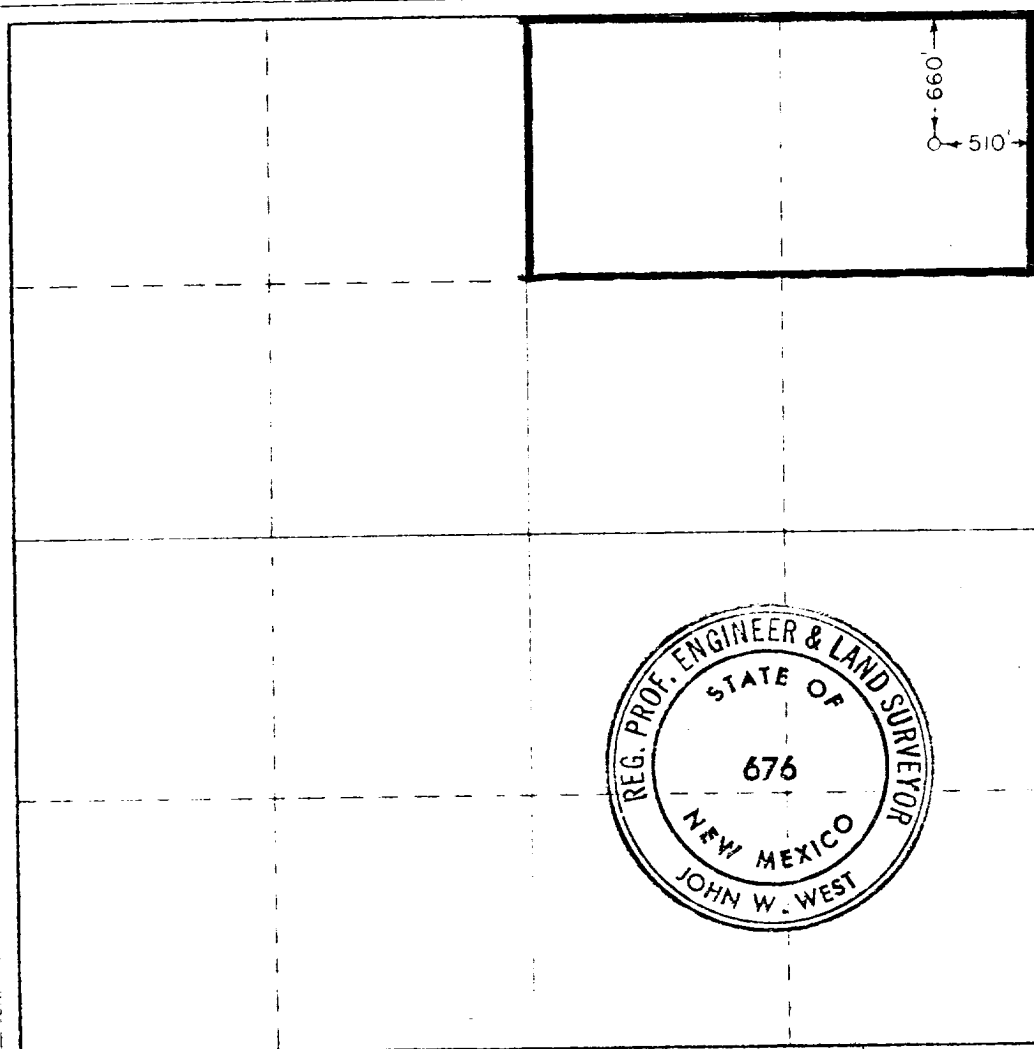

CERTIFICATION

I hereby certify that the information contained herein is true and complete to the best of my knowledge and belief.

*Martha Wittenbach*

Name  
Martha Wittenbach

Position  
Production Clerk

Company  
John L. Cox

Date  
February 2, 1976

I hereby certify that the well location shown on this plat was plotted from field notes of actual surveys made by me or under my supervision, and that the same is true and correct to the best of my knowledge and belief.

Date Surveyed  
December 18, 1974

Registered Professional Engineer and Land Surveyor

*John W. West*  
Certificate No. 676

0 330 660 990 1320 1650 1980 2310 2640 2970 3300 3630 3960 4290 4620 4950 5280 5610 5940 6270 6600