

NO. OF COPIES RECEIVED	
DISTRIBUTION	
SANTA FE	
FILE	
U.S.G.S.	
LAND OFFICE	
OPERATOR	

NEW MEXICO OIL CONSERVATION COMMISSION

Form C-101
Revised 1-1-65

5A. Indicate Type of Lease	
STATE <input checked="" type="checkbox"/>	FEE <input type="checkbox"/>
5. State Oil & Gas Lease No.	

APPLICATION FOR PERMIT TO DRILL, DEEPEN, OR PLUG BACK

1a. Type of Work		7. Unit Agreement Name	
b. Type of Well DRILL <input checked="" type="checkbox"/> DEEPEN <input type="checkbox"/> PLUG BACK <input type="checkbox"/> OIL WELL <input checked="" type="checkbox"/> GAS WELL <input type="checkbox"/> OTHER <input type="checkbox"/> SINGLE ZONE <input type="checkbox"/> MULTIPLE ZONE <input type="checkbox"/>		8. Farm or Lease Name Penn, 7504 JV-D	
2. Name of Operator BTA Oil Producers		9. Well No. 2	
3. Address of Operator 104 South Pecos, Midland, Texas 79701		10. Field and Pool or Wildcat Bagley, North (Penn)	
4. Location of Well UNIT LETTER "H" LOCATED 1880 FEET FROM THE North LINE AND 560 FEET FROM THE East LINE OF SEC. 7 TWP. 12-S RGE. 33-E NMPM		12. County Lea	
21. Elevations (Show whether DT, KT, etc.) 4283' GL		19. Proposed Depth 10,500'	19A. Formation Pennsylvanian
21A. Kind & Status Plug. Bond Blanket on file	21B. Drilling Contractor Hondo Drilling	20. Rotary or C.T. Rotary	
22. Approx. Date Work will start Upon Approval			

PROPOSED CASING AND CEMENT PROGRAM

SIZE OF HOLE	SIZE OF CASING	WEIGHT PER FOOT	SETTING DEPTH	SACKS OF CEMENT	EST. TOP
17 1/2"	12-3/4"	42#	385'	400	Circ.
11"	8-5/8"	24 & 28#	3725'	450'	
7-7/8"	5 1/2"	17#	10500'	800	

APPROVAL VALID
FOR 90 DAYS UNLESS
DRILLING COMMENCED,
EXPIRES NOV. 5, 1975

IN ABOVE SPACE DESCRIBE PROPOSED PROGRAM: IF PROPOSAL IS TO DEEPEN OR PLUG BACK, GIVE DATA ON PRESENT PRODUCTIVE ZONE AND PROPOSED NEW PRODUCTIVE ZONE. GIVE BLOWOUT PREVENTER PROGRAM, IF ANY.

I hereby certify that the information above is true and complete to the best of my knowledge and belief.

Signed Bob Newland Title Regulatory Supervisor Date 8/4/75

(This space for State Use)

APPROVED BY John W. Runyan TITLE Commissioner DATE AUG 5, 1975

CONDITIONS OF APPROVAL, IF ANY:

RECEIVED

700 E 175

U.S. CONSERVATION COMMISSION
HONOLULU, HAWAII

NEW MEXICO OIL CONSERVATION COMMISSION
WELL LOCATION AND ACREAGE DEDICATION PLAT

Form C-102
 Supersedes C-128
 Effective 1-1-65

All distances must be from the outer boundaries of the Section.

Operator BTA OIL PRODUCERS			Lease 7504 JV-D, "PENN"		Well No. 2
Unit Letter "H"	Section 7	Township 12-S	Range 33-E	County LEA	
Actual Footage Location of Well: <div style="display: flex; justify-content: space-between;"> 1880 feet from the NORTH line and 560 feet from the EAST line </div>					
Ground Level Elev. 4283	Producing Formation PENNSYLVANIAN	Pool BAGLEY, N., (PENN)		Dedicated Acreage: 80 Acres	

1. Outline the acreage dedicated to the subject well by colored pencil or hachure marks on the plat below.
2. If more than one lease is dedicated to the well, outline each and identify the ownership thereof (both as to working interest and royalty).
3. If more than one lease of different ownership is dedicated to the well, have the interests of all owners been consolidated by communitization, unitization, force-pooling, etc?

☐ Yes ☐ No If answer is "yes," type of consolidation _____

If answer is "no," list the owners and tract descriptions which have actually been consolidated. (Use reverse side of this form if necessary.) _____

No allowable will be assigned to the well until all interests have been consolidated (by communitization, unitization, forced-pooling, or otherwise) or until a non-standard unit, eliminating such interests, has been approved by the Commission.

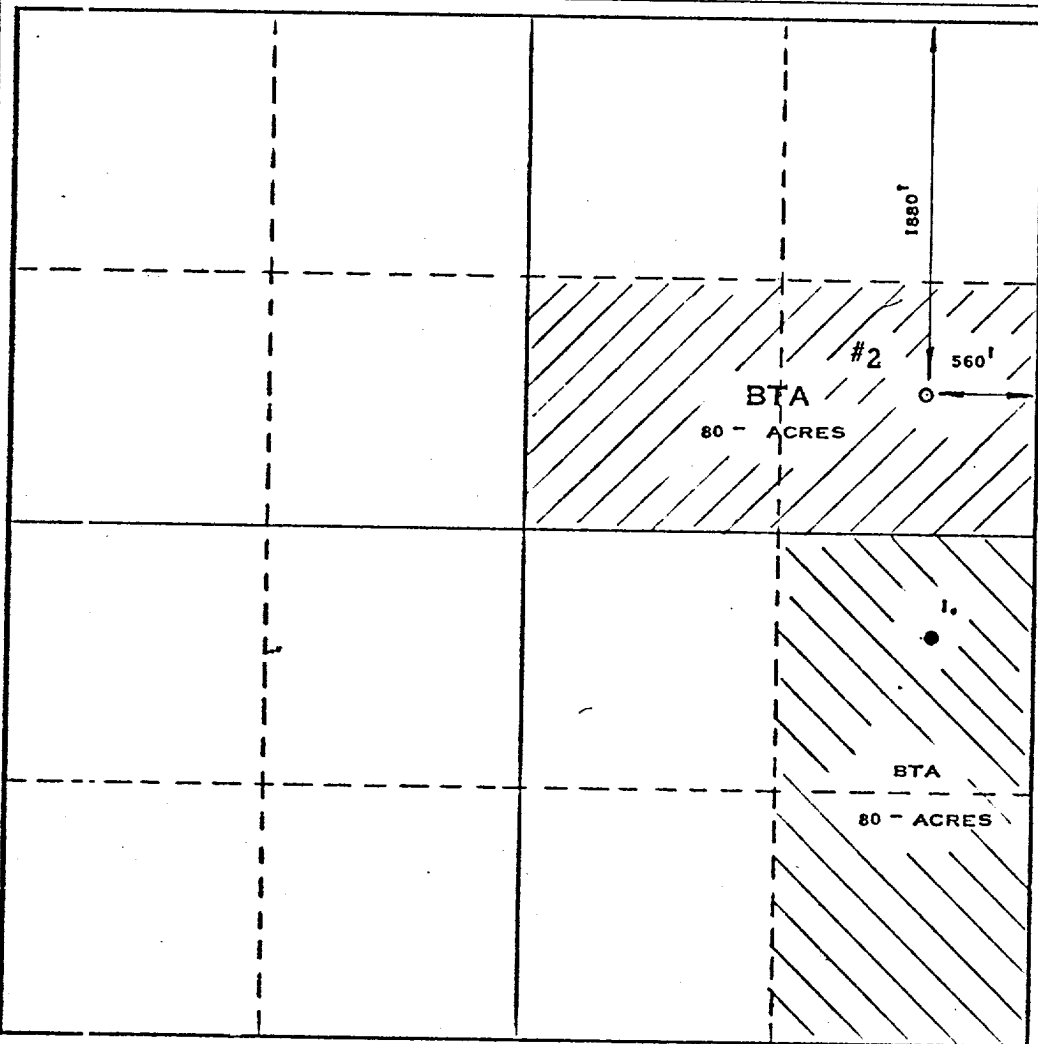

CERTIFICATION

I hereby certify that the information contained herein is true and complete to the best of my knowledge and belief.

Name **Bob Newland**
 Position **Regulatory Supervisor**
 Company **BTA Oil Producers**
 Date **8/4/75**

I hereby certify that the well location shown on this plat was plotted from field notes of actual surveys made by me or under my supervision, and that the same is true and correct to the best of my knowledge and belief.

Date Surveyed **JULY 30, 1975**
 Registered Professional Engineer and Land Surveyor
Max A. Schumann Jr.
MAX A SCHUMANN JR

Certificate No.

1510

RECEIVED

AUG 5 1975

OIL CONSERVATION COMM.
HOBBBS, N. M.