

NO. OF COPIES RECEIVED	
DISTRIBUTION	
SANTA FE	
FILE	
U.S.G.S.	
LAND OFFICE	
OPERATOR	

# NEW MEXICO OIL CONSERVATION COMMISSION

Form C-101  
Revised 1-1-65

5A. Indicate Type of Lease	
STATE <input checked="" type="checkbox"/>	FEE <input type="checkbox"/>
5. State Oil & Gas Lease No.	

## APPLICATION FOR PERMIT TO DRILL, DEEPEN, OR PLUG BACK

1a. Type of Work		7. Unit Agreement Name	
b. Type of Well DRILL <input checked="" type="checkbox"/> DEEPEN <input type="checkbox"/> PLUG BACK <input type="checkbox"/> OIL WELL <input checked="" type="checkbox"/> GAS WELL <input type="checkbox"/> OTHER <input type="checkbox"/> SINGLE ZONE <input type="checkbox"/> MULTIPLE ZONE <input type="checkbox"/>		8. Farm or Lease Name Penn, 7504 JV-D	
2. Name of Operator BTA OIL PRODUCERS		9. Well No. 3	
3. Address of Operator 104 South Pecos Midland, Texas 79701		10. Field and Pool, or Subpart Bagley, North (Penn)	
4. Location of Well UNIT LETTER "G" LOCATED 1830 FEET FROM THE North LINE AND 1980 FEET FROM THE East LINE OF SEC. 7 TWP. 12-S RGE. 33-E NMPM		12. County Lea	
19. Proposed Depth 10,500		19A. Formation Pennsylvanian	20. Rotary or C.T. Rotary
21. Elevations (Show whether DT, RI, etc.) 4295' GL	21A. Kind & Status Plug. Bond Blanket on File	21B. Drilling Contractor Hondo Drilling Co.	22. Approx. Date Work will start Upon Approval

## PROPOSED CASING AND CEMENT PROGRAM

SIZE OF HOLE	SIZE OF CASING	WEIGHT PER FOOT	SETTING DEPTH	SACKS OF CEMENT	EST. TOP
17-1/2"	12-3/4"	42#	385'	400	circ.
11"	8-5/8"	24&28#	3,725'	450	
7-7/8"	5-1/2"	17#	10,500'	800	

APPROVAL VALID  
FOR 90 DAYS UNLESS  
DRILLING COMMENCED,

EXPIRES Jan 3, 1976

IN ABOVE SPACE DESCRIBE PROPOSED PROGRAM: IF PROPOSAL IS TO DEEPEN OR PLUG BACK, GIVE DATA ON PRESENT PRODUCTIVE ZONE AND PROPOSED NEW PRODUCTIVE ZONE. GIVE BLOWOUT PREVENTER PROGRAM, IF ANY.

I hereby certify that the information above is true and complete to the best of my knowledge and belief.

Signed Bob Newland Bob Newland Title Regulatory Supervisor Date 9/26/75

(This space for State Use)

APPROVED BY John R. Rung TITLE Regulatory Supervisor DATE Oct 1, 1975  
CONDITIONS OF APPROVAL, IF ANY:

## WELL LOCATION AND ACREAGE DEDICATION PLAT

Supersedes C-128  
Effective 1-1-65

All distances must be from the outer boundaries of the Section.

Operator <b>BTA OIL PRODUCERS</b>		Lease <b>7504 JV - D, "PENN"</b>		Well No. <b>3</b>
Unit Letter <b>"G"</b>	Section <b>7</b>	Township <b>12 - S</b>	Range <b>33 - E</b>	County <b>LEA</b>
Actual Footage Location of Well: <b>1830</b> feet from the <b>NORTH</b> line and <b>1980</b> feet from the <b>EAST</b> line				
Ground Level Elev. <b>4295</b>	Producing Formation <b>PENNSYLVANIAN</b>	Pool <b>BAGLEY, N., (PENN.)</b>	Dedicated Acreage: <b>80</b> Acres	

1. Outline the acreage dedicated to the subject well by colored pencil or hachure marks on the plat below.
2. If more than one lease is dedicated to the well, outline each and identify the ownership thereof (both as to working interest and royalty).
3. If more than one lease of different ownership is dedicated to the well, have the interests of all owners been consolidated by communitization, unitization, force-pooling, etc?

☐ Yes ☐ No If answer is "yes," type of consolidation \_\_\_\_\_

If answer is "no," list the owners and tract descriptions which have actually been consolidated. (Use reverse side of this form if necessary.) \_\_\_\_\_

No allowable will be assigned to the well until all interests have been consolidated (by communitization, unitization, forced-pooling, or otherwise) or until a non-standard unit, eliminating such interests, has been approved by the Commission.

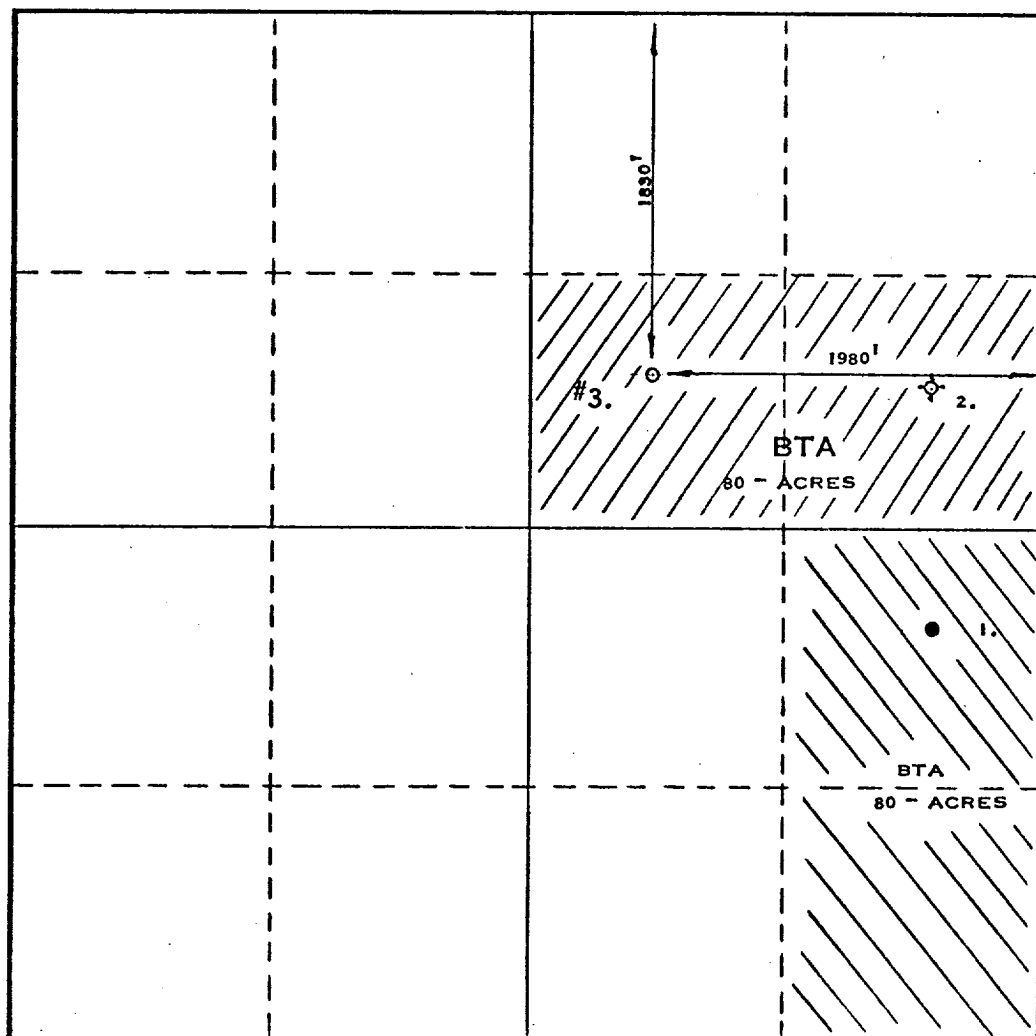

## CERTIFICATION

I hereby certify that the information contained herein is true and complete to the best of my knowledge and belief.

*Bob Newland*

Name

Bob Newland

Position

Regulatory Supervisor

Company

BTA OIL PRODUCERS

Date

September 25, 1975

I hereby certify that the well location shown on this plat was plotted from field notes of actual surveys made by me or under my supervision, and that the same is true and correct to the best of my knowledge and belief.

SEPTEMBER 24, 1975

Date Surveyed

Registered Professional Engineer  
and/or Land Surveyor*Max A. Schumann, Jr.*  
MAX A. SCHUMANN, JR.

Certificate No.

1510