

UNITED STATES
DEPARTMENT OF THE INTERIOR
GEOLOGICAL SURVEY

30-025-25296

APPLICATION FOR PERMIT TO DRILL, DEEPEN, OR PLUG BACK

1a. TYPE OF WORK

DRILL ☒

DEEPEN ☐

PLUG BACK ☐

5. LEASE DESIGNATION AND SERIAL NO.

LC-065151

6. IF INDIAN, ALLOTTEE OR TRIBE NAME

7. UNIT AGREEMENT NAME

8. FARM OR LEASE NAME

Bilbrey "23"

9. WELL NO.

6

10. FIELD AND POOL, OR WILDCAT

W. Sawyer, San Andres

11. SEC. T., R., M., OR BLK. AND SURVEY OR AREA

Sec. 23, T9S, R37E

12. COUNTY OR PARISH 13. STATE

Lea

New Mexico

b. TYPE OF WELL

OIL WELL ☒

GAS WELL ☐

OTHER

SINGLE ZONE ☐

MULTIPLE ZONE ☐

2. NAME OF OPERATOR

Flag-Redfern Oil Company

3. ADDRESS OF OPERATOR

P. O. Box 23, Midland, Texas 79701

4. LOCATION OF WELL (Report location clearly and in accordance with any State requirements*)

At surface

800' FEL & 800' FSL

At proposed prod. zone

Same

14. DISTANCE IN MILES AND DIRECTION FROM NEAREST TOWN OR POST OFFICE*

15 miles east of Crossroads, New Mexico

15. DISTANCE FROM PROPOSED*

LOCATION TO NEAREST PROPERTY OR LEASE LINE, FT. (Also to nearest drlg. unit line, if any)

800'

16. NO. OF ACRES IN LEASE

240

17. NO. OF ACRES ASSIGNED TO THIS WELL

4880

18. DISTANCE FROM PROPOSED LOCATION* TO NEAREST WELL, DRILLING, COMPLETED, OR APPLIED FOR, ON THIS LEASE, FT.

1180'

19. PROPOSED DEPTH

5100'

20. ROTARY OR CABLE TOOLS

Rotary

21. ELEVATIONS (Show whether DF, RT, GR, etc.)

3960' GR

22. APPROX. DATE WORK WILL START*

June 10, 1976

23. PROPOSED CASING AND CEMENTING PROGRAM

SIZE OF HOLE	SIZE OF CASING	WEIGHT PER FOOT	SETTING DEPTH	QUANTITY OF CEMENT
12-1/4"	8-5/8"	24# K-55	350'	250 sx
7-7/8"	4-1/2"	10.6# H-40	5100'	250 sx

Drill 12 1/4" hole from surface to 350'. Run and set 8-5/8" casing, circulate cement to surface with 250 sx Class "H", 2% CaCl2. Drill 7-7/8" hole to approximately 5100'. Run open hole logs. Run 4 1/2", 10.60#, H-40 production casing, cement with 250 sx Class "H", 2% gel, 0.75% CFR-2, and 8 lbs salt per sack. Run correlation logs and perforate San Andres. Treat with acid. Swab to test. Potential well.

Mud Program: 0- 350' Native Mud
350-4850' Native Mud & Oil
4850-T.D. Starch, Oil Emulsion

Blowout Preventer: Shaffer 10" - Series 900 - Installed on surface pipe.

IN ABOVE SPACE DESCRIBE PROPOSED PROGRAM: If proposal is to deepen or plug back, give data on present productive zone and proposed new productive zone. If proposal is to drill or deepen directionally, give pertinent data on subsurface locations and measured and true vertical depths. Give blowout preventer program, if any.

24. SIGNED Arthur R. Brown TITLE Petroleum Engineer DATE May 6, 1976

(This space for Federal or State office use)

PERMIT NO.

APPROVAL DATE

APPROVED BY

TITLE

CONDITIONS OF APPROVAL, IF ANY:

APPROVED
AS AMENDED
JUN 7 1976
ARTHUR R. BROWN
DISTRICT ENGINEER

**NEW MEXICO OIL CONSERVATION COMMISSION
WELL LOCATION AND ACREAGE DEDICATION PLAT**

Form C-102
Supersedes C-128
Effective 1-1-65

All distances must be from the outer boundaries of the Section.

Operator Flag-Redfern Oil Company			Lease Bilbrey "23"		Well No. 6
Unit Letter P	Section 23	Township 9S	Range 37E	County Lea	
Actual Footage Location of Well: <div style="display: flex; justify-content: space-between; align-items: center;"> 800 feet from the East line and 800 feet from the South line </div>					
Ground Level Elev. 3960'	Producing Formation San Andres		Pool West Sawyer		Dedicated Acreage: 10 80 Acres

1. Outline the acreage dedicated to the subject well by colored pencil or hachure marks on the plat below.
2. If more than one lease is dedicated to the well, outline each and identify the ownership thereof (both as to working interest and royalty).
3. If more than one lease of different ownership is dedicated to the well, have the interests of all owners been consolidated by communitization, unitization, force-pooling, etc?

☐ Yes ☐ No If answer is "yes," type of consolidation _____

If answer is "no," list the owners and tract descriptions which have actually been consolidated. (Use reverse side of this form if necessary.) _____

No allowable will be assigned to the well until all interests have been consolidated (by communitization, unitization, forced-pooling, or otherwise) or until a non-standard unit, eliminating such interests, has been approved by the Commission.

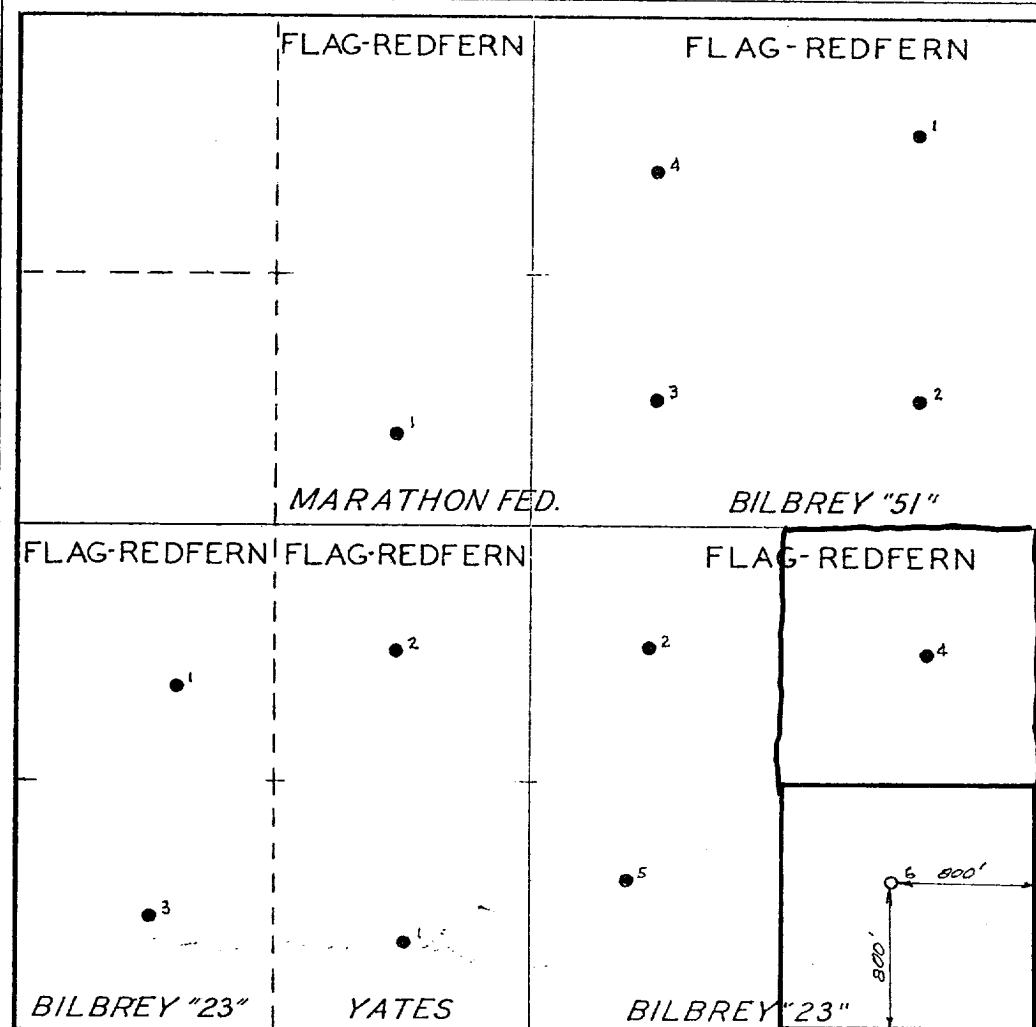

CERTIFICATION

I hereby certify that the information contained herein is true and complete to the best of my knowledge and belief.

Name *John H. Sawyer*
Position _____

Petroleum Engineer

Company
Flag-Redfern Oil Company

Date
May 6, 1976

I hereby certify that the well location shown on this plat was plotted from field notes of actual surveys made by me or under my supervision, and that the same is true and correct to the best of my knowledge and belief.

Date Surveyed
May 4, 1976

Registered Professional Engineer and/or Land Surveyor

Certificate No. *754*



Flag-Redfern Oil Company

P. O. BOX 23•MIDLAND, TEXAS 79701•410 WALL TOWERS WEST•PHONE (915) 683-5184

May 6, 1976

FILE:

U. S. Department of Interior
Geological Survey
P. O. Box 1157
Hobbs, New Mexico 88240

Attention: Mr. Arthur Brown

Re: Flag-Redfern Oil Company
Bilbrey "23" No. 6
Section 23, T-9-S, R-37-E
Lea County, New Mexico

Gentlemen:

The following is a Development Plan for Surface Use as required to accompany application to drill the captioned well:

1. State Highway 125 from Tatum, New Mexico to Bledsoe, Texas crosses Section 24 one mile east of the captioned location. Existing caliche lease roads provide access to the south-eastern portion of Section 23.
2. The existing road will be extended from Well No. 5 east 1320'.
3. Additional lateral roads in Section 23 will be required if development proceeds in this section.
4. The planned access road will be the only road into the lease.
5. It is anticipated that production from this well will be pumped to the existing tank battery, located west of the No. 1 well.
6. There is no known supply of drilling water in the immediate area, and we consequently plan to haul drilling water into this location.
7. All solid waste from the drilling operation will be either buried or hauled away. Trash and junk will be buried in a separate pit.
8. Produced brine water will be stored in tanks and be trucked by permit into an approved subsurface disposal zone.

RECEIVED

2011-11-19

CONSULTATION COMMISSION
H. M.

U. S. Department of Interior
May 6, 1976
Page Two

9. Casinghead gas will be contracted to Cities Service Gas Company.
10. Location layout and rig plan are detailed on the attached development plat.
11. Should this be a dry hole, the pits will be filled and the surface restored as near as possible to the original contours. Should this well produce, pits will be filled and leveled and the pad maintained during the life of production.

Please advise if we can furnish any additional information that you might desire.

Yours very truly,

A handwritten signature in dark ink, appearing to read "John H. Swendig". The signature is fluid and cursive, with the first name "John" being the most prominent.

John H. Swendig
Petroleum Engineer

JHS:ss

Attachments

RECEIVED

JUN 1 197

U.S. CONSERVATION COMMISSION
W. H. M.

Lea Co., New Mexico
SCALE: 1" = 2000'

R-37-E

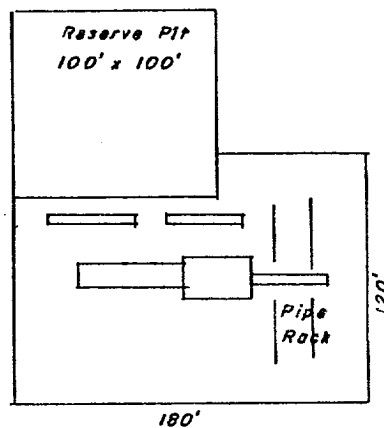
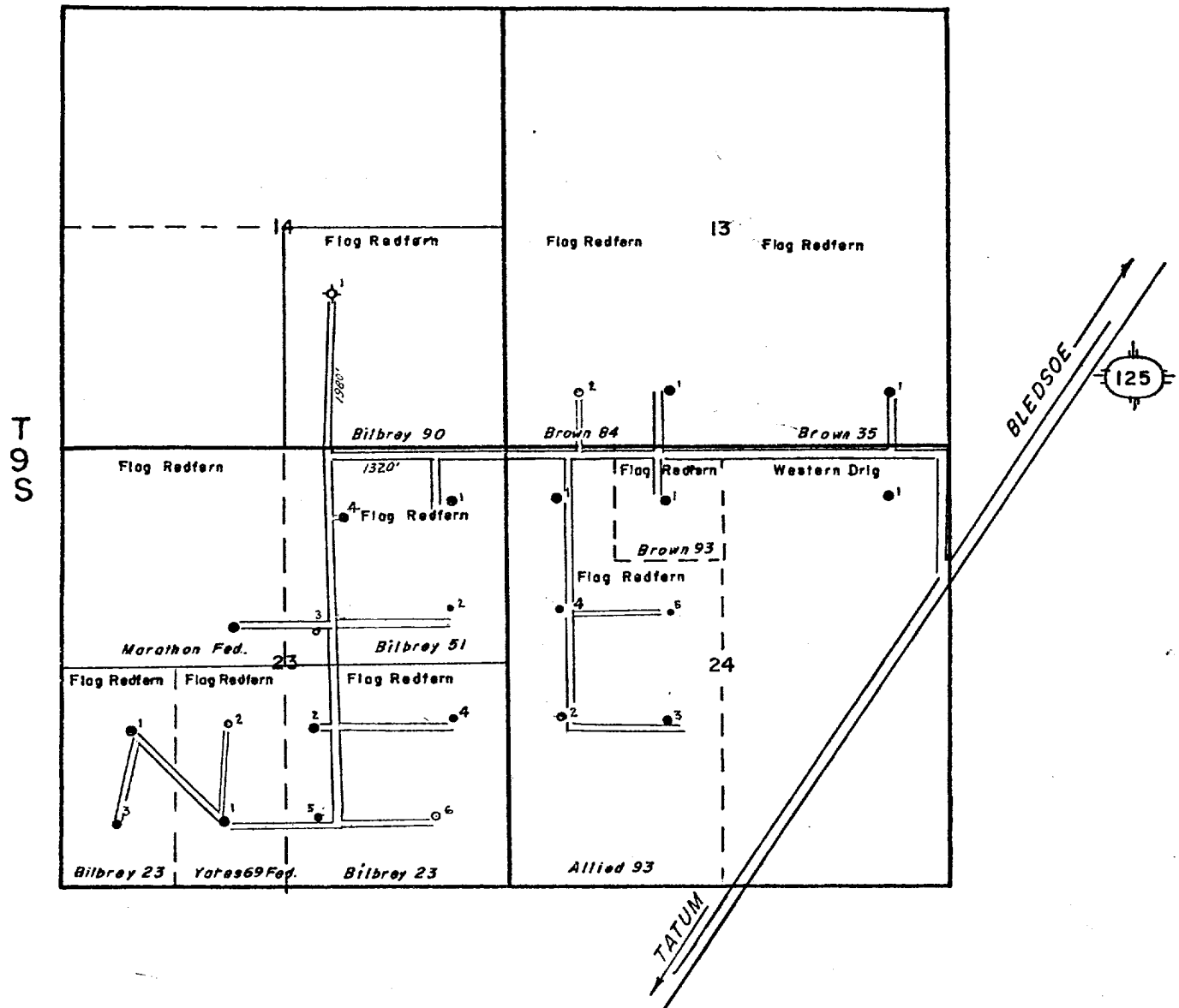

PAD DETAIL

U. S. GEOLOGICAL SURVEY
P. O. Box 1157
Hobbs, New Mexico 88240

HOBBS DISTRICT

Flag Redfern Oil Co.
No. 6 Bilbrey "23"
NE $\frac{1}{4}$ SE $\frac{1}{4}$ sec. 23-9S-37E
Lea County, N. M.

Above Data Required on Well Sign

CONDITIONS OF APPROVAL

1. Drilling operations authorized are subject to the attached sheet for general requirements for drilling and producing operations.
2. Notify this office (telephone (505) 393-3612) when the well is spudded and in sufficient time for a representative to witness cementing operations.
3. Immediate notice is required of all blowouts, fires, spills, and accidents involving life-threatening injuries or loss of life.
4. Secure prior approval before changing the approved drilling program or commencing plugging operations, plug-back work, casing repair work, or corrective cementing operations.
5. Blowout prevention equipment is to be installed, tested, and in working order before drilling below the surface casing and shall be maintained ready for use until drilling operations are completed.
6. A kill-line is to be properly installed and is not to be used as a fill-up line.
7. Blowout preventers are to have proper casing rams when running casing.
8. Drill string safety valve(s) to fit all pipe in the drill string to be maintained on the rig floor while drilling operations are in progress.
9. Blowout prevention drills are to be conducted as necessary to assure that equipment is operational and that each crew is properly trained to carry out emergency duties. All BOP tests and drills are to be recorded on the driller's log.
10. Operations must be in compliance with the provisions of the landowner agreement concerning surface disturbance and surface restoration.
11. 8-5/8" surface casing should be set in the Rustler Anhydrite formation and cement circulated to the surface. If surface casing is set at a lesser depth, the 4 $\frac{1}{2}$ " casing must be cemented from the casing shoe to the surface or cemented to the surface through a stage tool set at least 50 feet below the top of the Rustler, after cementing around the shoe with the required amount of cement.

RECEIVED
JUN 1 197
LEGISLATION COMM.
U. S. M.