

| | |
|------------------------|--|
| NO. OF COPIES RECEIVED | |
| DISTRIBUTION | |
| SANTA FE | |
| FILE | |
| U.S.G.S. | |
| LAND OFFICE | |
| OPERATOR | |

NEW MEXICO OIL CONSERVATION COMMISSION

Form C-101
Revised 1-1-65

| | |
|--------------------------------|---|
| 5A. Indicate Type of Lease | |
| STATE <input type="checkbox"/> | FEE <input checked="" type="checkbox"/> |
| 5. State Oil & Gas Lease No. | |

APPLICATION FOR PERMIT TO DRILL, DEEPEN, OR PLUG BACK

| | | | |
|--|--|---|--|
| 1a. Type of Work | | 7. Unit Agreement Name | |
| b. Type of Well OIL WELL <input checked="" type="checkbox"/> GAS WELL <input type="checkbox"/> OTHER <input type="checkbox"/> | | 8. Farm or Lease Name SFPRR | |
| 2. Name of Operator Oil Development Company of Texas | | 9. Well No. 20 | |
| 3. Address of Operator P. O. Box 12058, Amarillo, Texas 79101 | | 10. Field and Pool, or Wildcat West Sawyer (San Andres) | |
| 4. Location of Well UNIT LETTER C LOCATED 1980 FEET FROM THE West LINE AND 660 FEET FROM THE North LINE OF SEC. 34 TWP. 9S RGE. 37E N.M.P.M. | | 12. County Lea | |
| 19. Proposed Depth 5100 | | 19A. Formation San Andres | |
| 20. Rotary or C.T. Rotary | | 21. Elevations (Show whether D.F., R.T., etc.) 3967.3 G.R. | |
| 21A. Kind & Status Plug, Bond \$10,000 blanket-active | | 21B. Drilling Contractor N/A | |
| 22. Approx. Date Work will start 11-1-76 | | | |

PROPOSED CASING AND CEMENT PROGRAM

| SIZE OF HOLE | SIZE OF CASING | WEIGHT PER FOOT | SETTING DEPTH | SACKS OF CEMENT | EST. TOP |
|--------------|----------------|-----------------|---------------|-----------------|----------|
| 12-1/4" | 8-5/8" | 24 | 420 | 330 | Circ |
| 7-7/8" | 5-1/2" | 15.5 | 5100 | 250 | 3750 |

Plan to use double-ram hydraulic blow-out preventer after setting 8-5/8" surface pipe.

APPROVAL VALID
FOR 90 DAYS UNLESS
DRILLING COMMENCED,
EXPIRES Dec 21, 1976

IN ABOVE SPACE DESCRIBE PROPOSED PROGRAM; IF PROPOSAL IS TO DEEPEN OR PLUG BACK, GIVE DATA ON PRESENT PRODUCTIVE ZONE AND PROPOSED NEW PRODUCTIVE ZONE. GIVE BLOWOUT PREVENTER PROGRAM, IF ANY.

I hereby certify that the information above is true and complete to the best of my knowledge and belief.

Signed D.T. Stogner, Jr. Title Drilling Superintendent Date September 13, 1976
(This space for State Use)

APPROVED BY [Signature] TITLE SURVEILLANCE DISTRICT I DATE SEP 23 1976
CONDITIONS OF APPROVAL, IF ANY: One string of casing must be cemented from the top of the anhydrite to the surface as per attached letter.

**NEW MEXICO OIL CONSERVATION COMMISSION
WELL LOCATION AND ACREAGE DEDICATION PL**

Form C-102
Supersedes C-128
Effective 1-1-65

All distances must be from the outer boundaries of the Section

| | | | | | |
|--|--|----------------------------|-------------------------|-------------------------------------|-----------------------|
| Operator OIL DEVELOPMENT CO. OF TEXAS | | | Lease SFPRR | | Well No. 20 |
| Well Letter C | Section 34 | Township 9 SOUTH | Range 37 EAST | County LEA | |
| Actual Surface Location of Well: <div style="display: flex; justify-content: space-between;"> 660 feet from the NORTH line and 1980 feet from the WEST line </div> | | | | | |
| Ground Level Elev. 3967.3 | Producing Formation San Andres | Pool Slaughter | | Tested at A. (gallons) 40 | |

1. Outline the acreage dedicated to the subject well by colored pencil or hatchure marks on the plat below.
2. If more than one lease is dedicated to the well, outline each and identify the ownership thereof (both as to working interest and royalty).
3. If more than one lease of different ownership is dedicated to the well, have the interests of all owners been consolidated by communitization, unitization, force-pooling, etc?

☐ Yes ☐ No If answer is "yes," type of consolidation _____

If answer is "no," list the owners and tract descriptions which have actually been consolidated. (Use reverse side of this form if necessary.) _____

No allowable will be assigned to the well until all interests have been consolidated (by communitization, unitization, forced-pooling, or otherwise) or until a non-standard unit, eliminating such interests, has been approved by the Commission.

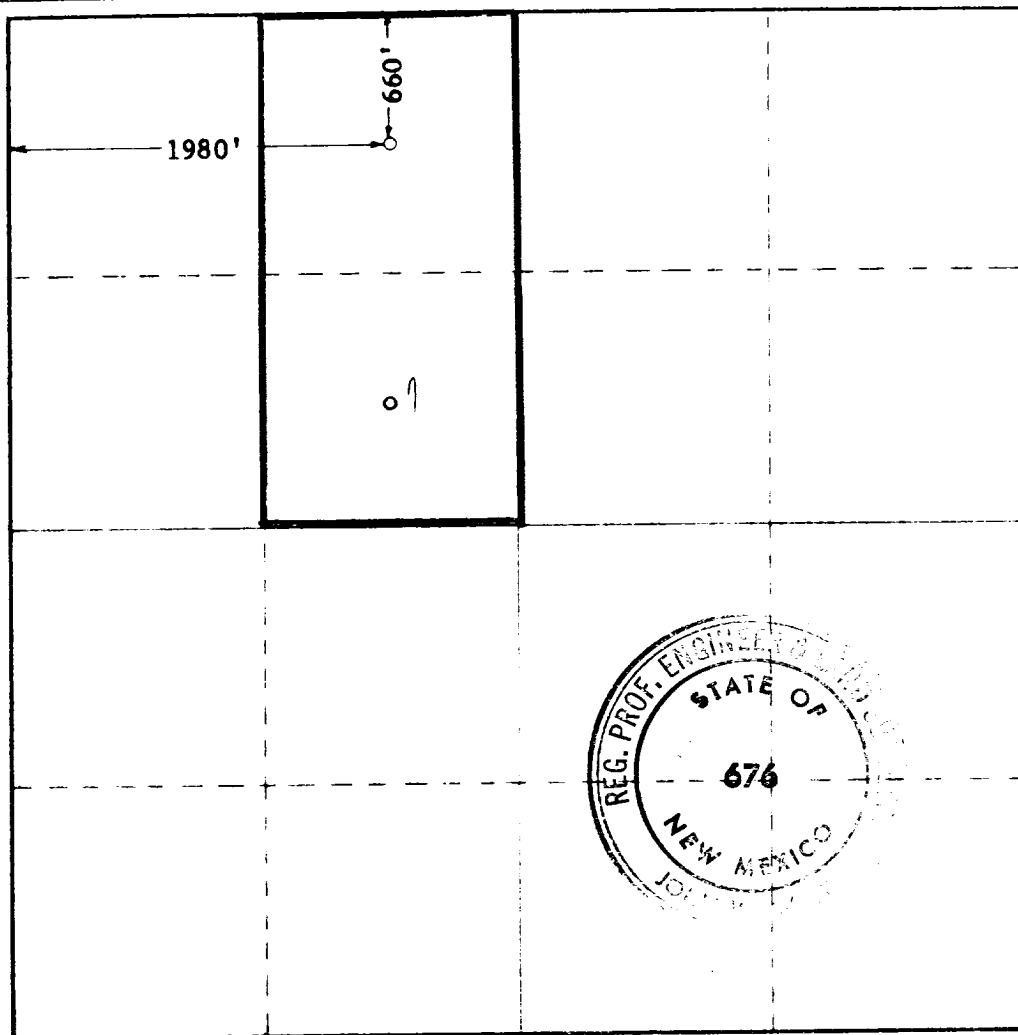

CERTIFICATION

I hereby certify that the information contained herein is true and complete to the best of my knowledge and belief.

C. Brad Crouch
Name

C. Brad Crouch

Position

Petroleum Engineer

Company

Oil Development Co. of Tex

Date

9-20-76

I hereby certify that the well location shown on this plat was plotted from field notes of actual surveys made by me or under my supervision, and that the same is true and correct to the best of my knowledge and belief.

Date surveyed

9-5-1976

Registered Professional Engineer
and/or Land Surveyor

John W. West
Certificate No. **676**

0 330 660 990 1320 1650 1980 2310 2640 2000 1500 1000 500 0