

NEW MEXICO OIL CONSERVATION COMMISSION
WELL LOCATION AND ACREAGE DEDICATION PLAT

Form C-102
Supersedes C-128
Effective 1-1-65

All distances must be from the outer boundaries of the Section

Operator Morris R. Antweil			Lease Landlady		Well No. 1
Unit Letter B	Section 8	Township 12 South	Range 32 East	County Lea	
Actual Footage Location of Well: 660 feet from the North line and 1980 feet from the East line					
Ground Level Elev. 4402.9	Producing Formation Morrow	Pool Wildcat		Dedicated Acreage 320 Acres	

1. Outline the acreage dedicated to the subject well by colored pencil or hatchure marks on the plat below.
2. If more than one lease is dedicated to the well, outline each and identify the ownership thereof (both as to working interest and royalty). See Reverse Side.
3. If more than one lease of different ownership is dedicated to the well, have the interests of all owners been consolidated by communitization, unitization, force-pooling, etc?

☐ Yes ☒ No If answer is "yes," type of consolidation to be communitized

If answer is "no," list the owners and tract descriptions which have actually been consolidated. (Use reverse side of this form if necessary.)

No allowable will be assigned to the well until all interests have been consolidated (by communitization, unitization, forced-pooling, or otherwise) or until a non-standard unit, eliminating such interests, has been approved by the Commission. Unorthodox location approved by Order No. R-5752

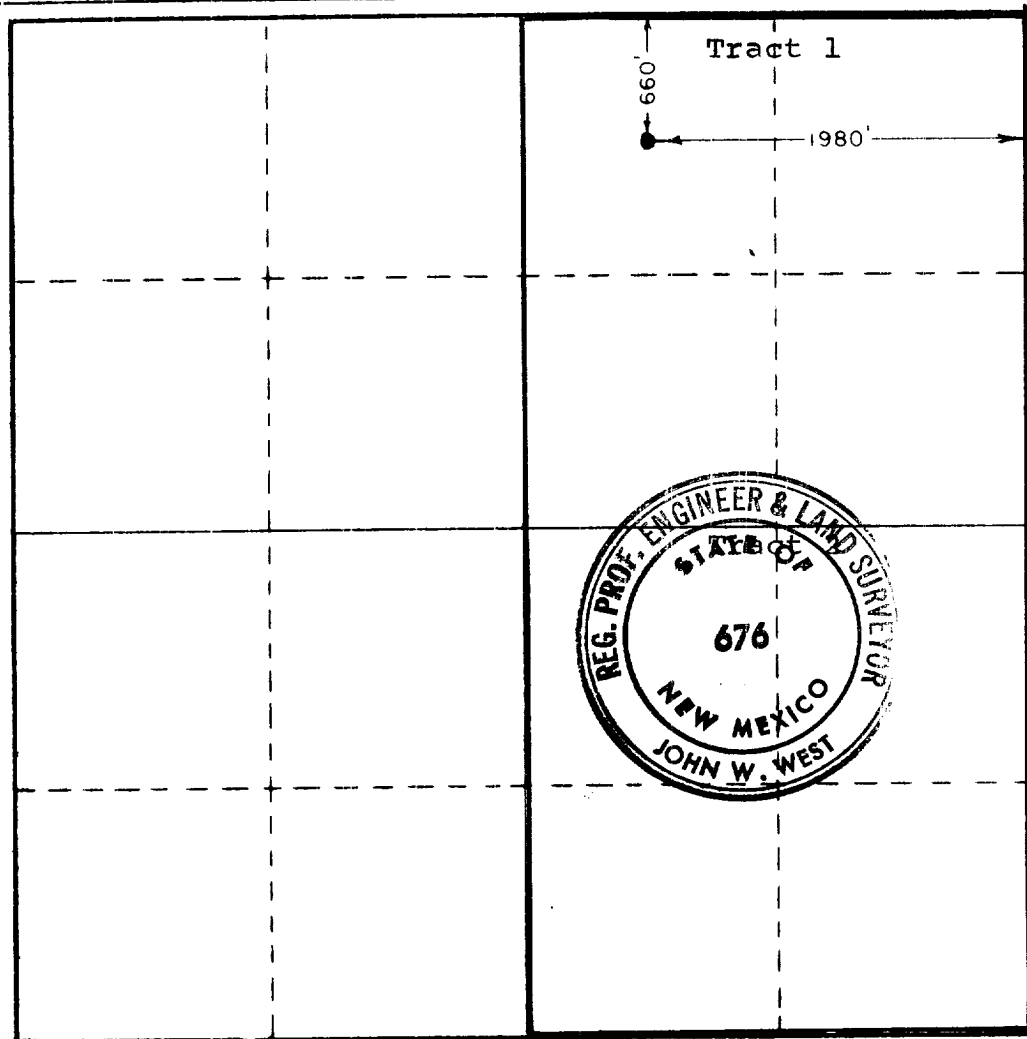

CERTIFICATION

I hereby certify that the information contained herein is true and complete to the best of my knowledge and belief.

Rm Williams

Name

R. M. Williams

Position

Agent

Company

Morris R. Antweil

Date

12 July, 1973

I hereby certify that the well location shown on this plat was plotted from field notes of actual surveys made by me or under my supervision, and that the same is true and correct to the best of my knowledge and belief.

Date Surveyed

5/12/78

Registered Professional Engineer and/or Land Surveyor

John W. West

Certificate No. **John W. West**

676

Ronald J. Eidson

3239

0 330 660 990 1320 1650 1980 2310 2640 2970 3300 3630 3960 4290 4620 4950 5280 5610 5940 6270 6600

Tract 1 - NE/4 - State Lease No. L-2775

Lessee of Record: C & K Petroleum, Inc.

Working Interest Owners: Antweil-50%

Petroleum Corp. of Delaware-50%

Tract 2 - SE/4 - State Lease No. L-6528

Lessee of Record: Sabine Production Company

Working Interest Owners: Antweil - 50%

Petroleum Corp. of Delaware - 50%

RECEIVED

JUL 18 1978

OIL CONSERVATION COMM.
DOBB, N. M.