

NEW MEXICO OIL CONSERVATION COMMISSION
WELL LOCATION AND ACREAGE DEDICATION PLAT

Form O-101
Supersedes O-128
Effective 1-1-65

All distances must be from the outer boundaries of the Section

Owner Estoril Producing Corp.		Lease Bowman Fed.		Acres 2
Section K	Section 12	Township 9 South	Range 34 East	County Lea

Approximate Location of Well:				
1980	feet from the South	line and	1830	feet from the West
Surface Elev. 4214.1	Producing Formation Penn	Pool Vada Penn (Bough "C")	Dedicated Acreage 160	

- Outline the acreage dedicated to the subject well by colored pencil or hatchure marks on the plat below.
- If more than one lease is dedicated to the well, outline each and identify the ownership thereof (both as to working interest and royalty). **N/A**
XXXX Working interest same. Royalty interest different
- If more than one lease of different ownership is dedicated to the well, have the interests of all owners been consolidated by communitization, unitization, force-pooling, etc? **N/A**
☐ Yes ☒ No If answer is "yes," type of consolidation **N/A**

If answer is "no," list the owners and tract descriptions which have actually been consolidated. (Use reverse side of this form if necessary.) **XXXX Royalty interests in process of communitization**

No allowable will be assigned to the well until all interests have been consolidated (by communitization, unitization, forced-pooling, or otherwise) or until a non-standard unit, eliminating such interests, has been approved by the Commission.

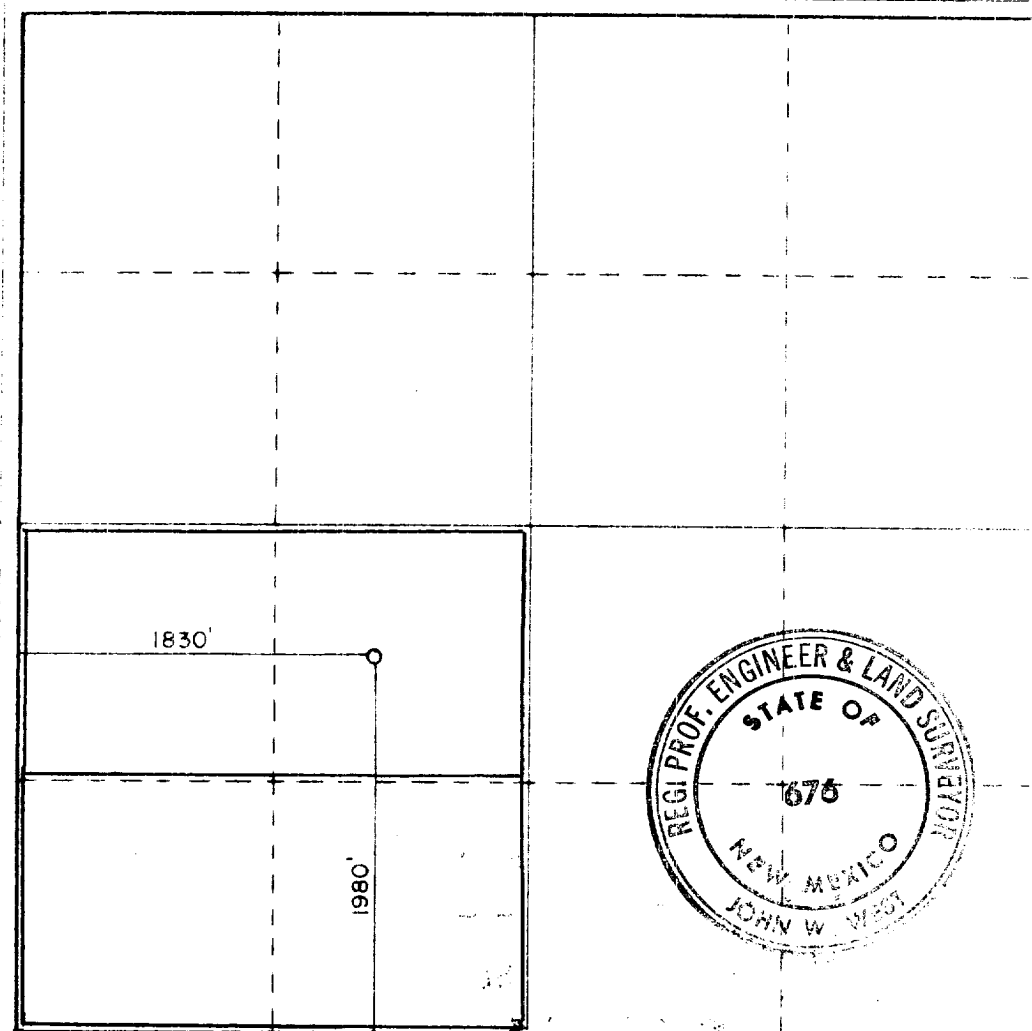

CERTIFICATION

I hereby certify that the information contained herein is true and complete to the best of my knowledge and belief.

Bruce C. Monroe
Name

Production Superintendent

Company
Estoril Producing Corp.

Date
August 30, 1979

I hereby certify that the well location shown on this plat was plotted from field notes of actual surveys made by me or under my supervision, and that the same is true and correct to the best of my knowledge and belief.

Date Surveyed
August 14, 1979

Registered Professional Engineer
and Land Surveyor

John W. West
Signature

Certificate No. **John W. West** **676**

Ronald J. Edison **3239**

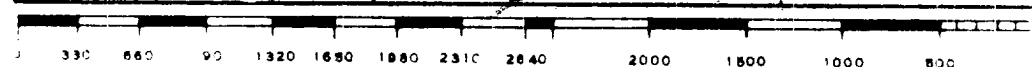

RECEIVED

SEP 7 1961

O.C.D. HOBBS, OFFICE

RE

SEP

O.C.D. HOBBS, O.

RECEIVED

SEP 6 1961

O.C.D. HOBBS, OFFICE

*Comment Evaluation
for*