

N. OF COPIES RECEIVED	
DISTRIBUTION	
SANTA FE	
FILE	
U.S.G.S.	
LAND OFFICE	
OPERATOR	

# NEW MEXICO OIL CONSERVATION COMMISSION

Form C-103  
Supersedes Old  
C-102 and C-103  
Effective 1-1-65

5a. Indicate Type of Lease	
State <input type="checkbox"/>	Fee <input checked="" type="checkbox"/>
5. State Oil & Gas Lease No.	

## SUNDRY NOTICES AND REPORTS ON WELLS

(DO NOT USE THIS FORM FOR PROPOSALS TO DRILL OR TO DEEPLN OR PLUG BACK TO A DIFFERENT RESERVOIR.  
USE "APPLICATION FOR PERMIT -" (FORM C-101) FOR SUCH PROPOSALS.)

1. <input checked="" type="checkbox"/> OIL WELL <input type="checkbox"/> GAS WELL <input type="checkbox"/> OTHER-	7. Unit Agreement Name
2. Name of Operator Coastal Oil & Gas Corp.	8. Farm or Lease Name Adlong "5"
3. Address of Operator P. O. Box 235, Midland, Texas 79702	9. Well No. 2
4. Location of Well UNIT LETTER <u>A</u> <u>660</u> FEET FROM THE <u>North</u> LINE AND <u>660</u> FEET FROM THE <u>East</u> LINE, SECTION <u>5</u> TOWNSHIP <u>10-S</u> RANGE <u>37-E</u> NWPM.	10. Field and Pool, or Wildcat W. Sawyer San Andres
15. Elevation (Show whether DF, RT, GR, etc.) 3977.9 GR	12. County Lea

16. Check Appropriate Box To Indicate Nature of Notice, Report or Other Data

### NOTICE OF INTENTION TO:

PERFORM REMEDIAL WORK <input type="checkbox"/>	PLUG AND ABANDON <input type="checkbox"/>
TEMPORARILY ABANDON <input type="checkbox"/>	CHANGE PLANS <input type="checkbox"/>
PULL OR ALTER CASING <input type="checkbox"/>	OTHER <u>Extension of time C-103 11-3-80</u> <input checked="" type="checkbox"/>

### SUBSEQUENT REPORT OF:

REMEDIAL WORK <input type="checkbox"/>	ALTERING CASING <input type="checkbox"/>
COMMENCE DRILLING OPNS. <input type="checkbox"/>	PLUG AND ABANDONMENT <input type="checkbox"/>
CASING TEST AND CEMENT JOB <input type="checkbox"/>	OTHER <input type="checkbox"/>

17. Describe Proposed or Completed Operations (Clearly state all pertinent details, and give pertinent dates, including estimated date of starting any proposed work) SEE RULE 1103.

\* CL "C", 2% CaCl<sub>2</sub> (100% excess)

\*\*First Stage: 50/50 Poz CL "C", 2% CaCl<sub>2</sub>, 1/4 lb/sx Flocele, (25% excess) 430 sx.  
Second Stage: DV Tool @ + 2500', CL "C" 4% Gel, 2% CaCl<sub>2</sub>, 5 lb/sx gilsonite,  
1/4 lb/sx Flocele. (150% excess) 690 sx.

18. I hereby certify that the information above is true and complete to the best of my knowledge and belief.

SIGNED Sue Vanderford Sue Vanderford TITLE Operations Analyst DATE 1-15-81

APPROVED BY [Signature] TITLE  DATE

CONDITIONS OF APPROVAL, IF ANY:

JAN 15 1981

**N MEXICO OIL CONSERVATION COMMISS**  
**WELL LOCATION AND ACREAGE DEDICATION PLAT**

Form C-19,  
 Supersedes C-128  
 Effective 10-85

All distances must be from the outer boundaries of the Section.

Operator <b>Coastal Oil &amp; Gas Corp.</b>			Lease <b>Adlong 5</b>		Well No. <b>2</b>
Unit Letter <b>A</b>	Section <b>5</b>	Township <b>10 South</b>	Range <b>37 East</b>	County <b>Lea</b>	
Actual Footage Location of Well: <b>660</b> feet from the <b>North</b> line and <b>660</b> feet from the <b>East</b> line					
Ground Level Elev. <b>3977.9</b>	Producing Formation <b>San Andres</b>	Pool <b>West Sawyer - San Andres</b>		Dedicated Acreage: <b>80 80.59</b> Acres	

1. Outline the acreage dedicated to the subject well by colored pencil or hatchure marks on the plat below.
2. If more than one lease is dedicated to the well, outline each and identify the ownership thereof (both as to working interest and royalty).
3. If more than one lease of different ownership is dedicated to the well, have the interests of all owners been consolidated by communitization, unitization, force-pooling, etc?

☐ Yes ☐ No If answer is "yes," type of consolidation \_\_\_\_\_

If answer is "no," list the owners and tract descriptions which have actually been consolidated. (Use reverse side of this form if necessary.) \_\_\_\_\_

No allowable will be assigned to the well until all interests have been consolidated (by communitization, unitization, forced-pooling, or otherwise) or until a non-standard unit, eliminating such interests, has been approved by the Commission.

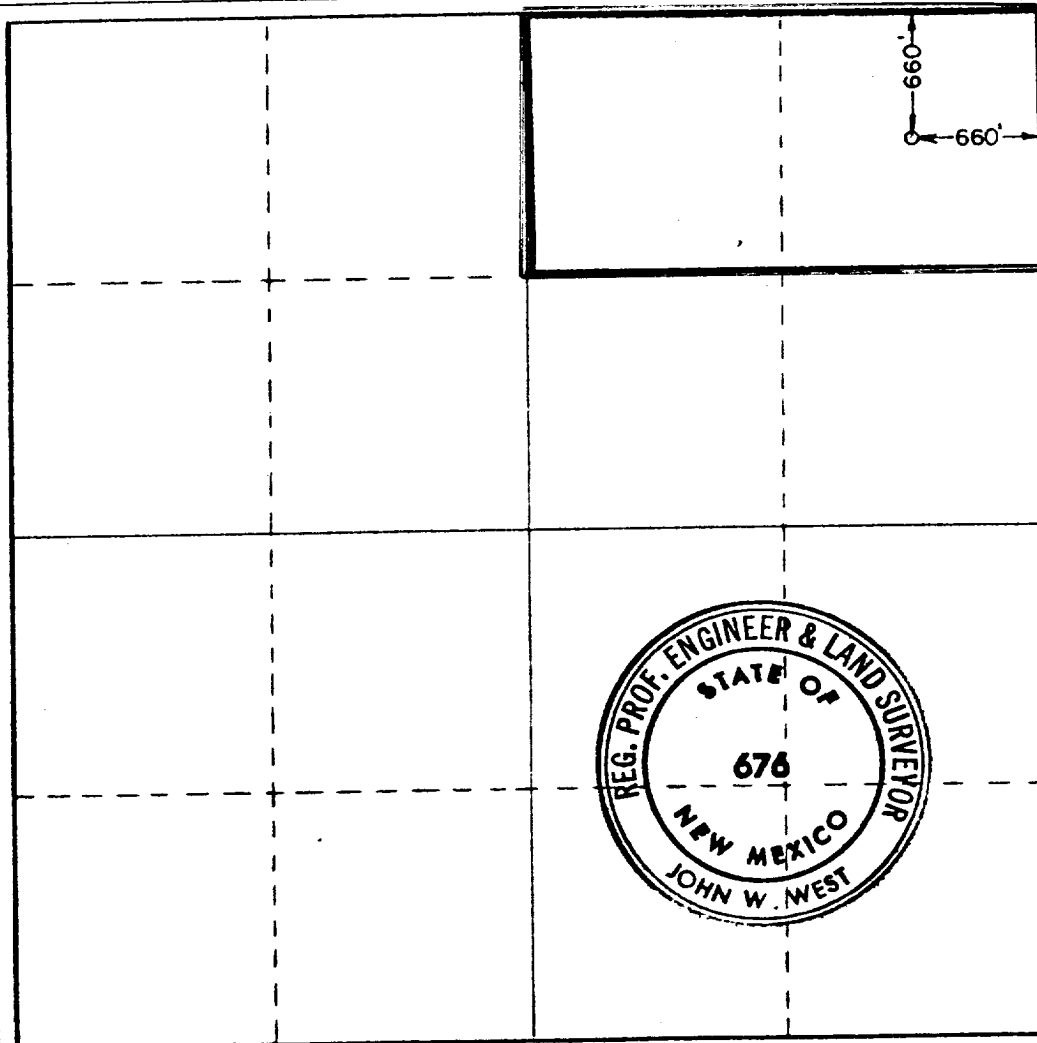

**CERTIFICATION**

I hereby certify that the information contained herein is true and complete to the best of my knowledge and belief.

*Lee W. Thyng*  
 Name

**Lee W. Thyng**  
 Position

**Sr. Drilling Engineer**  
 Company

**Coastal Oil & Gas Corp.**  
 Date

**June 18, 1980**

I hereby certify that the well location shown on this plat was plotted from field notes of actual surveys made by me or under my supervision, and that the same is true and correct to the best of my knowledge and belief.

Date Surveyed  
**June 11, 1980**

Registered Professional Engineer  
 and/or Land Surveyor

*John W. West*  
 Certificate No. **JOHN W. WEST 676**  
**PATRICK A. ROMERO 6888**  
**Ronald J. Eidson 3239**