

NEW MEXICO OIL CONSERVATION COMMISSION 30-025-27148
WELL LOCATION AND ACREAGE DEDICATION PLAT

Form C-102
Supersedes 1
Title 14

AMENDED

All distances must be from the outer boundaries of the Section.

Operator Brazos Petroleum Co.			Lease Yates 18 Fed.		Well No. 1
Unit Letter I	Section 18	Township 9 South	Range 38 East	County Lea	
Actual Footage Location of Well: 1650 feet from the south line and 990 feet from the east line					
Ground Level Elev. 3962.9	Producing Formation San Andres		Pool Sawyer	Dedicated Acreage: 100 - 40 Acres	

1. Outline the acreage dedicated to the subject well by colored pencil or hachure marks on the plat below.
2. If more than one lease is dedicated to the well, outline each and identify the ownership thereof (both as to working interest and royalty).
3. If more than one lease of different ownership is dedicated to the well, have the interests of all owners been consolidated by communitization, unitization, force-pooling, etc?

☐ Yes ☐ No If answer is "yes," type of consolidation _____

If answer is "no," list the owners and tract descriptions which have actually been consolidated. (Use reverse side of this form if necessary.) _____

No allowable will be assigned to the well until all interests have been consolidated (by communitization, unitization, forced-pooling, or otherwise) or until a non-standard unit, eliminating such interests, has been approved by the Commission.

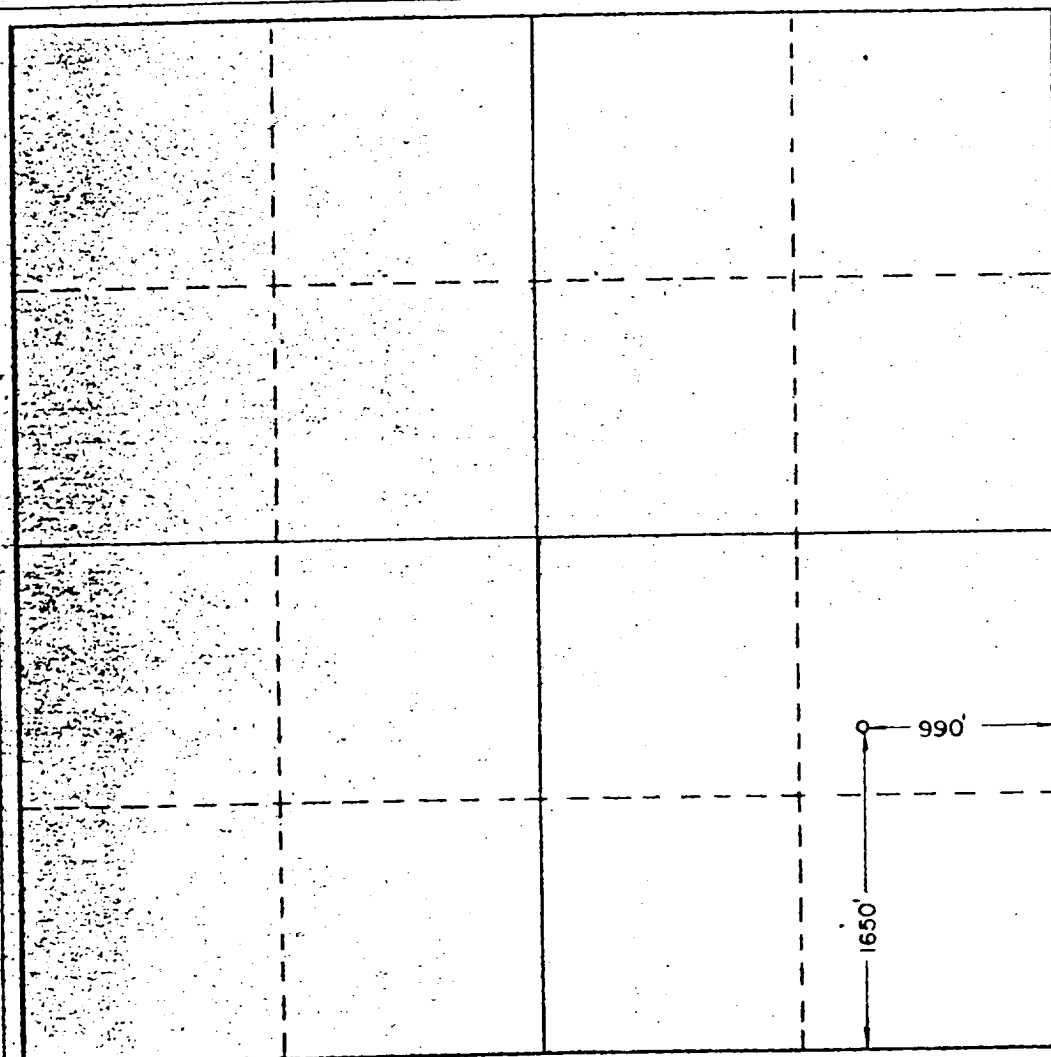

CERTIFICATION

I hereby certify that the information contained herein is true and complete to the best of my knowledge and belief.

Joe T. Janica
Name
Agent

Position
Brazos Petroleum Co.

Company
11/4/80

Date

I hereby certify that the location shown on this plat was plotted in the field notes of actual surveys made by me or under my supervision, and that the same is true and correct to the best of my knowledge and belief.

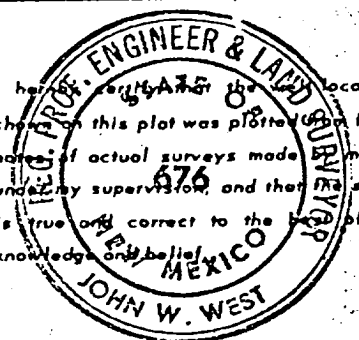

Date Surveyed

Oct. 25, 1980

Registered Professional Engineer and/or Land Surveyor

John W. West
Certificate No. **JOHN W. WEST 676**
PATRICK A. ROMERO 6863
Ronald J. Eidson 3239