

20-025-27240

NO. OF COPIES RECEIVED		
DISTRIBUTION		
SANTA FE		
FILE		
U.S.G.S.		
LAND OFFICE		
OPERATOR		

NEW MEXICO OIL CONSERVATION COMMISSION

Form C-101
Revised 1-1-65

5A. Indicate Type of Lease	
STATE <input type="checkbox"/>	FEE <input checked="" type="checkbox"/>
5. State Oil & Gas Lease No.	

APPLICATION FOR PERMIT TO DRILL, DEEPEN, OR PLUG BACK

1a. Type of Work		7. Unit Agreement Name	
b. Type of Well DRILL <input checked="" type="checkbox"/> DEEPEN <input type="checkbox"/> PLUG BACK <input type="checkbox"/> OIL WELL <input checked="" type="checkbox"/> GAS WELL <input type="checkbox"/> OTHER <input type="checkbox"/> SINGLE ZONE <input checked="" type="checkbox"/> MULTIPLE ZONE <input type="checkbox"/>		8. Farm or Lease Name Mattie Price	
2. Name of Operator William K. Young		9. Well No. 1	
3. Address of Operator 750 West Fifth St., Ft. Worth, Texas 76102		10. Field and Pool, or Wildcat Wildcat	
4. Location of Well UNIT LETTER <u>NH</u> LOCATED <u>1980</u> FEET FROM THE <u>North</u> LINE AND <u>660</u> FEET FROM THE <u>East</u> LINE OF SEC. <u>34</u> TWP. <u>10-S</u> RGE. <u>35-E</u> NMPM		12. County Lea	
19. Proposed Depth 13600		19A. Formation Devonian	20. Rotary or C.T. Rotary
21. Elevations (Show whether DF, RT, etc.) 4039 Ground	21A. Kind & Status Plug. Bond Statewide	21B. Drilling Contractor Moranco	22. Approx. Date Work will start 2-1-81

23.

PROPOSED CASING AND CEMENT PROGRAM

SIZE OF HOLE	SIZE OF CASING	WEIGHT PER FOOT	SETTING DEPTH	SACKS OF CEMENT	EST. TOP
17½	13 3/8	68#	450	475	Circulate
11	8 5/8	24# & 32#	4300	1680	Circulate
7 7/8	5 1/2	17# & 20#	13600	750	9600'

Propose to drill well to test Devonian formation.

Cement is to be circulated on 13 3/8" casing and 9 5/8" casing. Plan to test all significant shows.

Completion or abandonment will be performed in accordance with prudent practices and regulatory body requirements. A double ram series 900 BOP and choke manifold will be used from surface casing point to 8 5/8" casing point. A double ram series 1500 BOP and choke manifold will be used from 8 5/8" casing point to total depth.

APPROVAL VALID FOR 180 DAYS
PERMIT EXPIRES 2/23/81
UNLESS DRILLING IS COMPLETED

IN ABOVE SPACE DESCRIBE PROPOSED PROGRAM; IF PROPOSAL IS TO DEEPEN OR PLUG BACK, GIVE DATA ON PRESENT PRODUCTIVE ZONE AND PROPOSED NEW PRODUCTIVE ZONE. GIVE BLOWOUT PREVENTER PROGRAM, IF ANY.

I hereby certify that the information above is true and complete to the best of my knowledge and belief.

Signed W. C. Montgomery Title Dist. Engineer Date 1-21-81

(This space for State Use)

APPROVED BY [Signature] TITLE [Signature] DATE [Signature]

CONDITIONS OF APPROVAL, IF ANY:

**NEW MEXICO OIL CONSERVATION COMMISSION
WELL LOCATION AND ACREAGE DEDICATION PLAT**

Form C-102
Supersedes C-128
Effective 1-1-65

All distances must be from the outer boundaries of the Section.

Owner William K. Young			Lease Mattie Price		Well No. 1
Section Letter H	Section 34	Township 10 South	Range 35 East	County Lea County, New Mexico	
Actual Well Location of Well: 1980 feet from the North line and 660 feet from the East line					
Ground Level Elev. 4039.15	Producing Formation Devonian		Pool Wildcat		Dedicated Acreage: 40 Acres

1. Outline the acreage dedicated to the subject well by colored pencil or hatchure marks on the plat below.
2. If more than one lease is dedicated to the well, outline each and identify the ownership thereof (both as to working interest and royalty).
3. If more than one lease of different ownership is dedicated to the well, have the interests of all owners been consolidated by communitization, unitization, force-pooling, etc?

☐ Yes ☒ No If answer is "yes," type of consolidation _____

If answer is "no," list the owners and tract descriptions which have actually been consolidated. (Use reverse side of this form if necessary.) See Below - See Reverse Side

No allowable will be assigned to the well until all interests have been consolidated (by communitization, unitization, forced-pooling, or otherwise) or until a non-standard unit, eliminating such interests, has been approved by the Commission.

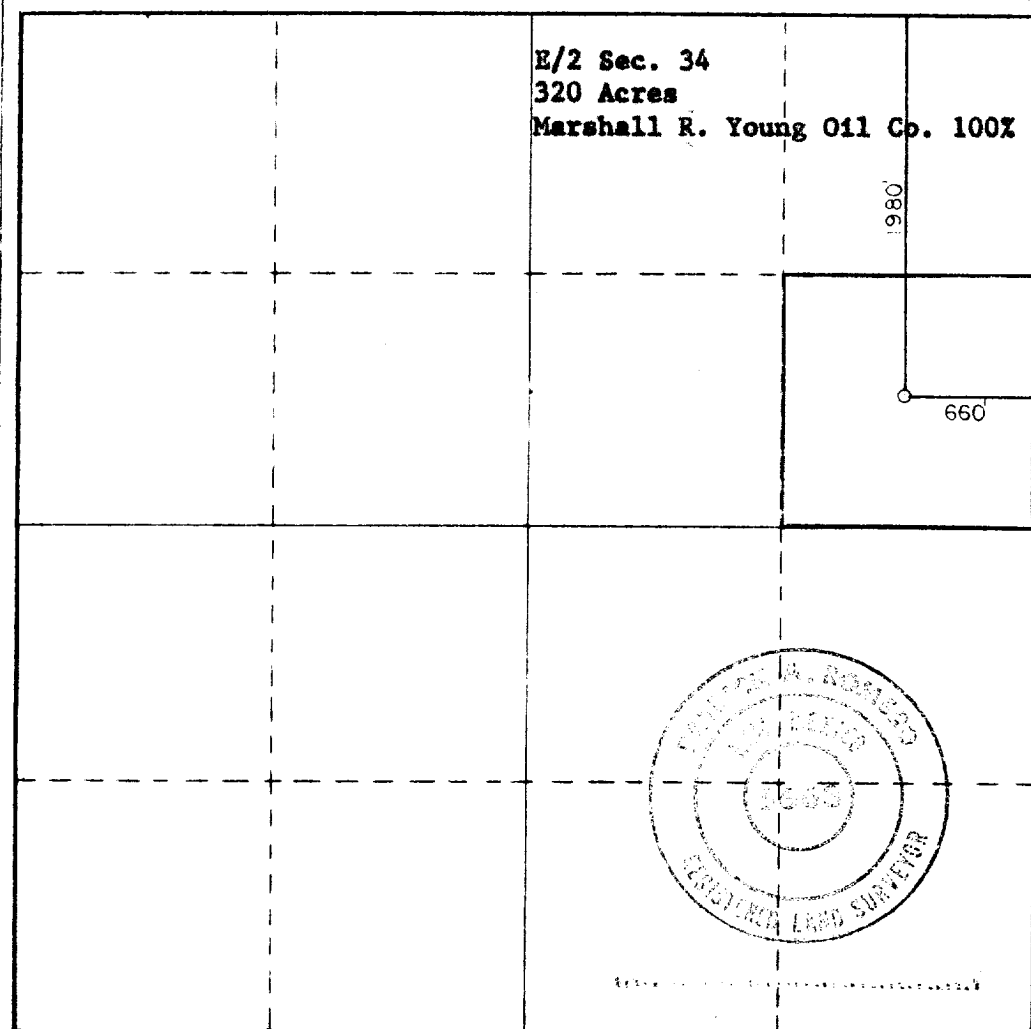

CERTIFICATION

I hereby certify that the information contained herein is true and complete to the best of my knowledge and belief.

W. E. Montgomery

Name

W. E. Montgomery

Position

Dist. Engineer

Company

William K. Young

Date

1-21-81

I hereby certify that the well location shown on this plat was plotted from field notes of actual surveys made by me or under my supervision, and that the same is true and correct to the best of my knowledge and belief.

Date Surveyed

1-9-81

Registered Professional Engineer and/or Land Surveyor

Patrick A. Romero

Certificate No. **JOHN W. WEST 676**
PATRICK A. ROMERO 6883
Ronald J. Eidson 3239



Section 34, T-10-S, R-35-E

LESSOR	INT.	DESCRIPTION	PRESENT LEASEHOLD OWNER
Mattie Price	1/2 M.I.	N/2 NE/4	Marshall R. Young Oil Co.
Hewit & Dougherty	1/2 M.I.	N/2 NE/4	" " " " "
Mattie Price	1/4 M.I.	S/2 NE/4	Marshall R. Young Oil Co.
Hewit & Dougherty	1/2 M.I.	S/2 NE/4	" " " " "
Lela Belle Gainer	1/4 M.I.	S/2 NE/4	" " " " "
Mattie Price	1/4 M.I.	SE/4	Marshall R. Young Oil Co.
Gainer, Gainer and			
Woolley, Partnership	1/4 M.I.	SE/4	" " " " "
Hewit & Dougherty	1/2 M.I.	SE/4	" " " " "

173